

## WORLDWIDE SERVICE TERM

### BRAZIL AGENT

TEL / FAX: +55-2284471475  
E-mail: rldanbrasil@gmail.com

### EGYPT AGENT

TEL / FAX: +002-02-26321709  
E-mail: egyptian\_international2003@yahoo.co.uk

### HUNGARY AGENT

TEL: +36-62534945 / FAX: +36-62534946  
E-mail: pmt@vnet.hu

### INDIA AGENT-NORTH

TEL :+91-11-41324642/ FAX: +91-11-26218273  
E-mail:starmax7@gmail.com

### INDIA AGENT-SOUTH

TEL :+91-80-26547337/ FAX: +91-80-26644150  
E-mail: ravalkran@maga1-india.com

### INDONESIA AGENT

TEL: +62-214619808 / FAX: +62-2146832726  
E-mail: galaksimulti@centrin.net.id

### IRAN AGENT

TEL: +98-4114462448 / FAX: +98-4114461805  
E-mail: bender@controlafzar.com

### JAPAN(OSAKA) AGENT

TEL: +81-6-6472-1454 / FAX: +81-6-6474-1355  
E-mail: tokki@araya-kk.co.jp

### KOREA AGENT

TEL: +82-226723387 / FAX: +82-226723384  
E-mail: nasee33@paran.com

### MEXICO AGENT

TEL / FAX: +52- 4448253354  
E-mail: crosillo@prodlgyn.net.mex

### NEW ZEALAND AGENT

TEL: +64-95701134 / FAX: +64-95704462  
E-mail: francis@chevpac.co.nz

### POLAND AGENT

TEL: +48-33-8547091 / FAX: +48-334876061  
E-mail: office@ifm.pl

### RUSSIA AGENT

TEL / FAX: +7(495)9955553  
E-mail: referent@perytone.ru

### SAUDI ARABIA AGENT

TEL:+966-1-2822369 / FAX: +966-1-2820267  
E-mail: omalralomair@aol.com

### THAILAND AGENT

TEL:+662-8973570 / FAX: +622-8973359  
E-mail: excel@excelmct.com

### TURKEY AGENT

TEL: +90-2126794610 / FAX: +90-2126794685  
E-mail: bilgi@taimaksan.com

### VIETNAM AGENT-NORTH

TEL: +84-47340588 / FAX: +84-47340589  
E-mail: lanng@suntvyjsc.com.vn

### VIETNAM AGENT-SOUTH

TEL:+84-88553362 / FAX: +84-89552905  
E-mail: goldwell@hcm.vnn.vn

# Bender



**TAIWAN - HEADQUARTER**  
旭東機械工業股份有限公司  
**SHUZ TUNG MACHINERY INDUSTRIAL CO., LTD.**  
台中縣外埔鄉大同村后寮路17-1號  
No. 17-1, Hou Liao Rd., Wajpu, Taichung, Taiwan.  
TEL:+886-4-2683-1886 / FAX:+886-4-2683-6158  
E-mail:stmc@shuztung.com.tw  
http://www.shuztung.com

**CHINA - KUNSHAN BRANCH**  
旭東機械(崑山)有限公司  
**SHUZ TUNG MACHINERY (KUNSHAN) CO., LTD.**  
江蘇省昆山市東部工業區金錫西路6號  
No. 6, Jin Yang Hsi Rd., East Industrial Area, Kunshan City, Jiangsu, China.  
TEL:+86-512-5767-2699 / FAX:+86-512-5767-2966  
E-mail:shuztung@shuztung.com.cn



自1978年成立以來，旭東公司致力於製造各式機械生產及自動化設備，歷經二十餘載，秉持實事求是的企業精神，累積了高度專業技術以及優越生產品質，搏得客戶一致的認同。

卓越的技术工程能力，加上優秀的工作團隊，紮實打造旭東的強勁競爭優勢。專精於管類加工、彎管機生產、自行車整廠生產設備、管類家具等，生產達1000多種機型，銷售網遍佈全球。

周全而完善的整體服務，是旭東贏得客戶百分之百的滿意度的另一驕傲。舉凡基本設備製造、完整技術轉移、技術顧問諮詢、整廠流程規畫等，提供客戶高效能高整合的整體生產版圖。

掌握市場脈動，與時俱進；切合客戶需求，全力以赴。旭東胸懷追求最佳品質的堅定信念，願與您一同邁向新世紀的蓬勃願景！

Established in 1978, Shuz Tung has been dedicated to manufacturing of various machinery and automation equipment. More than 20 years, Shuz Tung has accumulated advanced and professional techniques for superior production quality on practical and solid ground. The efforts and achievement are highly recognized by all the customers.

Outstanding capabilities of techniques and engineering, excellent working team, all of these firmly shape great competitiveness for Shuz Tung. Shuz Tung specialize in tube processing, manufacturing of tube bending machines, turn-key equipment for bicycles, tubes for furniture, etc. The product range consists of more than 1,000 models which are sold around the world.

Comprehensive and complete service is Shuz Tung's strength to guarantee 100% customers satisfaction. From fundamental production equipment, technical transferring, technical consultation to turn-key planning, customers are provided with highly effective, highly integrated supports for an overall view at production.

Advancing with the latest market trend to stay competitive and striving with all efforts to meet customers' needs - Shuz Tung is confidently pursuing the best quality to aim at the prosperous future in the new century!



### 觸控式螢幕

- 17" 彩色觸控式螢幕，可選配多國語言。
- 採用PC BASE，親和性程式WIN PC 編輯及輸入。

### LCD TOUCH SCREEN

- 17" color touch screen with Multiple languages for options.
- PC based with WIN PC friendly use programming.

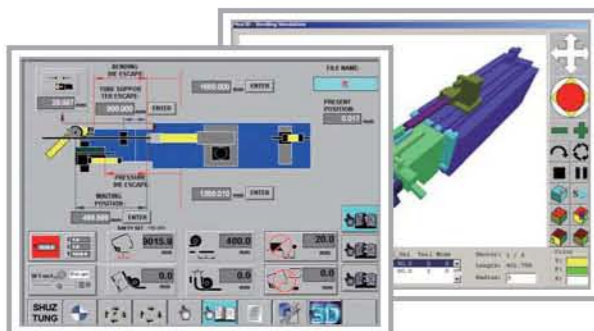

### 參數表&3D模擬：

- 參數可自由設定慢速退芯、輔推、穿心軸注油、自動回彎以及反彈補償值。
- 操作次數設定，資料可儲存於40GB硬碟。
- 3D快速檢測程式之正確性以減少試車成本。

### PARAMETER LIST&3D SIMULATION

- Able to set up mandrel pre-backward, booster, mandrel lubrication, auto bending reverse and spring back compensation.
- Product counting available, data can be store in 40GB HD.
- 3D simulation without actual operations thereby saving costs.

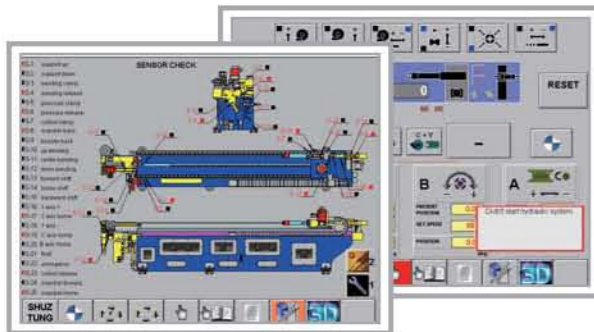

### 異常訊息：

- 以文字及閃爍異常區塊提供操可能異常狀況。

### Error Message

- Error description and flashing alarm on abnormal operational section offer instant trouble shooting.



### CMM 檢測輸入：

- 以檢測手臂量測管件，輸出報告含Y, B, C以及X, Y, Z，即可輸入彎管機成為彎管程式。

### TRANSFER FROM CMM REPORT

- Measure sample by CMM ARM, report contents "Y, B, C"&"X, Y, Z", insert the report data to bender.



## 彎管機類型 BENDER SERIES

**CNC BR1/2** 單層模/雙層模，可搭配彎管或捲圓。  
Single/Dual stacks for bending or rolling.

**CNC B1/2** 單層模/雙層模，可做彎管。  
Single/Dual stacks for bending

**CNC BR3/M** 多層模，除彎管/捲圓外，另可搭配沖孔或沖切。  
Multi stacks for bending and rolling.  
Option function for hole punching and punching cut.

**NCB** 數值控制  
Numeric Control Type.

**B** 傳統控制。  
Conventional Type.

## 彎管模具 BENDING DIES

機型 MODEL	彎曲模 BENDING DIE	彎曲夾模 CLAMPING DIE	彎曲導模 PRESSURE DIE	單/多珠芯桿 SINGLE/MULTI-BALL MANDREL	傾轉夾模 CLAMP CHUCK	背板 WIPER DIE
CNC BENDING 彎曲模	A1, A2, A3	B1, B2, B3	C2	D1, D2, D3	E1	F1
CNC ROLLING 捲圓模	A4	C3	B4	D1, D2, D3	E1	-
NCB BENDING 彎曲模	A2, A3	B1, B2, B3	C1, C2	D1, D2, D3	-	F1

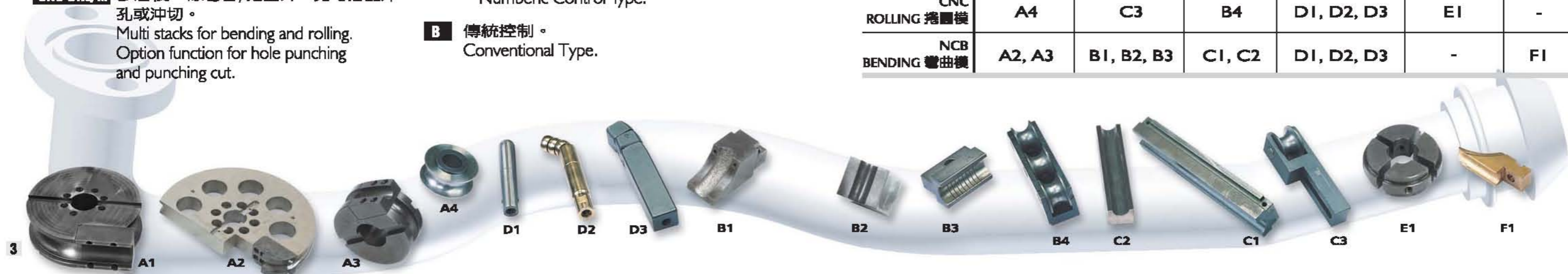

# CNC SERIES

CNC16

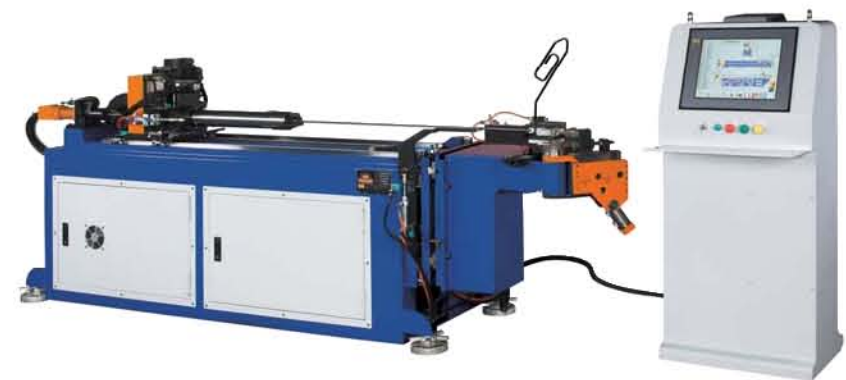

CNC25



CNC38



CNC50



CNC65



CNC80



## ACCESSORIES OPTION



- 捲圓機構**
- 適用彎曲半徑大於6D以上
  - 運用伺服送料機構推進管件達到捲圓及3D弧形需求

**PUSH BEND DEVICE**

- Suitable for the bending radius bigger than 6D
- Servo feeding device pushes pipe forming the bigger radius and 3D curvature shape.



- 沖孔機構**
- 第二機層可因應需求更換彎管或沖孔機構
  - 在彎曲加工同時執行沖孔功能，可避免二次加工的時間

**HOLE PUNCHING DEVICE**

- Able to exchange 2nd stack via bending device or hole punching device.
- To make hole punching & bending process at one operation, avoiding 2nd processing jobs on driller.



- 沖切機構**
- 底層可安置沖孔機構
  - 彎管及沖切可在同一機台上執行，可避免二次加工的時間及管料耗損。

**PUNCHING CUT DEVICE**

- The bottom stack set with punching cut device.
- Pipe bending & punching cut at one operation, avoiding 2nd processing jobs & material waste.

CNC32BR8



# NC SERIES

NCB25



NCB38



NCB50



NCB65



NCB80



NCB100

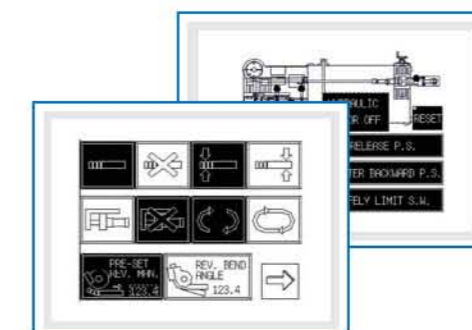
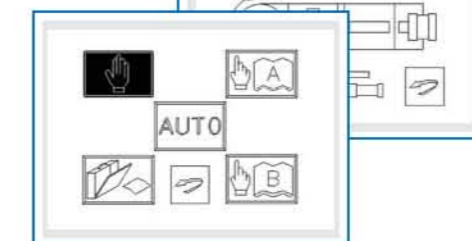

NCB130



NCB150/170

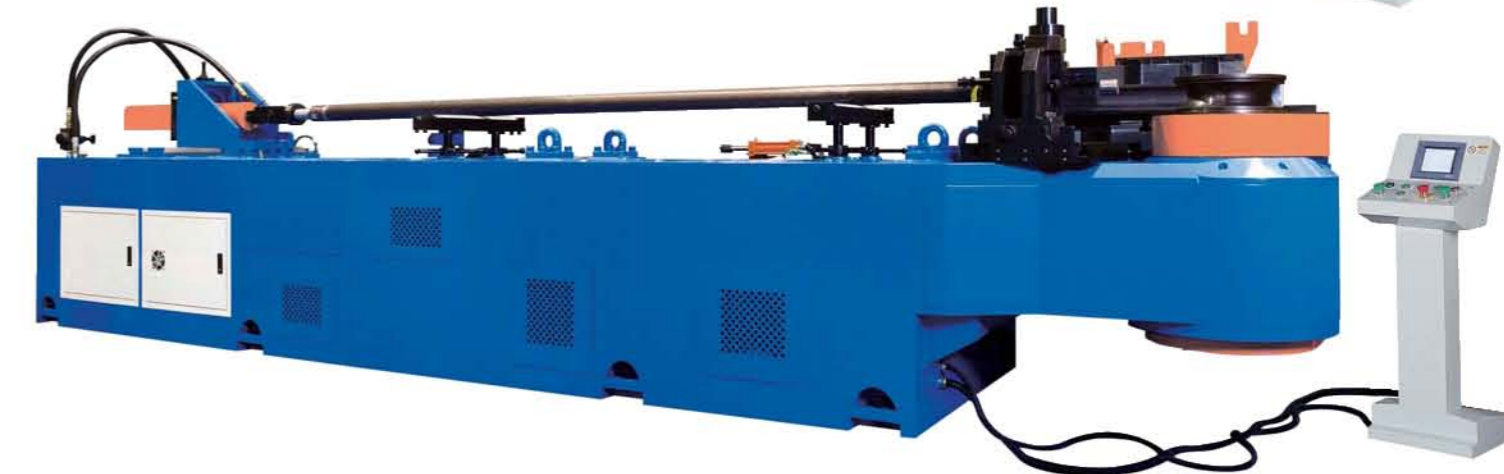

**觸控式螢幕**  
 採用觸碰式螢幕，可選配多國語言操作模式。PLC控制，資料可儲存於記憶體。

**LCD TOUCH SCREEN**  
 Touch screen with multiple languages for options. PLC control, data can be stored in memory.

**參數表**  
 可設定慢速退芯、輔推、回彎角度。

**PARAMETER LIST**  
 Able to set up mendrel pre-backward, booster, bending reverse angle.

機型/MODEL	CNC 控制系列 CNC CONTROL SERIES													NC 控制系列 NC CONTROL SERIES										
	PC Base 控制器 PC Base Control								可程式控制器 PLC Control															
	CNC 16 BR1 CNC 18 BR2 CNC 16 BR3	CNC 25 BR1 CNC 25 BR2 CNC 25 BR3	CNC 38 BR1 CNC 38 BR2 CNC 38 BR3	CNC 50 BR1 CNC 50 BR2 CNC 50 BR3	CNC 65 BR1 CNC 65 BR2 CNC 65 BR3	CNC 80 BR1 CNC 80 BR2 CNC 80 BR3	CNC 100 BR1 CNC 100 BR2	CNC32BR8	CNC 38 B1 CNC 38 B2	CNC 50 B1 CNC 50 B2	CNC 65 B1 CNC 65 B2	CNC 80 B1 CNC 80 B2	CNC 100 B1 CNC 100 B2	B 25 NCB 25	B 38 NCB 38	B 50 NCB 50	NCB 65	NCB 80	NCB 100	NCB 130	NCB 150	NCB 170		
動力 HORSE POWER	11HP	12.5HP	22HP	30HP	37HP	48HP	63HP	27HP	15HP	20HP	26HP	32HP	48HP	5	5	7.5	15	20	25	37.5	37.5	40		
適用最大外径 MAX. BENDING CAPACITY (mm)	16x1.2	25x1.5	38x2	50x2	65x2.2	80x3	100x3	32x1.8	38x2	50x2	65x3	80x4	100x6	25x1.2	38x2	50x2	65x2.2	80x4	100x6	130x7	150x8	170x7		
彎曲最大半徑 MAX. BENDING RADIUS (mm)	80	100	200	220	220	250	350	150	200	220	220	250	350	120	300	450	450	500	500	500	600	600		
彎曲最大角度 MAX. BENDING ANGLE (°)	190	190	190	190	190	190	190	190	190	190	190	190	190	190	190	190	190	190	190	190	190	190		
★1 最大穿心軸定位距離 MAX. ONE-TIME FEEDING LENGTH (mm)	1200	1800	2100	2500	2500	3000	3600	2500	2100	2500	2500	3000	3600	-	-	-	-	-	-	-	-	-		
★2 穿心軸長度 MAX. FEEDING LENGTH WITH MANDREL (mm)	2100	2600	3200	3500	3500	4200	5100	3800	3200	3500	3500	4200	5200	800	2000	2000	2300	2700	4000	4000	5000	5000		
彎曲精度 BENDING ACCURACY (°)	±0.05	±0.05	±0.05	±0.05	±0.05	±0.05	±0.05	±0.05	±0.1	±0.1	±0.1	±0.1	±0.1	±0.1	±0.1	±0.1	±0.1	±0.1	±0.1	±0.1	±0.1	±0.1		
彎曲速度 BENDING SPEED (°/sec)	214	200	150	120	80	70	35	240	90	85	80	50	18	100	45	45	20	17	12	10	8	5		
送料精度 FEEDING ACCURACY (mm)	±0.1	±0.1	±0.1	±0.1	±0.1	±0.1	±0.1	±0.1	±0.1	±0.1	±0.1	±0.1	±0.1	-	-	-	-	-	-	-	-	-		
送料速度 FEEDING SPEED (mm/sec)	1~1200	1~1100	1~1000	1~1000	1~800	1~800	1~600	1~1100	1~1000	1~1000	1~800	1~800	1~600	-	-	-	-	-	-	-	-	-		
轉角精度 TURNING ACCURACY (°)	±0.1	±0.1	±0.1	±0.1	±0.1	±0.1	±0.1	±0.1	±0.1	±0.1	±0.1	±0.1	±0.1	-	-	-	-	-	-	-	-	-		
程式組數 NUMBER OF PROGRAMS	NO LIMITED								NO LIMITED					99	99	99	99	99	99	99	99	99	99	
每組可彎組數 BENDING NO. PROGRAMS	NO LIMITED								NO LIMITED					2	2	2	20	20	20	20	20	20	20	20
轉角速度 TURNING SPEED (°/sec)	380	240	240	200	150	150	100	240	240	200	150	150	100	-	-	-	-	-	-	-	-	-		
多層橫半徑差 RADIUS DIFFERENCE BETWEEN STACKS (mm)	25	40	45	80	80	90	100	NO LIMITED	45	80	80	90	100	-	-	-	-	-	-	-	-	-		
機械外型 DIMENSIONS (cm)	280x85x120	340x90x120	400x107x130	520x115x140	540x140x160	580x140x160	800x200x180	450x160x190	410x107x130	520x115x140	520x115x140	580x140x160	750x180x190	220x61x130	330x90x130	350x105x130	355x120x142	410x155x142	570x170x145	645x225x170	755x245x170	830x285x200		
重量 WEIGHT (kg)	1500	1600	2500	3500	3800	4500	6000	5800	2000	3200	3000	3500	9000	600	1200	1500	2000	3800	8500	14000	16000	20000		

備註 KEY

- ★1 請參閱右圖所示  
Please Refer To The Drawing In The Right Side.
- ★2

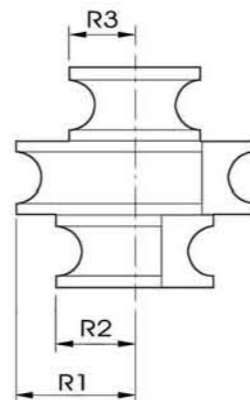

多層模可加選沖孔及沖切功能。

4th axis CNC is available as option during multi-stack operation to provide hole punching and punching cut.

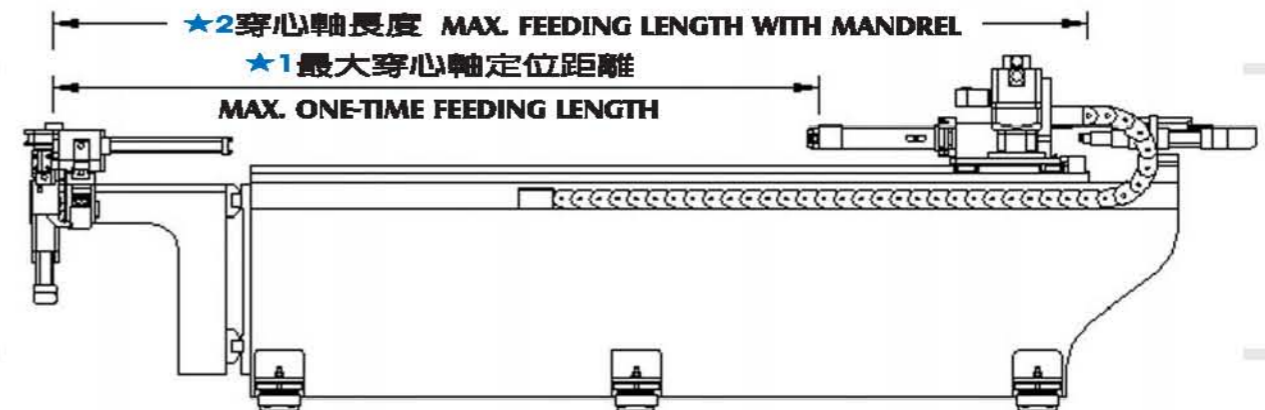

The manufacturer always performs product improvements to achieve the best possible performance. All specifications, dimensions and design characteristics shown in this catalogue are subject to change without notice. (Product specifications are based on the actual machines.)  
本公司隨時在進行研究改進的工作，因此保有隨時更改設計，規格尺寸及機械構造之權利，產品規格依實物為準，若有任何變更，恕不另行通知。

CNC38B2



NCB38H



CNC50B1



NCB80H

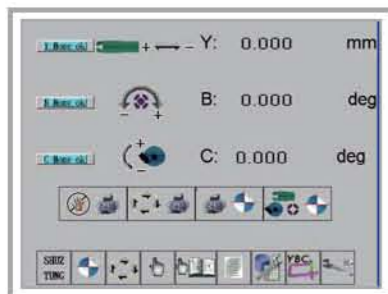

機械首頁/First Page

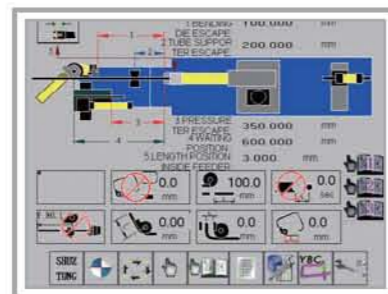

手動設定/Manual Set up



參數設定/Parameter Set up



角度傾轉/ANGLE ROTATING

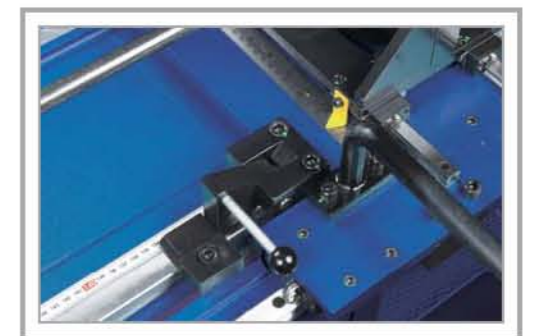

長度定位/LENGTH SETTING

### B25/38

傳統彎管機  
CONVENTIONAL BENDER



機型/MODEL	B25	B38
動力 HORSE POWER (HP)	5HP	5HP
適用最大外徑 MAX. BENDING CAPACITY (mm)	25x1.2	38x2.0
彎曲最大半徑 MAX. BENDING RADIUS (mm)	120	300
穿心軸長度 Length of mandrel	800	2000
彎曲最大角度 MAX. BENDING ANGLE (°)	180	180
彎曲精度 BENDING ACCURACY (°)	±0.1	±0.1

### DDB38

二次雙彎管機  
DOUBLE HEADS BENDER (Two Times Finish)



機型/MODEL	DDB38 1500	DDB38 2000	DDB38 2500
適用最長兩彎距離 MAX. DISTANCE BETWEEN 2 SHAFTS (mm)	1500	2000	2500
適用最大外徑 MAX. BENDING CAPACITY (mm)	38		
適用彎曲半徑 AVAILABLE BENDING RADIUS (mm)	30~150		
彎曲最大角度 MAX. BENDING ANGLE (°)	190		
動力 HORSE POWER (HP)	7 1/2 - 4P		



### SB-05

小彎管機  
SMALL ANGLE TUBE BENDER

- 送料整直、彎曲、切斷等動作，全自動作業。高速、高產能，可同時彎曲多支管材。

All motions, from material feeding, straightening, bending to cutting, are fully automatically operated, featuring, high speed operation and high productivity.



**應用例  
TYPICAL APPLICATION**  
本機適合冷氣管，熱水器管件之彎管作業。  
The machine is especially ideal for bending small radius tubes, such as for air conditioners and water heater tubes.

彎曲機構 BENDING DEVICE 裁斷機構 CUTTING DEVICE

### VRB-38

立式捲圓機  
VERTICAL ROLLING BENDER



機型/MODEL	VRB 38
適用最大外徑 MAX. BENDING CAPACITY (mm)	38
彎曲最大半徑 MAX. BENDING RADIUS (mm)	>=60
彎曲精度 BENDING ACCURACY (°)	±1°
彎曲速度 BENDING SPEED (mm/sec)	148
動力 HORSE POWER (HP)	5
機械外型 DIMENSIONS (mm)	160x100x170
重量 WEIGHT (kg)	1200

### HRB-38 / 50

臥式捲圓機  
HORIZONTAL ROLLING BENDER



機型/MODEL	HRB 38	HRB 50
適用最大外徑 MAX. BENDING CAPACITY (mm)	38	50
彎曲最大半徑 MAX. BENDING RADIUS (mm)	>=60	>=60
彎曲精度 BENDING ACCURACY (°)	±1°	±1°
彎曲速度 BENDING SPEED (mm/sec)	376	362
動力 HORSE POWER (HP)	5	7
機械外型 DIMENSIONS (cm)	150x80x110	160x95x110
重量 WEIGHT (kg)	1100	1500



機型/MODEL	SB 05
適用最大外徑 MAX. BENDING CAPACITY (mm)	15.8x0.7
彎曲最大半徑 MAX. BENDING RADIUS (mm)	10~19
彎曲最大角度 MAX. BENDING ANGLE (°)	182°
彎曲精度 BENDING ACCURACY (°)	±0.5°
穿心軸長度 Length of mandrel	175 mm
彎曲速度 BENDING SPEED (°/sec)	150°
動力 HORSE POWER (HP)	9
機械外型 DIMENSIONS (cm)	773x122x170
重量 WEIGHT (kg)	3040



### HT-10-229

管端成型機-單站式  
PIPE END SHRINKING  
M/C - SINGLE STATION



機型/MODEL	HT-10-229(38)	HT-10-229(50)
適用最大外徑 MAX. CAPACITY (mm)	38 x 1.5	50 x 2.0
適用管件長度 LENGTH OF TUBE (mm)	1,200~2,160	1,200~2,160
成型行程 FORMING STROKE (mm)	150	150
機械時間 M/C CYCLE TIME (sec/pc)	8	8
動力 HORSE POWER (HP)	5	7.5
機械外型 DIMENSIONS (cm)	250x100x160	250x100x160
重量 WEIGHT (kg)	1150	1200

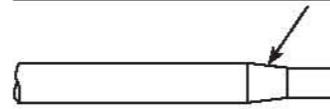

### HT-10-22D/G

管端成型機-多站式  
PIPE END SHRINKING  
M/C - MULTIPLE STATIONS



機型/MODEL	HT-10-22D(19)	HT-10-22D(25)	HT-10-22G(50)
適用最大外徑 MAX. CAPACITY (mm)	19 x 1.4	25 x 1.4	50 x 3
機械時間 M/C CYCLE TIME SINGLE STATION (sec.)	1-2 SEC	2.5-3.5 SEC	5.5-8.5 SEC
動力 HORSE POWER (HP)	5	7.5	15
控制系統 CONTROL	TOUCH SCREEN PLC + SERVO MOVING		
換機時間 CHANGE TIME	6MIN	6MIN	6MIN
機械外型 DIMENSIONS (cm)	130x120x170	130x120x170	205x145x175
重量 WEIGHT (kg)	1,500	1,500	2,300



### HT-10-78

旋溝機  
PIPE END  
GROOVING MACHINE



機型/MODEL	HT-10-78
適用最大外徑 CAPACITY (mm)	38
動力 HORSE POWER (HP)	3
機械時間 M/C CYCLE TIME	8-10 SEC
機械外型 DIMENSIONS (cm)	1400x1100x1500



### HT-90-06

單頭鐵管內外角倒角機  
PIPE END CHAMFERING M/C



機型/MODEL	60 TYPE	80 TYPE	115 TYPE	115-U TYPE
適用外徑 CAPACITY (mm)	15-60	20-80	20-115	15-115
適用最大管厚 MAX. WALL THICKNESS (mm)	2	4.5	4.5	4.5
適用實心管 CAPACITY. SOLID BAR (mm)	8-25	8-50	8-60	8-60
動力 HORSE POWER (HP)	1	3	5	5
機械外型 DIMENSIONS (cm)	64x110x111	80x75x135	93x75x135	110x89x135
重量 WEIGHT (kg)	210	380	450	450

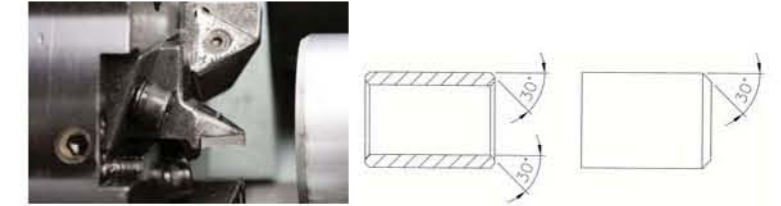

### HT-90-06F

雙頭倒角機  
DOUBLE ENDS PIPE CHAMFERING M/C



機型/MODEL	60 TYPE	80 TYPE
適用外徑 CAPACITY (mm)	12-80	25-85
適用最大管厚 MAX. WALL THICKNESS (mm)	4	4.5
適用管件長度 SUITABLE FOR PIPE LENGTH (mm)	25-300	25-300
動力 HORSE POWER (HP)	4	6
機械外型 DIMENSIONS (cm)	216x202x160	216x202x160
重量 WEIGHT (kg)	1,470	1,470

### HT-90-206

管端沖圓弧機  
PIPE END NOTCHING M/C



機型/MODEL	HT-90-206	HT-90-208
適用最大外徑 MAX. NOTCHING CAPACITY (mm)	50	80
適用最大厚度 MAX. TUBE THICKNESS (mm)	1.5~2.5	3.5
適用管件長度 LENGTH OF TUBE (mm)	180~1,000	180~1,200
可調整角度 ADJUSTABLE ANGLE (°)	0~180	65~180
機械時間 M/C CYCLE TIME (sec/pc)	6	8
動力 HORSE POWER (HP)	7.5	15
機械外型 DIMENSIONS (cm)	155x132x170	265x182x200
重量 WEIGHT (kg)	1200	2800

HT-20-01

斜度成型機  
SWAGING M/C

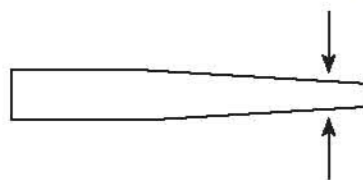

機型/MODEL	2 PCS MOLD TYPE		4 PCS MOLD TYPE		MAX. PIPE LENGTH (mm)	MAX. SWAGING LENGTH (mm)	HP (kw)	OUTLOOK (cm)	WEIGHT (kg)	
	SUITABLE O.D. (mm)	CYCLE TIME	SUITABLE O.D. (mm)	CYCLE TIME						
AUTO / SEMI-AUTO	330A/S	15.88-32x1.2T	8 sec / pc	X	X	780	300	10.13	327 x 95 x 158	2424
	400A/S	15.88-32x1.2T	16 sec / pc	25-50x1.2T	12 sec / pc	780	360	10.13	415 x 121 x 159	3840
	600A/S	15.88-32x1.2T	24 sec / pc	25-50x1.2T	20 sec / pc	800	560	10.13	470 x 120 x 158	4200
	800A/S	15.88-32x1.2T	34 sec / pc	25-50x1.2T	30 sec / pc	1000	780	10.13	518 x 108 x 160	4458
	400LA/S	15.88-32x1.2T	18 sec / pc	40-72x1.6T	14 sec / pc	780	360	13.88	415 x 143 x 163	4200
	600LA/S	25-50x1.2T	20 sec / pc	40-72x1.6T	16 sec / pc	800	560	17.6	470 x 143 x 163	4800
MANUAL(*)	330M	32x1.2T	8 sec / pc	X	X	X	300	7.7	132 x 83 x 143	1730
	400M	32x1.2T	10 sec / pc	50x1.2T	13 sec / pc	X	380	7.7	135 x 90 x 145	2200

備註REMARK: 小徑以不能成為實心為主要限制

SWAGING JOB NOT ABLE TO EXECUTE UP TO CLOSE END (AS SOLID END)

## AUTO CELL

Handing Intelligent Robot



Welding Intelligent Robot

