

## 1. Brochures&Catalogues:



### LYJW-- Famous Brand Pursuit



#### Different countries share the same brand-LYJW.

When we entered the bearing industry, Jiawei bearing not only belongs to Luoyang, but also belongs to people all over the world. We are committed to provide more people with excellent products , more wonderful and colourful life all the time.

Nowadays, there are more than 50 countries and regions experiencing Jiawei bearing brand.

Different regions, various countries, but the same of emotion to LYJW Brand.

New year, new start, we will move on beyond national boundaries.





# ENTERPRISE →

## Introduction

Luoyang Jiawei Bearing Manufacturing Co.,Ltd is a professional manufacturer of slewing bearings, extra large bearings, non-standard bearings and wind power bearings which has the advanced ability of researching and developing slewing bearings and special bearings.

The featured products are slewing bearings for port machinery, hoisting machinery and stacker-reclaimers, wind power bearings, rolling mill bearings and etc. We can offer such series of bearings with diameters from 200 mm to 6,500 mm and accuracy class of P0, P6 and P5. We have achieved ISO 9001:2000 Certification and began to export large turntable bearings in 2003, which are favoured by our customers.

The main instruments of our company are as follows : 5 meter, 4 meter, 2.5 meter and 1.6 meter huge CNC vertical lathes, 5meter huge teeth-miller, 3.5meter universal grinder, 5 meter CNC hardening machine, 3 meter plano drilling machine, testing bed with 6 meter length and 4 meter width, large bridge leveling ruler and etc. Our kinds of advanced test machines can match bearings test with different accuracy classes, types and special requests. All products are inspected according to the current national standards strictly to make multiple technology indicators of bearings reach or exceed the national standards.

Our company supplies slewing ring with inner gear, external gear and non gear.

"Quality First, Service First" is our mission. We win our market with reasonable price and perfect technology. Warmly welcome you to visit our company and hope to cooperate with you in near future.



Luoyang Jiawei Bearing Manufacturing Co.,Ltd





# Concentric Together, Challenge Ourselves

*After years of exploration and learning, the foundation for us is now change*

## JiaWei Bearing Manufacture



### Mission

1. The customer's productivity will be increased and effectiveness will be extended via using our high quality products and first rate service.
2. Improve creativity in order to make full use of resources.
3. Establish trust between business partners and team cooperation spirit within enterprise-internal.
4. To achieve excellence brand and quality with the help of our enterprise culture.

### Prospect

Create well-known brand of slewing bearings

### Tenet

We can supply first class quality and service.

### Spirit

Honesty, pragmatic, development, innovation

### Values

With the basic objective of training high-quality talent, to be the best partner with customer.  
Customer comes first and social progress is our responsibility.  
Striving for an all-round and harmonious development related with us.

### Management Concept

We regard quality as our lives.  
Never stopping to make innovations to develop.  
To make famous brand with our honour.



# Product Introduction



Exquisite Technique, First Trend  
*After years of effort and improving, the product is perfect - no more change*  
 JiaWei Bearing Manufacture

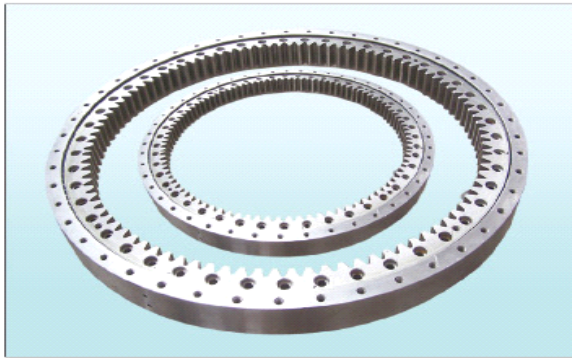

## Double-Row Ball Slewing Bearing



This slewing bearing is comprised of double row steel balls in upper and lower layers, inner ring and outer ring, spacer, lubricating and seal fittings. The inner ring and outer ring are in two separate structures and two half rings need to be fixed by joint bolts.

Due to the upper and lower rows of steel balls, the bearing can carry radial force, axial force and tilting moment simultaneously. Mostly, the bearing is working under axial force and tilting moment together. It is especially suitable for some Loading&Unloading Machines of over-medium diameter, such as Tower Crane, Truck crane and so on.



## Ball and Roller Combination Slewing Bearing

The ball and roller combination of rolling elements can handle small eccentricities at high axial loads and moderate radial loads. It is suited when the structural design requires a large bearing diameter and long working life. For this bearing type, the eccentricity should be small and not exceed 1.2 under operating loads.

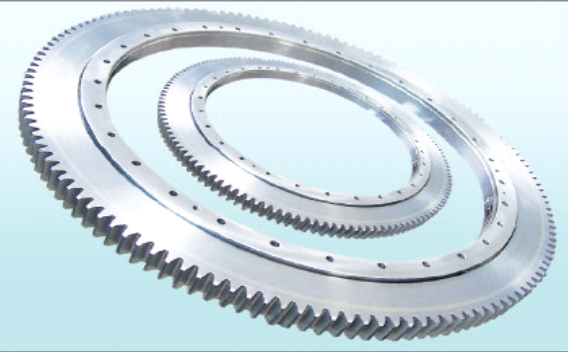
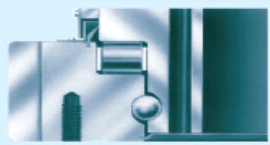

## Double-Row Ball with Different Diameter Slewing Bearing



Double-row different diameter ball slewing bearing has three seats rings. The steel balls and the spacers may be directly arranged into the upper and lower raceways. Two rows of steel balls with different diameters are fitted according to the load. Such open mode fitting features are very convenience. The load angles of both upper and lower races are 90°, which enable the bearing to bear large axial force and the overturning moment. When the radial force is larger than 1/10 of the axial force, the raceways should be especially designed. The axial dimension and radial dimension of double-row ball slewing bearing are rather large, and the bearing construction is sturdy.





### Four-Point Contact Ball Slewing Bearing

Four-Point Contact Ball Slewing Bearing is composed of 2 seat-rings. It is compact in design and light in weight. The balls contact with the circular race at four points, which carry the axial force, radial force and resultant moment simultaneously.

It is mainly used for slewing conveyors, welding arm and positioner, medium duty cranes, excavators and other engineering machines.

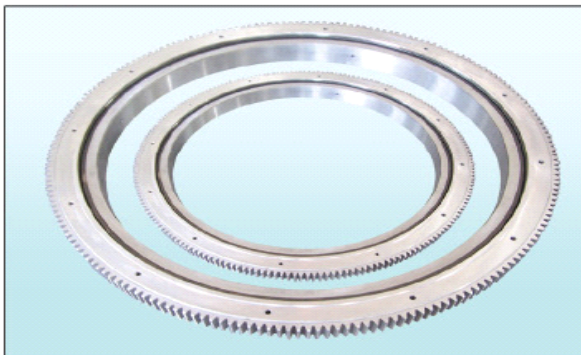
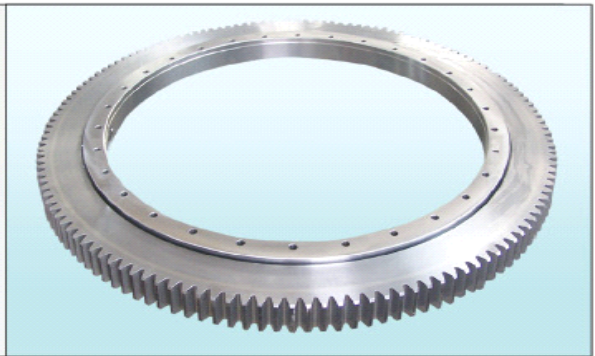

### Cross Roller Slewing Bearing

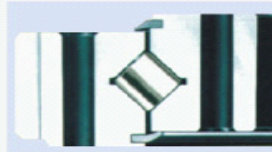

The single-row crossed roller slewing bearing is composed of 2 seat-rings, characterized by its compact in design, light in weight, strict producing accuracy, small fabrication gap and high requirements for mounting accuracy. The rollers are arranged in cross 1:1.

This kind of bearings is able to bear axial loads, overturning torque, and relatively high radial loads.

### Three-Row Roller Slewing Bearing

Three-Row Roller Slewing Ring has 3 seat-rings, Upper Orbit, Nether Orbit and Radial Orbit are separated individually, it makes the load of each row of the rollers can be confirmed, so it can undertake all kinds of different load simultaneously and it's Carrying Capacity is the biggest among four models, one more thing, the axial & radial size are rather large to some extent and the structure is very firm, so it is especially suitable for many heavy-duty machines which require bigger diameter such as Bucket-Wheel Excavator, wheeled Crane, Shipyard Crane, heavy-duty Truck Crane and so on.

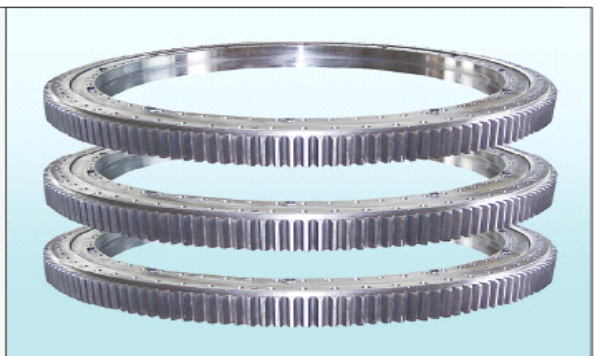
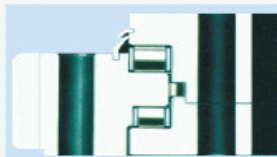

# Advanced Equipments



Exquisite Technique, First Trend  
*After years of learning and improving, the previous JiaWei - we now change*  
JiaWei Bearing Manufacture

Our main production facilities are 5.5m, 4m, 2.5m CNC vertical lathe, CNC drilling machines, grinding machines, hardening machines and some other advanced equipments. We can offer high-precision and high-efficiency products and have excellent reputation from our customers.



※CNC Vertical Lathe



※Hardening Machine



Catalogue:

## 1. Double-Row Ball Slewing Bearing

This slewing bearing is comprised of double row steel balls in upper and lower layers, inner ring and outer ring, spacer, lubricating and seal fittings. The inner ring and outer ring are in two separate structures and two

half rings need to be fixed by joint bolts. Due to the upper and lower rows of steel balls, the bearing can carry radial force, axial force and tilting moment simultaneously. Mostly, the bearing is working under axial force and tilting moment together.

It is especially suitable for some Loading & Unloading Machines of over-medium diameter, such as Tower Crane, Truck crane and so on.

## 2. Ball and Roller Combination Slewing Bearing

The ball and roller combination of rolling elements can handle small eccentricities at high axial loads and moderate radial loads. It is suited when the structural design requires a large bearing diameter and long working life. For this bearing type, the eccentricity should be small and not exceed 1.2 under operating loads.

## 3. Double-Row Ball with Different Diameter Slewing Bearing

Double-row different diameter ball slewing bearing has three seats rings. The steel balls and the spacers may be directly arranged into the upper and lower raceways. Two rows of steel balls with different diameters are fitted according to the load.

Such open mode fitting features are very convenience. The load angles of both upper and lower races are  $90^\circ$ , which enable the bearing to bear large axial force and the overturning moment. When the radial force is larger than 1/10 of the axial force, the raceways should be especially designed. The axial dimension and radial dimension of double-row ball slewing bearing are rather large, and the bearing construction is sturdy .

## 4. Four-Point Contact Ball Slewing Bearing

Four-Point Contact Ball Slewing Bearing is composed of 2 seat-rings. It is compact in design and light in weight. The balls contact with the circular race at four points, which carry the axial force, radial force and resultant moment simultaneously.

It is mainly used for slewing conveyors, welding arm and positioner, medium duty cranes, excavators and other engineering machines

## 5. Cross Roller Slewing Bearing

The single-row crossed roller slewing bearing is composed of 2 seat-rings, characterized by its compact in design, light in weight, strict producing accuracy, small fabrication gap and high requirements for mounting accuracy. The rollers are arranged in cross 1:1.

This kind of bearings is able to bear axial loads, overturning torque, and relatively high radial loads.

## 6. Three-Row Roller slewing bearing.

Three-Row Roller Slewing Ring has 3 seat-rings, Upper Orbit, Nether Orbit and Radial Orbit are separated individually, it makes the load of each row of the rollers can be confirmed, so it can undertake all kinds of different load simultaneously and it's Carrying Capacity is the biggest among four models, one more thing, the axial & radial size are rather large to some extent and the structure is very firm, so it is especially suitable for many heavy-duty machines which require bigger diameter such as Bucket-Wheel Excavator, wheeled Crane, Shipyard Crane, heavy-duty Truck Crane and so on.



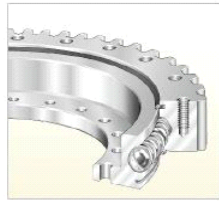

四点接触球转盘轴承

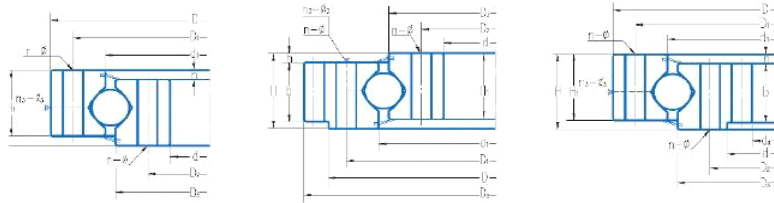

■技术参数

轴承型号 Designations			外形尺寸 Boundary dimensions		安装孔尺寸 Bolt hole diameter				结构尺寸 Structure dimensions					齿轮参数 Gear parameters				额定负荷 Basic load ratings	质量 Mass					
无齿式 non-gear type	外齿式 external gear type	内齿式 internal gear type	D	d	H	D1	D2	n	φ	D3	d1	H1	h	n3	φ3	m	Da	Z	da	Z	b	x	Coa 10 <sup>4</sup> N	kg
010 · 60 · 2240 · **	011 · 60 · 2240 · ** 012 · 60 · 2240 · **	013 · 60 · 2240 · **	2418	2065	144	2350	2131	48	33	2237.5	2242.5	132	12	8	M10×1	16	2496	153	1984	125	120	+0.5	1350	1250
010 · 60 · 2500 · **	011 · 60 · 2500 · ** 012 · 60 · 2500 · **	013 · 60 · 2500 · **	2678	2325	144	2610	2391	56	33	2497.5	2502.5	132	12	8	M10×1	18	2772	151	2232	125	120	+0.5	1500	1400
010 · 60 · 2800 · **	011 · 60 · 2800 · ** 012 · 60 · 2800 · **	013 · 60 · 2800 · **	2978	2625	144	2910	2691	56	33	2797.5	2802.5	132	12	8	M10×1	18	3078	168	2520	141	120	+0.5	1680	1600
010 · 75 · 3150 · **	011 · 75 · 3150 · ** 012 · 75 · 3150 · **	013 · 75 · 3150 · **	3376	2922	174	3286	3014	56	45	3147.5	3152.5	162	12	8	M10×1	20	3480	171	2820	142	150	+0.5	2380	2800
010 · 75 · 3550 · **	011 · 75 · 3550 · ** 012 · 75 · 3550 · **	013 · 75 · 3550 · **	3776	3322	174	3686	3414	56	45	3547.5	3552.5	162	12	8	M10×1	20	3880	191	3220	162	150	+0.5	2690	3200
010 · 75 · 4000 · **	011 · 75 · 4000 · ** 012 · 75 · 4000 · **	013 · 75 · 4000 · **	4226	3772	174	4136	3864	60	45	3997.5	4002.5	162	12	10	M10×1	22	4334	194	3652	167	150	+0.5	3020	3600
010 · 75 · 4500 · **	011 · 75 · 4500 · ** 012 · 75 · 4500 · **	013 · 75 · 4500 · **	4726	4272	174	4636	4364	60	45	4497.5	4502.5	162	12	10	M10×1	22	4840	271	4158	190	150	+0.5	3410	4000



双排角接触推力球转盘轴承

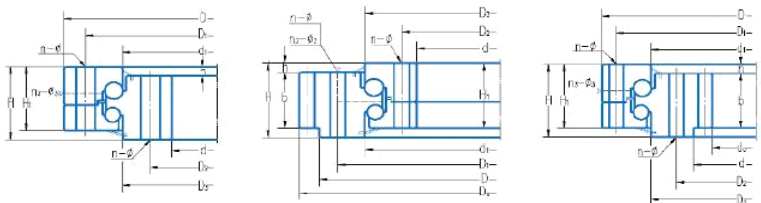

■技术参数

轴承型号 Designations			外形尺寸 Boundary dimensions		安装孔尺寸 Bolt hole diameter				结构尺寸 Structure dimensions					齿轮参数 Gear parameters				额定负荷 Basic load ratings	质量 Mass					
无齿式 non-gear type	外齿式 external gear type	内齿式 internal gear type	D	d	H	D1	D2	n	φ	D3	d1	H1	h	n3	φ3	m	Da	Z	da	Z	b	x	Coa 10 <sup>4</sup> N	kg
020 · 25 · 500 · **	021 · 25 · 500 · ** 022 · 25 · 500 · **	023 · 25 · 500 · **	616	384	106	580	420	20	18	523	517	96	26	4	M10×1	5	645	126	355	72	60	+0.5	121	100
020 · 25 · 560 · **	021 · 25 · 560 · ** 022 · 25 · 560 · **	023 · 25 · 560 · **	676	444	106	640	480	20	18	583	577	96	26	4	M10×1	5	705	138	415	84	60	+0.5	134	115
020 · 25 · 630 · **	021 · 25 · 630 · ** 022 · 25 · 630 · **	023 · 25 · 630 · **	746	514	106	710	550	24	18	653	647	96	26	4	M10×1	6	792	129	480	81	60	+0.5	153	130
020 · 25 · 710 · **	021 · 25 · 710 · ** 022 · 25 · 710 · **	023 · 25 · 710 · **	826	594	106	790	630	24	18	733	727	96	26	4	M10×1	6	864	141	558	94	60	+0.5	173	140
020 · 30 · 800 · **	021 · 30 · 800 · ** 022 · 30 · 800 · **	023 · 30 · 800 · **	942	658	124	898	702	30	22	828	822	114	29	6	M10×1	8	984	120	616	78	80	+0.5	230	200
020 · 30 · 900 · **	021 · 30 · 900 · ** 022 · 30 · 900 · **	023 · 30 · 900 · **	1042	758	124	998	802	30	22	928	922	114	29	6	M10×1	8	1088	133	712	90	80	+0.5	258	250
020 · 30 · 1000 · **	021 · 30 · 1000 · ** 022 · 30 · 1000 · **	023 · 30 · 1000 · **	1142	858	124	1098	902	36	22	1028	1022	114	29	6	M10×1	10	1200	117	810	82	80	+0.5	286	300
020 · 30 · 1120 · **	021 · 30 · 1120 · ** 022 · 30 · 1120 · **	023 · 30 · 1120 · **	1262	978	124	1218	1022	36	22	1148	1142	114	29	6	M10×1	10	1320	129	920	93	80	+0.5	321	340
020 · 40 · 1250 · **	021 · 40 · 1250 · ** 022 · 40 · 1250 · **	023 · 40 · 1250 · **	1426	1074	160	1374	1126	40	26	1286	1282	150	39	6	M10×1	12	1500	122	1008	85	90	+0.5	482	580
020 · 40 · 1400 · **	021 · 40 · 1400 · ** 022 · 40 · 1400 · **	023 · 40 · 1400 · **	1576	1224	160	1524	1272	40	26	1436	1432	150	39	6	M10×1	12	1644	134	1152	97	90	+0.5	543	650
020 · 40 · 1600 · **	021 · 40 · 1600 · ** 022 · 40 · 1600 · **	023 · 40 · 1600 · **	1776	1424	160	1724	1476	45	26	1636	1632	150	39	8	M10×1	14	1848	129	1344	97	90	+0.5	620	750
020 · 40 · 1800 · **	021 · 40 · 1800 · ** 022 · 40 · 1800 · **	023 · 40 · 1800 · **	1976	1624	160	1924	1676	45	26	1836	1832	150	39	8	M10×1	14	2058	144	1540	111	90	+0.5	692	820
020 · 50 · 2000 · **	021 · 50 · 2000 · ** 022 · 50 · 2000 · **	023 · 50 · 2000 · **	2215	1785	190	2149	1851	48	33	2038	2032	178	47	8	M10×1	16	2304	141	1696	107	120	+0.5	987	1150
020 · 50 · 2240 · **	021 · 50 · 2240 · ** 022 · 50 · 2240 · **	023 · 50 · 2240 · **	2455	2025	190	2389	2091	48	33	2278	2272	178	47	8	M10×1	16	2544	156	1936	122	120	+0.5	1110	1500

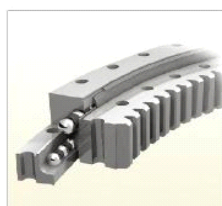

双排角接触推力球转盘轴承

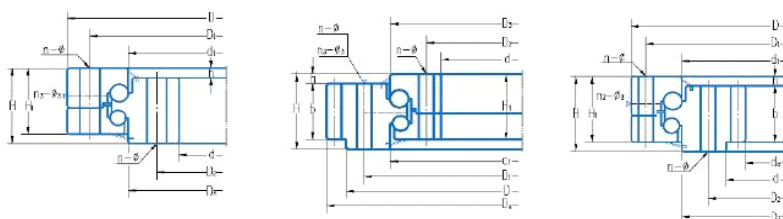

■ 技术参数

轴承型号 Designations			外形尺寸 Boundary dimensions			安装孔尺寸 Bolt hole diameter				结构尺寸 Structure dimensions					齿轮参数 Gear parameters				额定负荷 Basic load ratings	质量 Mass				
无齿式 non-gear type	外齿式 external gear type	内齿式 internal gear type	D	d	H	D1	D2	n	φ	D3	d1	H1	h	n3	φ3	m	Da	Z	da	Z	b	x	Coa 10 <sup>4</sup> N	kg
020 · 50 · 2500 · **	021 · 50 · 2500 · **	023 · 50 · 2500 · **	2715	2285	190	2649	2351	56	33	2538	2532	78	47	8	M10 × 1	18	2804	153	2196	123	120	+0.5	1110	1500
	022 · 50 · 2500 · **	024 · 50 · 2500 · **	2715	2285	190	2649	2351	56	33	(2468)	(2462)	78	47	8	M10 × 1	20	2820	138	2180	110	120	+0.5	1110	1500
020 · 50 · 2800 · **	021 · 50 · 2500 · **	023 · 50 · 2800 · **	2715	2285	190	2649	2351	56	33	2550	2538	78	47	8	M10 × 1	18	2804.4	153					1117	2051
	022 · 50 · 2800 · **	024 · 50 · 2800 · **	3015	2585	190	2949	2651	56	33	2838	2832	178	47	8	M10 × 1	18	3114	170	2484	139	120	+0.5	1390	1900
020 · 60 · 3150 · **	021 · 60 · 3150 · **	023 · 60 · 3150 · **	3428	2872	226	3338	2962	56	45	3198	3192	214	56	8	M10 × 1	20	3540	174	2760	139	150	+0.5	1870	3300
	022 · 60 · 3150 · **	024 · 60 · 3150 · **	3428	2872	226	3338	2962	56	45	(3108)	(3102)	214	56	8	M10 × 1	22	3542	158	2750	126	150	+0.5	1870	3300
020 · 60 · 3550 · **	021 · 60 · 3550 · **	023 · 60 · 3550 · **	3828	3272	226	3738	3362	56	45	3598	3592	214	56	8	M10 × 1	20	3940	194	3160	159	150	+0.5	2110	3700
	022 · 60 · 3550 · **	024 · 60 · 3550 · **	3828	3272	226	3738	3362	56	45	(3508)	(3502)	214	56	8	M10 × 1	22	3938	176	3168	145	150	+0.5	2110	3700
020 · 60 · 4000 · **	021 · 60 · 4000 · **	023 · 60 · 4000 · **	4278	3722	226	4188	3812	60	45	4048	4042	214	56	10	M10 × 1	25	4400	197	3608	165	150	+0.5	2370	4200
	022 · 60 · 4000 · **	024 · 60 · 4000 · **	4278	3722	226	4188	3812	60	45	(3958)	(3952)	214	56	10	M10 × 1	25	4400	173	3600	145	150	+0.5	2370	4200
020 · 60 · 4500 · **	021 · 60 · 4500 · **	023 · 60 · 4500 · **	4778	4222	226	4688	4312	60	45	4548	4542	214	56	10	M10 × 1	22	4884	219	4114	188	150	+0.5	2670	4700
	022 · 60 · 4500 · **	024 · 60 · 4500 · **	4778	4222	226	4688	4312	60	45	(4458)	(4452)	214	56	10	M10 × 1	25	4900	193	4100	165	150	+0.5	2670	4700

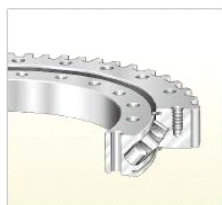

交叉圆柱滚子转盘轴承

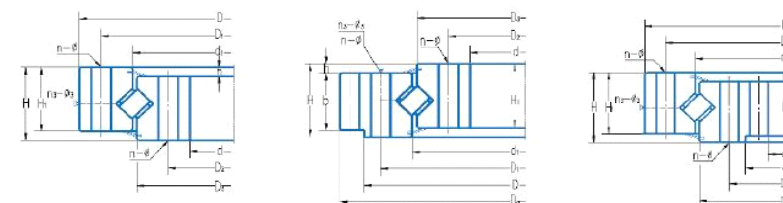

■ 技术参数

轴承型号 Designations			外形尺寸 Boundary dimensions			安装孔尺寸 Bolt hole diameter				结构尺寸 Structure dimensions					齿轮参数 Gear parameters				额定负荷 Basic load ratings	质量 Mass				
无齿式 non-gear type	外齿式 external gear type	内齿式 internal gear type	D	d	H	D1	D2	n	φ	D3	d1	H1	h	n3	φ3	m	Da	Z	da	Z	b	x	Coa 10 <sup>4</sup> N	kg
110 · 25 · 500 · **	111 · 25 · 500 · **	113 · 25 · 500 · **	602	398	75	566	434	20	18	499	501	65	10	4	M10 × 1	5	630	123	365	74	60	0.5	104	80
	112 · 25 · 500 · **	114 · 25 · 500 · **	602	398	75	566	434	20	18	499	501	65	10	4	M10 × 1	6	630	120	360	62	60	0.5	104	80
110 · 25 · 560 · **	111 · 25 · 560 · **	113 · 25 · 560 · **	662	458	75	626	494	20	18	558.5	561.5	65	10	4	M10 × 1	5	690	135	425	86	60	0.5	116	90
	112 · 25 · 560 · **	114 · 25 · 560 · **	662	458	75	626	494	20	18	558.5	561.5	65	10	4	M10 × 1	6	690	112	426	112	60	0.5	116	90
110 · 25 · 630 · **	111 · 25 · 630 · **	113 · 25 · 630 · **	732	528	75	696	564	24	18	628.5	631.5	65	10	4	M10 × 1	6	774	126	492	83	60	0.5	130	100
	112 · 25 · 630 · **	114 · 25 · 630 · **	732	528	75	696	564	24	18	628.5	631.5	65	10	4	M10 × 1	8	776	94	488	62	60	0.5	130	100
110 · 25 · 710 · **	111 · 25 · 710 · **	113 · 25 · 710 · **	812	608	75	776	644	24	18	708.5	711.5	65	10	4	M10 × 1	6	852	139	570	96	60	0.5	149	110
	112 · 25 · 710 · **	114 · 25 · 710 · **	812	608	75	776	644	24	18	708.5	711.5	65	10	4	M10 × 1	8	856	104	568	72	60	0.5	149	110
110 · 28 · 800 · **	111 · 28 · 800 · **	113 · 28 · 800 · **	922	678	82	878	722	30	22	798.5	801.5	72	10	6	M10 × 1	8	968	118	632	80	65	0.5	185	170
	112 · 28 · 800 · **	114 · 28 · 800 · **	922	678	82	878	722	30	22	798.5	801.5	72	10	6	M10 × 1	10	970	94	630	64	65	0.5	185	170
110 · 28 · 900 · **	111 · 28 · 900 · **	113 · 28 · 900 · **	1022	778	82	978	822	30	22	898.5	901.5	72	10	6	M10 × 1	8	1064	130	736	93	65	0.5	209	190
	112 · 28 · 900 · **	114 · 28 · 900 · **	1022	778	82	978	822	30	22	898.5	901.5	72	10	6	M10 × 1	10	1070	104	730	74	65	0.5	209	190
110 · 28 · 1000 · **	111 · 28 · 1000 · **	113 · 28 · 1000 · **	1122	878	82	1078	922	36	22	998.5	1001.5	72	10	6	M10 × 1	10	1190	116	820	83	65	0.5	233	210
	112 · 28 · 1000 · **	114 · 28 · 1000 · **	1122	878	82	1078	922	36	22	998.5	1001.5	72	10	6	M10 × 1	12	1188	96	816	69	65	0.5	233	210
110 · 28 · 1120 · **	111 · 28 · 1120 · **	113 · 28 · 1120 · **	1242	998	82	1198	1042	36	22	1118	1122	72	10	6	M10 × 1	10	1300	127	940	95	65	0.5	262	230
	112 · 28 · 1120 · **	114 · 28 · 1120 · **	1242	998	82	1198	1042	36	22	1118	1122	72	10	6	M10 × 1	12	1308	106	936	79	65	0.5	262	230
110 · 32 · 1250 · **	111 · 32 · 1250 · **	113 · 32 · 1250 · **	1390	1110	91	1337	1163	40	26	1248	1252	81	10	6	M10 × 1	12	1452	118	1044	88	75	0.5	321	350
	112 · 32 · 1250 · **	114 · 32 · 1250 · **	1390	1110	91	1337	1163	40	26	1248	1252	81	10	6	M10 × 1	14	1456	101	1036	75	75	0.5	321	350
110 · 32 · 1400 · **	111 · 32 · 1400 · **	113 · 32 · 1400 · **	1540	1260	91	1487	1313	40	26	1398	1402	81	10	6	M10 × 1	12	1608	131	1188	100	75	0.5	358	400
	112 · 32 · 1400 · **	114 · 32 · 1400 · **	1540	1260	91	1487	1313	40	26	1398	1402	81	10	6	M10 × 1	14	1610	112	1190	86	75	0.5	358	400
110 · 32 · 1600 · **	111 · 32 · 1600 · **	113 · 32 · 1600 · **	1740	1460	91	1687	1513	45	26	1598	1602	81	10	8	M10 × 1	14	1820	127	1386	100	75	0.5	412	440
	112 · 32 · 1600 · **	114 · 32 · 1600 · **	1740	1460	91	1687	1513	45	26	1598	1602	81	10	8	M10 × 1	16	1824	111	1376	87	75	0.5	412	440
110 · 32 · 1800 · **	111 · 32 · 1800 · **	113 · 32 · 1800 · **	1940	1660	91	1887	1713	45	26	1798	1802	81	10	8	M10 × 1	14	2016	141	1568	113	75	0.5	460	500
	112 · 32 · 1800 · **	114 · 32 · 1800 · **	1940	1660	91	1887	1713	45	26	1798	1802	81	10	8	M10 × 1	16	2016	123	1568	99	75	0.5	460	500



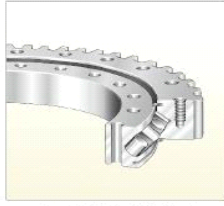

交叉圆柱滚子转盘轴承

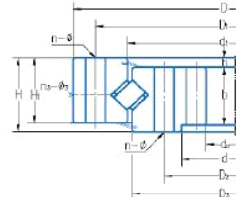
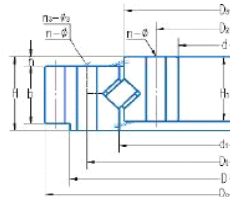
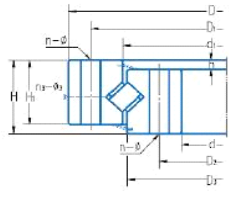

技术参数

轴承型号 Designations			外形尺寸 Boundary dimensions			安装孔尺寸 Bolt hole diameter				结构尺寸 Structure dimensions					齿轮参数 Gear parameters					额定负荷 Basic load ratings	质量 Mass			
无齿式 non-gear type	外齿式 external gear type	内齿式 internal gear type	D	d	H	D1	D2	n	φ	D3	d1	H1	h	n3	φ3	m	Da	Z	da	Z	b	x	Coa	kg
			mm	mm	mm	mm	mm	mm	mm	mm	mm	mm	mm	mm	mm	mm	mm	mm	mm	mm	mm	mm	10 <sup>4</sup> N	
110-40-2000	111-40-2000	113-40-2000	2178	1825	112	2110	1891	48	33	1998	2002	100	12	8	M10×1	16	2272	139	1728	109	90	0.5	686	900
	112-40-2000	2178	1825	112	2110	1891	48	33	1998	2002	100	12	8	M10×1	18	2268	123	1728	97	90	0.5	686	900	
110-40-2240	111-40-2240	113-40-2240	2418	2065	112	2350	2151	48	33	2237.5	2242.5	100	12	8	M10×1	16	2496	153	1984	125	90	0.5	764	1000
	112-40-2240	2418	2065	112	2350	2151	48	33	2237.5	2242.5	100	12	8	M10×1	18	2502	136	1980	111	90	0.5	764	1000	
110-40-2500	111-40-2500	113-40-2500	2678	2325	112	2610	2391	56	33	2497.5	2502.5	100	12	8	M10×1	18	2772	151	2232	125	90	0.5	797	876
	112-40-2500	2678	2325	112	2610	2391	56	33	2497.5	2502.5	100	12	8	M10×1	20	2780	136	2220	112	90	0.5	797	876	
110-40-2800	111-40-2800	113-40-2800	2978	2625	112	2910	2691	56	33	2797.5	2802.5	100	12	8	M10×1	18	3078	168	2520	141	90	0.5	960	1250
	112-40-2800	2978	2625	112	2910	2691	56	33	2797.5	2802.5	100	12	8	M10×1	20	3080	151	2520	127	90	0.5	960	1250	
110-50-3150	111-50-3150	113-50-3150	3376	2922	134	3286	3014	56	45	3147.5	3152.5	122	12	8	M10×1	20	3480	171	2820	142	110	0.5	1380	2150
	112-50-3150	3376	2922	134	3286	3014	56	45	3147.5	3152.5	122	12	8	M10×1	22	3476	155	2816	129	110	0.5	1380	2150	
110-50-3550	111-50-3550	113-50-3550	3776	3322	134	3686	3414	56	45	3547.5	3552.5	122	12	8	M10×1	20	3880	191	3220	162	110	0.5	1570	2470
	112-50-3550	3776	3322	134	3686	3414	56	45	3547.5	3552.5	122	12	8	M10×1	22	3894	174	3212	147	110	0.5	1570	2470	
110-50-4000	111-50-4000	113-50-4000	4226	3772	134	4136	3864	60	45	3997.5	4002.5	122	12	10	M10×1	22	4334	194	3652	167	110	0.5	1760	2800
	112-50-4000	4226	3772	134	4136	3864	60	45	3997.5	4002.5	122	12	10	M10×1	25	4350	171	3650	147	110	0.5	1760	2800	
110-50-4500	111-50-4500	113-50-4500	4726	4272	134	4636	4364	60	45	4497.5	4502.5	122	12	10	M10×1	22	4940	217	4158	190	110	0.5	1980	3100
	112-50-4500	4726	4272	134	4636	4364	60	45	4497.5	4502.5	122	12	10	M10×1	25	4850	191	4150	167	110	0.5	1980	3100	

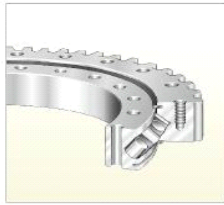

交叉圆柱滚子转盘轴承

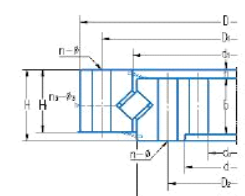
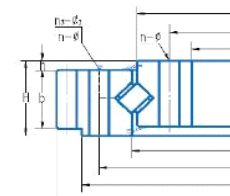
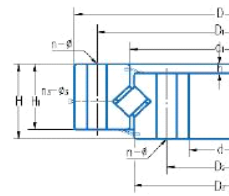

技术参数

轴承型号 Designations		外形尺寸 Boundary dimensions			安装孔尺寸 Bolt hole diameter				结构尺寸 Structure dimensions					额定负荷 Basic load ratings	质量 Mass			
无齿式 non-gear type		D	d	H	D1	D2	n1	n2	φ1	φ2	D3	d1	H1	h	n3	φ3	Coa	kg
		mm	mm	mm	mm	mm	mm	mm	mm	mm	mm	mm	mm	mm	mm	mm	10 <sup>4</sup> N	
79764		550	320	85	515	365	12	8	17	18	438	442	75	10	---	---	88.2	85.6
797600G2		900	600	125	848	690	30	29	26	M24	750	754	105	15	3	M10×1	280	246
797670		907	670	85	870	730	12	8	M16	18	808	812	75	10	---	---	165	170
797700G		1000	700	140	940	770	24	24	M20	22	879	882	130	20	4	M10×1	254	370
797845G2		1150	845	130	1100	895	24	24	22	22	1024	1030	105	10	6	M6	401	393
797870G		1180	870	115	1125	920	18	18	28	28	1023	1027	100	15	2	M8×1	292	355
797870K		1180	870	115	1125	920	18	18	28	28	1023	1027	100	15	2	M10×1	232	355
797870G2K1		1180	870	115	1125	920	18	18	28	28	1023	1027	100	15	2	M10×1	320	356
797962G2		1200	962	90	---	---	---	---	---	---	1088	1092	76	10	---	---	254	224
7921000G2		1270	1000	100	1220	1050	36	36	19	19	1132	1138	85	15	4	M10×1	333	303
7921000G2K		1270	1000	100	1220	1050	36	36	19	19	1132	1138	85	15	3	---	333	303
7921000G2K		1270	1000	100	1220	1050	36	36	19	19	1132	1138	85	15	---	---	333	303
7921000G2K		1270	1000	100	1220	1050	36	36	19	19	1132	1138	85	15	---	---	333	303
7921000G2K		1400	1060	120	---	---	---	---	---	---	1248	1252	120	---	---	---	429	596
7971200G2		1520	1200	90	---	---	---	---	---	---	1356	1364	90	---	---	---	409	504
7921250G2		1700	1250	155	1650	1350	24	24	26	26	1446	1450	140	10	6	M10×1	602	1103
7971250G2		1608	1250	148	1512	1297	16	16	25	25	1403	1407	128	26	4	M10×1	595	743
7971250G2K		1608	1250	148	1512	1297	16	16	25	25	1403	1407	128	26	4	M10×1	595	717
7971278G2K		1660	1278	120	1555	1355	18	18	26	26	1428	1432	105	15	4	M10×1	427	589
7971320G2		1715	1320	134	---	---	---	---	---	---	1503	1509	---	---	---	---	576	759
7971370G		1840	1370	160	1770	1430	30	24	28	28	1598	1602	140	10	4	M10×1	607	1213
7971380G2		1700	1380	145	1650	1440	24	24	27	27	1568	1574	140	5	6	M10×1	461	746
3-944G2		1680	1412	170	---	1460	---	24	---	18	1544	1548	120	25	2	M10×1	617	725
3-944G2K		1680	1412	170	---	1460	---	24	---	18	1544	1548	120	25	2	M10×1	576	723
3-944G2K1		1680	1412	185	---	1460	---	24	---	18	1544	1548	120	25	2	M12×1.25	576	759
7971600G		2140	1600	145	1940	1710	48	48	26	26	1828	1832	135	10	4	M10×1	896	1357
797176G2		2210	1776	150	2105	1840	36	36	26	26	1968	1972	135	15	4	M10×1	1113	1244
7971860G2		2320	1860	151	2245	1980	42	42	33	33	2113	2117	150	10	6	M10×1	890	1772
7971916G2		2320	1916	150	2245	1980	42	42	34	34	2113	2117	130	20	3	M10×1	1195	1214
7972190G		2860	2190	300	2800	2270	36	36	32	32	2530	2550	260	40	12	8	3035	4797
7922500G2		2980	2500	180	2910	2590	48	48	33	33	2739	2743	170	10	6	M16×1.5	1760	2913
7922800G		3310	2800	190	3220	2890	60	60	39	39	3050	3060	165	25	2	M10×1	2117	2864





## Application

Our slewing bearings are widely used in mining and metallurgical machinery, oil and chemical industry, construction machinery, wind power equipments, port machinery, high-precision radar and missile launchers, aerospace and some other fields.





# Company Achievements Sales and Services Network

LYJW base ourselves on accurate market positioning in order to optimize the industrial structure continuously, and strive to build the core competitiveness of enterprise. We focus on lifting machinery, mining machinery, construction machinery, port machinery, marine machinery, wind power machinery and high-precision radar and missile launchers to develop ourselves and create a wonderful future.

In the national applied fields of slewing bearing, LYJW depend on high-quality, professional and competitive industries to establish well business relationship with many heavy machinery enterprises in China such as Haerbin Heavy Machinery, Changsha Heavy Machinery, China First Heavy Machinery and Jingjiang Xianlong Lifting Machinery or some other enterprises. Meanwhile, we active to open international market and our products have exported to Africa, Europe, Asia, Middle East, the United States and etc. The quality has been obtained high reputation from our customers and our market scale is expanding continuously, from all of that embody brand style of well-known enterprises and strength of the market development.

