

### 3 Functions and Features

- 1.No damage to thread. Remove taps out easily from any conductive material. High efficiency and low cost.
- 2.Portability: Light, small, seperated head and power supply, machining easily on large work.
- 3.Depth setting: Auto feed,stop at setting depth, alarm and auto retract.
- 4.Dielectric liquid: Common tap water.
- 5.Electrode: Brass rod, sheet, hexagonal electrodes.



### 4 After-sales Service

The warranty period for Broken Tap Remover is around one year and within this time frame, if there are any technical problems, we would repair them for free including the new parts that needed for the repair.



Our company guarantees the quality of SFX-4000B. If the machine could not work for any major problems of the quality, please contact us immediately. Once the case is verified, please destroy the machine and record the destruction video. After we authenticate the video, we would issue a full refund.



OFFICIAL WEBSITE

SKYPE : amynie2015  
E-MAIL: edmmachine@lyxc.com

www.brokentapremover.com

Tel: +86-379-63512276 Mob: +86 13213632729

# HIGH POWER EDM BROKEN TAP REMOVER

Remove broken taps, drills, studs without damage to the threads. Save valuable parts!



SFX®

LUOYANG XINCHENG PRECISION MACHINERY CO.,LTD

## 7 Product Show



Power source choices: 110V or 220V, 50HZ or 60HZ.

### Specification

Model	SFX-4000B	EDM-8C
Basic Function		
Stepper Current	✓	✓
Depth setting, auto retract and alarm	✓	✓
Accessories storage	Inside the power supplier	Toolkit
Technical Parameter		
Input Power (w)	300~3000	800
Electrode Holder Diameter (mm)	2-13	0.8-10
Working liquid	Tap water (Pure water/distilled water is better.)	
Max Process Depth of spindle servo (mm)	70	70
Short Hole Processing Speed (mm/min)	≈2      ≈1	≈1
Processed Material: Quenched Steel	ElectrodeΦ5    ElectrodeΦ12	ElectrodeΦ4
Power Box Size(mm):	420*220*370	380*160*300
Model and size of working head (mm)	ZK8 300*50*50	ZK8 300*50*50
Package Size (mm)	528*325*460	498*308*392
Net Weight (kg)	22	16

## 2 Operation Skills

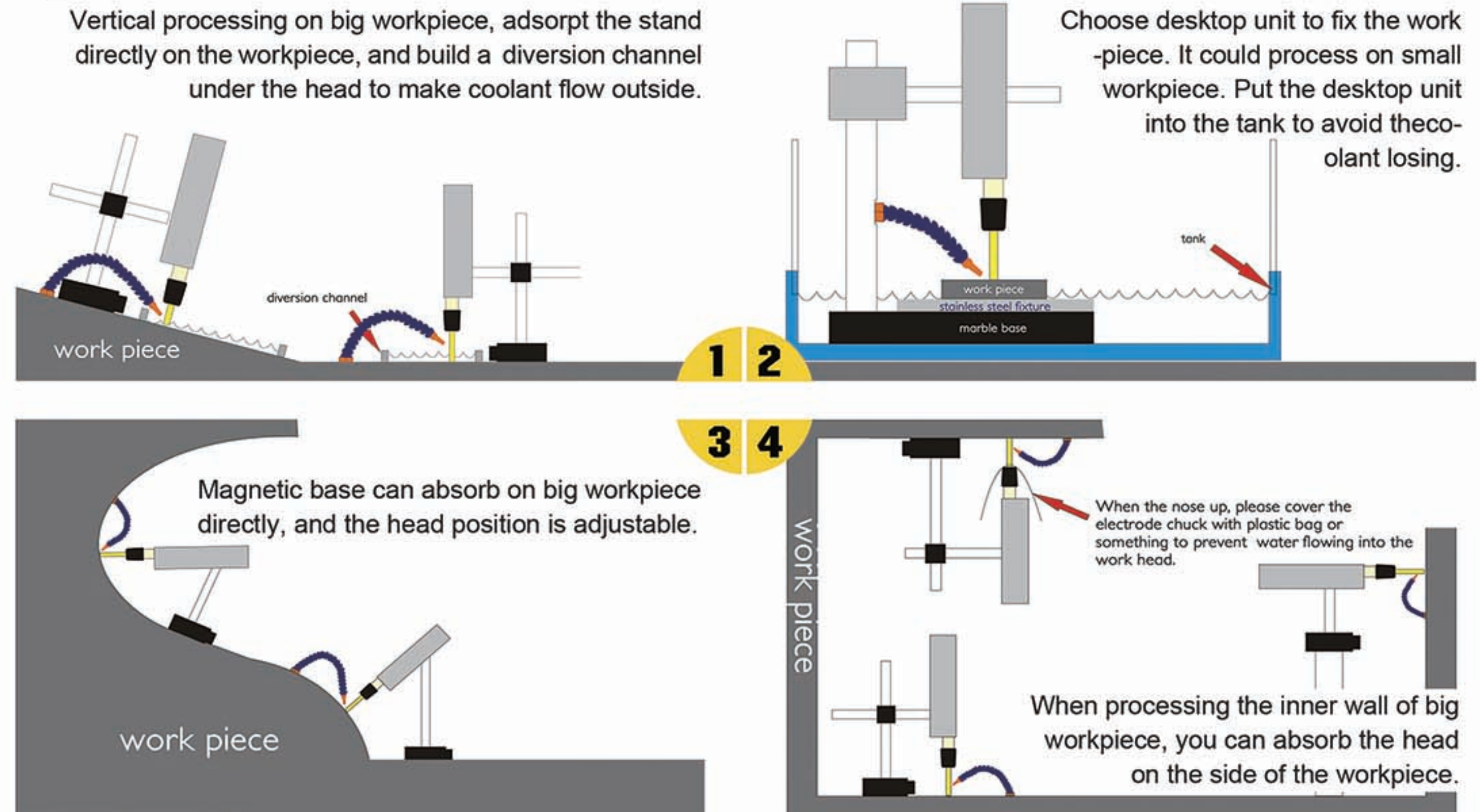

### How to remove broken tap, drill, screw etc. out

The common ground of tap, drill, etc. is that the central part is solid. So the tap or drill could be removed out by smashing the central part. Before processing, please clean up the rust or oxide layer. When processing deep hole or work piece in deep channel, hollow electrode and high pressure water pump could help increase the pollution discharge speed. (Figure 1)

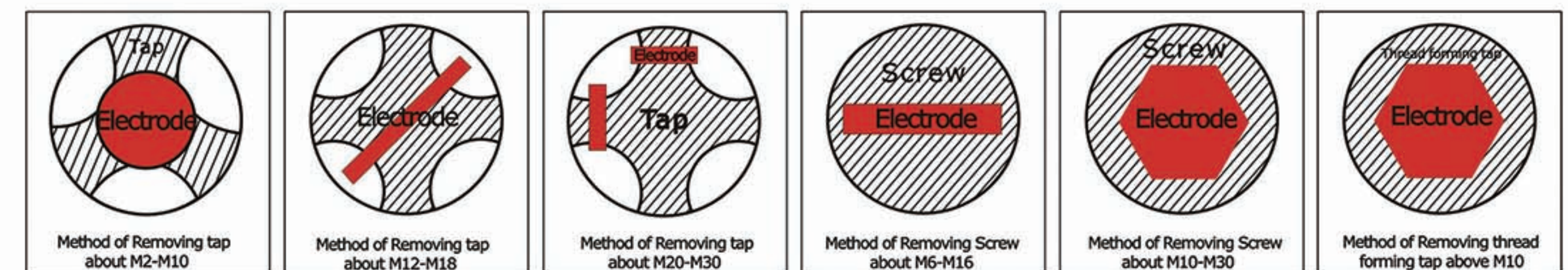

(Figure 1)

When the diameter of the screw is too big or its strength grade is over 8.8, general processing method is unsuitable. You can process a groove of 2-3mm depth with a sheet electrode. Then unscrew it with a screwdriver or hexagon spanner. If the processing position is too deep for general screw extractor, the hexagon spanner would help. (Figure 2)

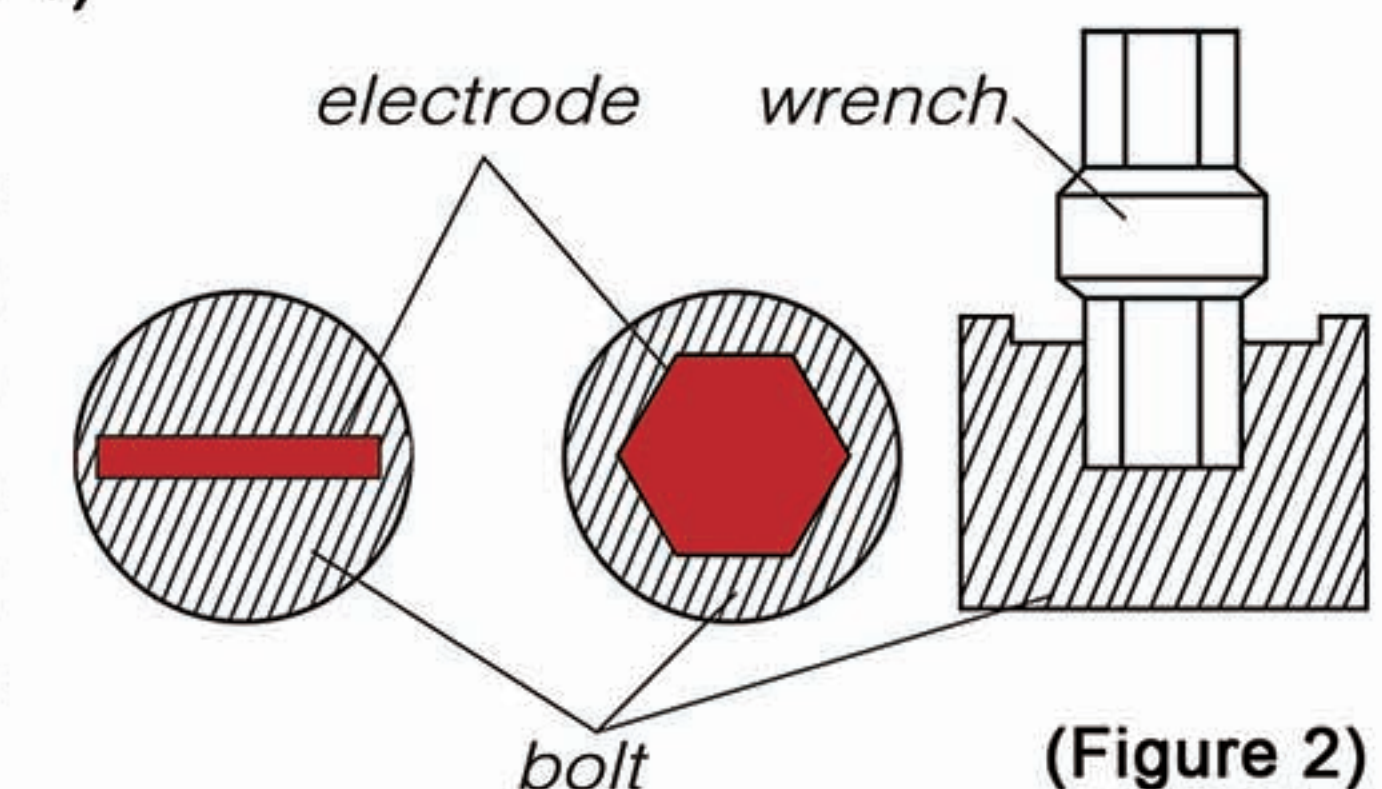

(Figure 2)