

Deep-bed filter MTBF 500

Used for 3 month

**2 UNITS
available**





for continuous filtration of:

- aqueous cooling lubricants
- oils and other liquids.

with fabric paper band filter output: 650 l/min

Including 1x spare filter fleece and complete documentation (operating manual, electrical diagram, layout, drawings) as hard copy and CD

Liqui - Technical Data's

Use	:	Filtration of coolants
Model	:	MTBF – V 500
Year	:	2012
Factory – No	:	31220 + 31221
Flow rate	:	650 l/min (Emulsion)
Voltage / electric link	:	3 x 400 V/N/PE 50 Hz
Control voltage	:	24 V DC
Rated	:	13.0 kVA
Current	:	18.6 A
Container Volume	:	900 L



Liqui - Functions

The contaminated fluid which is to be cleaned are fed in the filter range which is provided for that purpose. (1) The fluid column in the container creates a static pressure which bears on the filter fleece (2). The static pressure supports the fluid flowing through the filter fleece into the clean container from where the clean-fluid pump will pump it back to the place of use. The solids remain on the filter fleece and form a filter cake. The increasing thickness of the filter cake sinks the through flow quantity. This results in an increase of the fluid level in the filter. A distance sensor (5) occupies the fluid level. The float switch (3) is tripped and the filter fleece is jogged forward. The consumed fleece (2) is wound up (4) and the filtered particles are deposited in the sludge container.

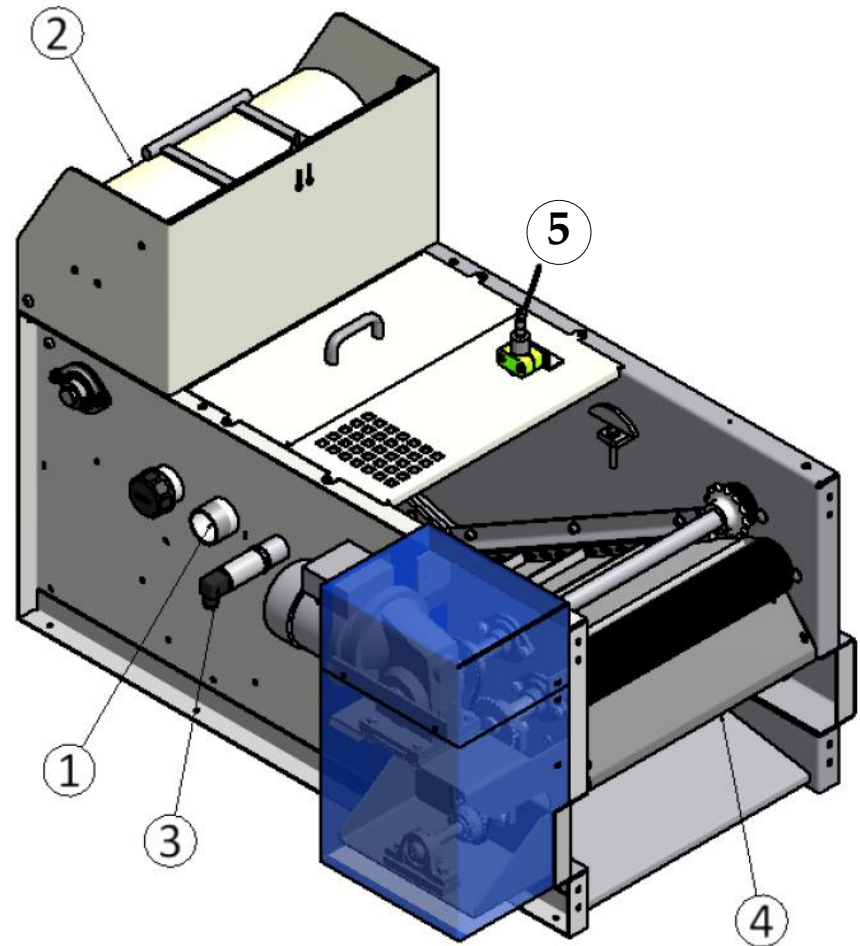

Liqui - Function diagram

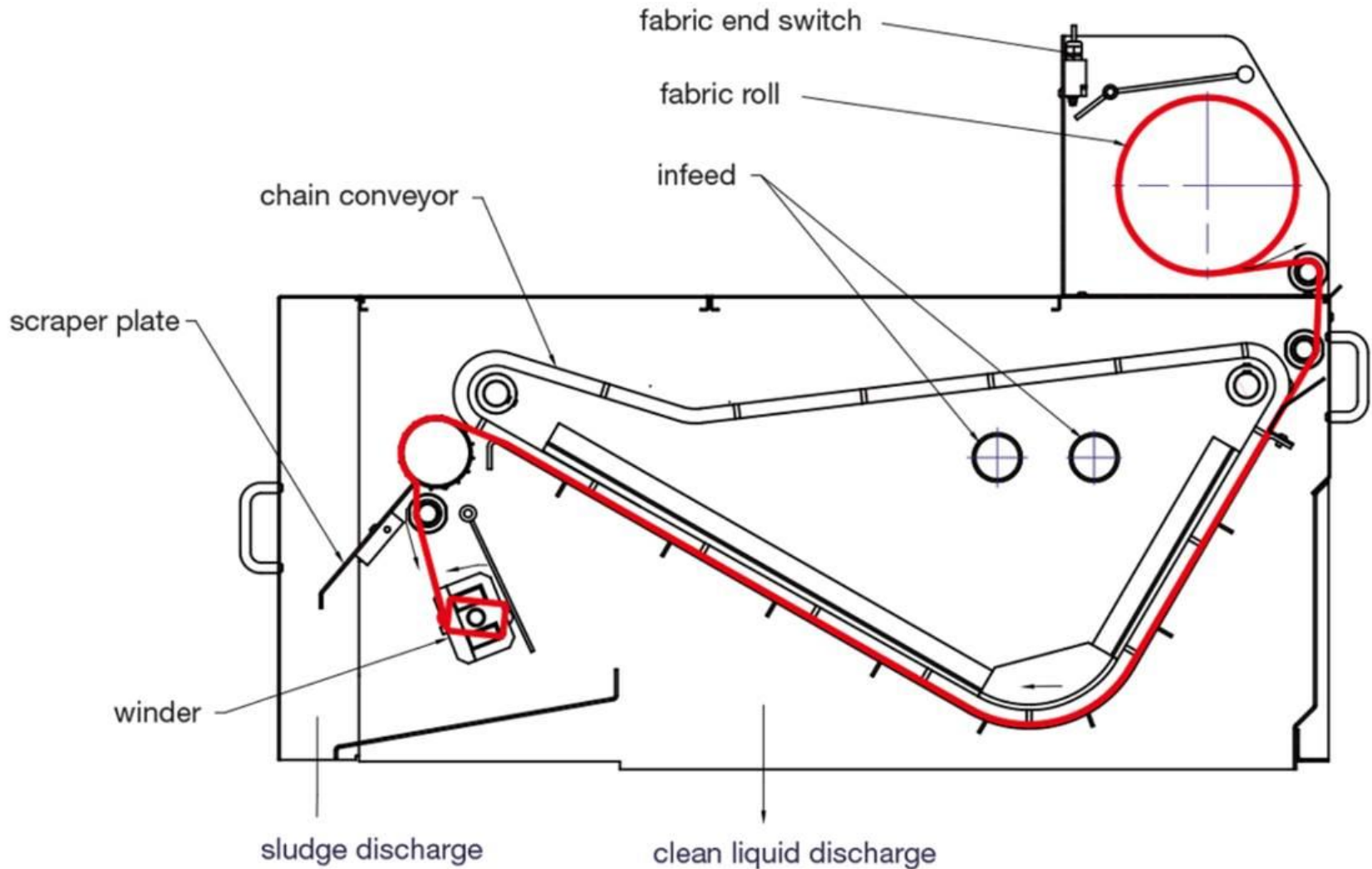

Liqui - The Benefits



- Longer tool life due to fine filtration of all lubricants
- Longer life of coolant lubricant
- High throughput with minimal space requirements
- Optimum utilization of filter
- High purification level due to filter selection and sludge cake build-up
- Economical filtration
- Standard design with fabric winder

The filtration parameters are the viscosity of the filter medium and the quality of the filter band. Purification levels of up to 99% with a grain size limit of 10 µm can be achieved.

E-COS



Liqui - Lay Out

E-COS

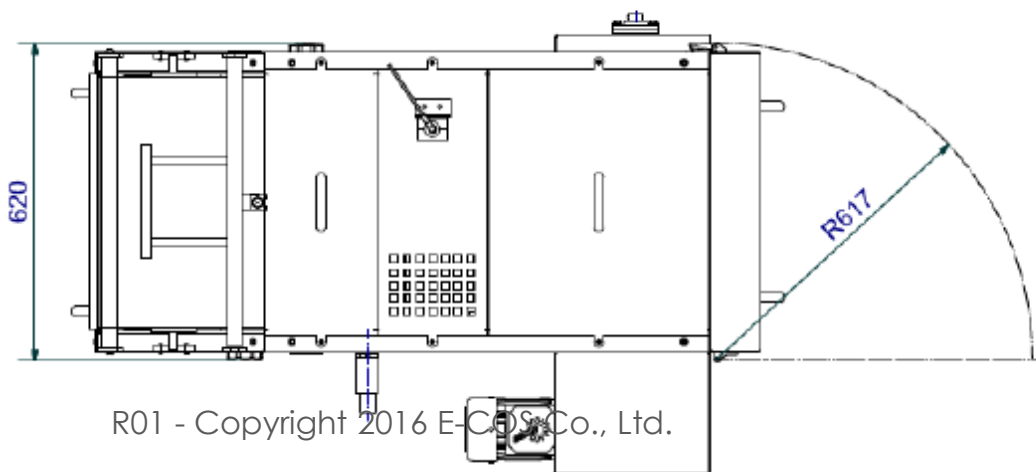
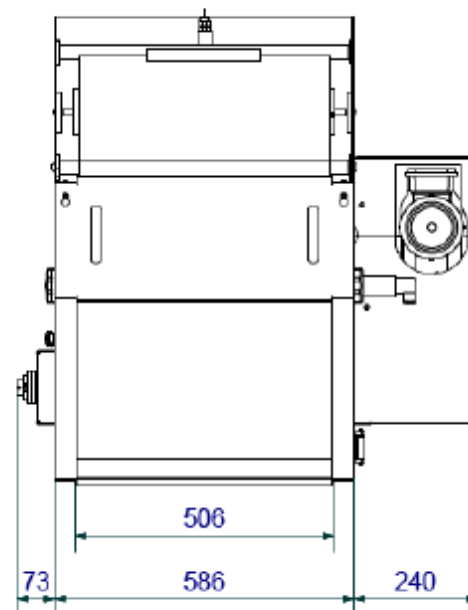
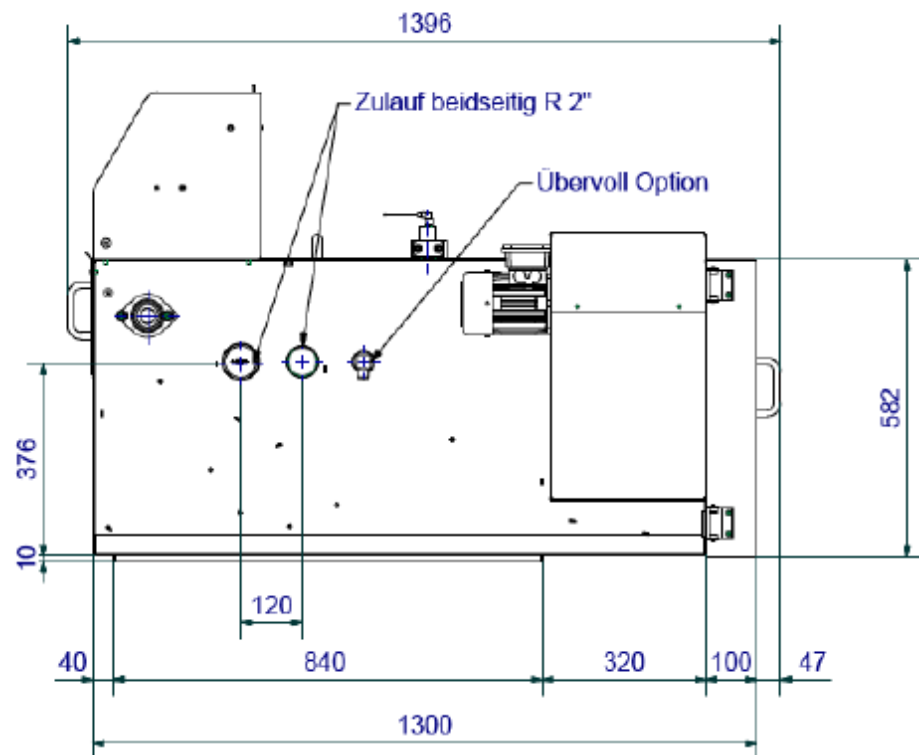

Liqui - Coolant Filtration and Coolant Maintenance System EXAMPLE

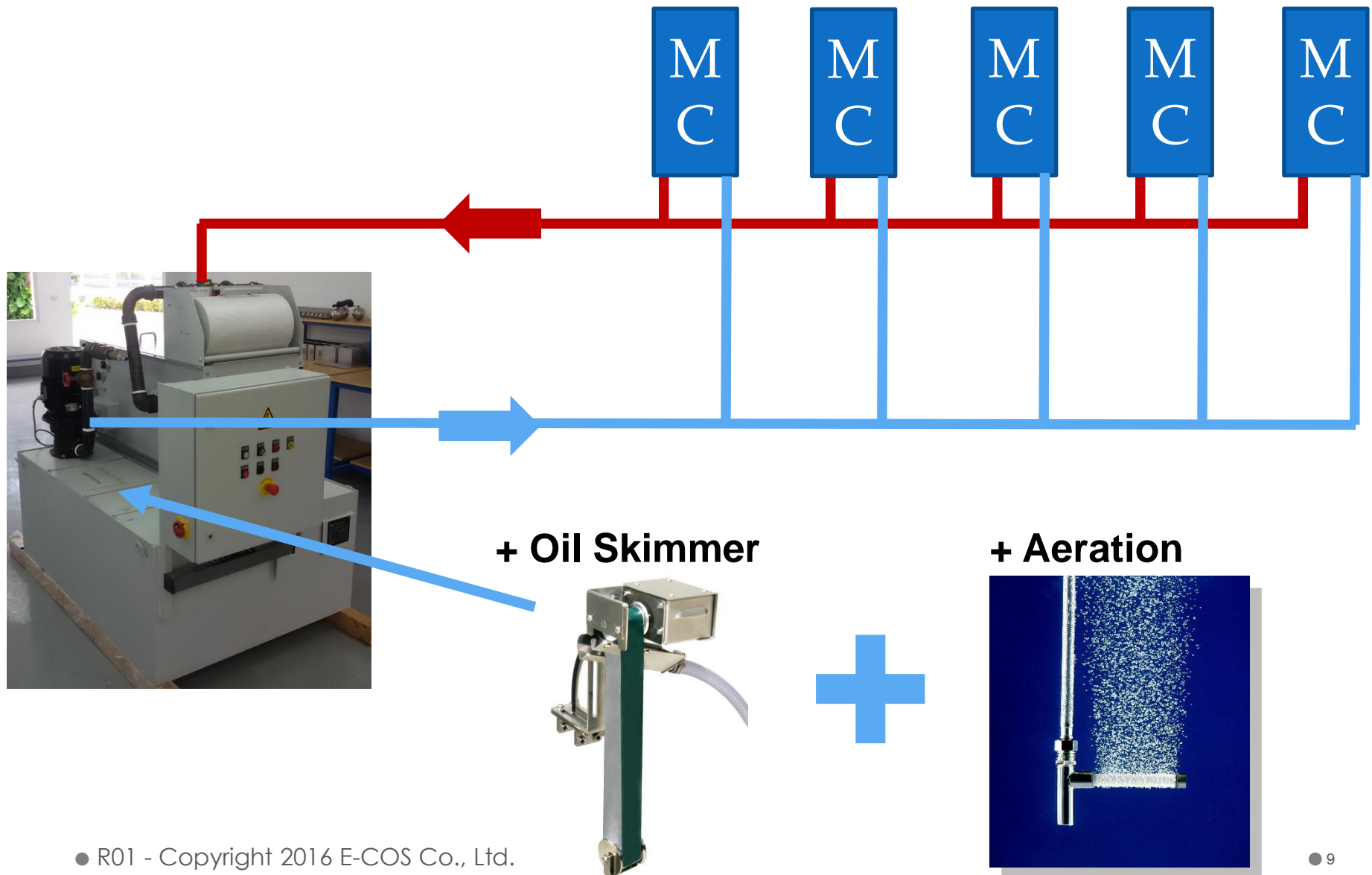

Contact us!

E-COS Co., Ltd.

19 Moo 1

T. Pong, A. Banglamung

Chonburi 20150

Thailand

Tel.: +66 38 227 364

E-mail: info@ecos-machines.com

www.e-costech.com

E-COS

