

QUALITY BORE REPAIR SOLUTIONS

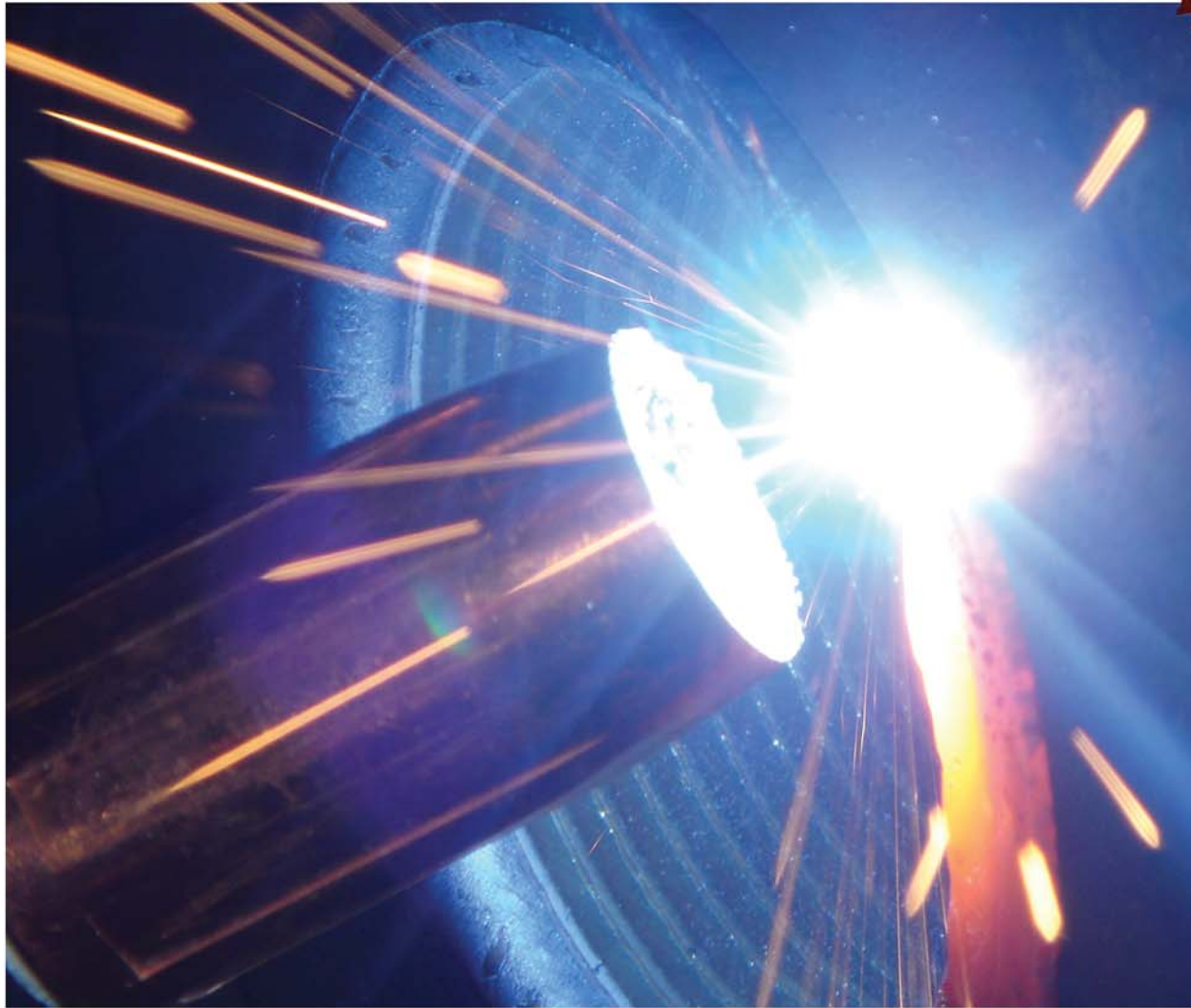

Professional bore welders, boring bars and accessories



Value - Experience - Service - Support

www.borerepair.com - 603-835-2409 int'l - 800-650-1005 USA/CAN

BORE REPAIR MADE EASY



Introducing our elegantly simple, ultra reliable bore welders and boring bars for top quality bore repairs on all types of machinery.

■ The BOA-408i Bore welder

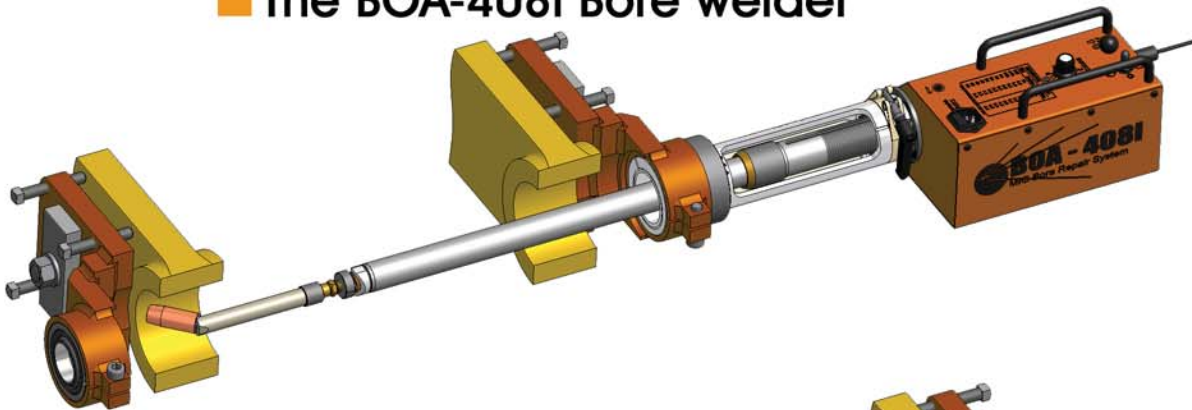

■ The BOA-M1 Bore welder



Bore welder and boring bar are integrated with our center mount system. This gives unparalleled ease of setup and use on all makes, models and types of equipment.

■ The EV Boring bar

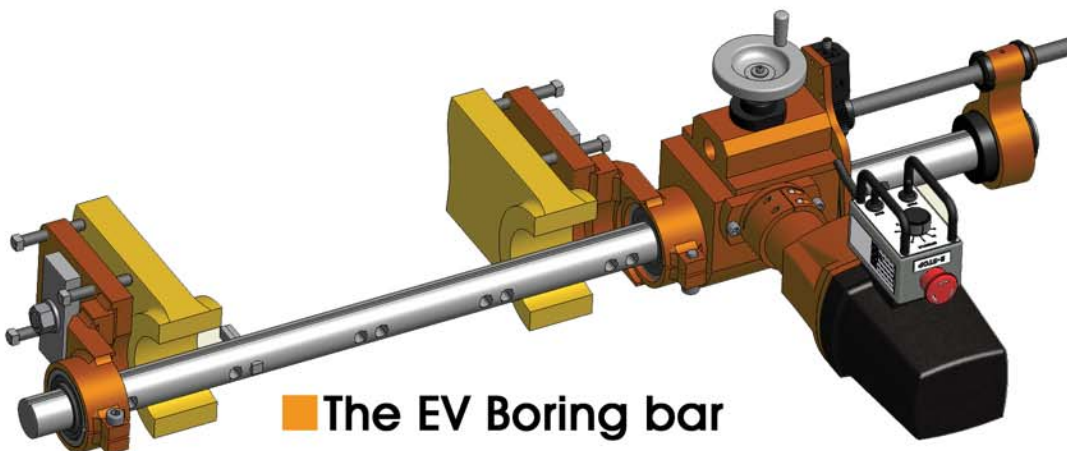

The professional's choice...worldwide.

Value — Experience — Service — Support

www.borerepair.com - 603-835-2409 Int'l - 800-650-1005 USA/CAN

BORE REPAIR MADE EASY



THE BEST OR NOTHING

Bore Repair Systems, Inc. equipment is designed by users, for users. This is why our systems are the only portable bore repair systems that are built with the TOP 10 most valuable features in the industry.

TOP 10 LIST OF MOST VALUABLE FEATURES FOR EASY BORE REPAIR

- #1 - Pass-thru drive design on both bore welder and boring bar - you will not have to re-mount the boring bar or welder drive when working on widely spaced bores on heavy equipment
- #2 - Telescoping and reversible welding gun - no clumsy welding gun extensions are required when welding multiple inline bores
- #3 - Center-mount bore welder to boring bar interface - simply attach your bore welder directly on centerline of boring bar with no centering or realignment needed
- #4 - Mechanical axial feed can never get out of calibration - no chance of weld penetration problems with a BOA
- #5 - Unique standard adjustable welding gun has the largest diameter range range in the industry - no need for multiple welding guns
- #6 - Welding gun nozzles are electrically isolated and will not "arc out" when making contact with bore wall
- #7 - Standard welding guns utilize inexpensive and easy to change thread-on welding tips and nozzles
- #8 - Dual tool ports on boring bars - enables easy, accurate bore diameter measurements and tool adjustments, without having to remove bar or cutter
- #9 - Mechanical feed system on all boring bar drives - fixed or variable feed rates run in direct conjunction with bar rotation providing smoothest possible surface finishes
- #10 - Infinitely adjustable rotation speeds on boring bar drives enable use of wide variety of cutters including carbide, high speed steel and snap-ring cutters

CUSTOMER COMMENTS:

>Rick from Smitty's writes:

"We absolutely love our Bore Repair System. We've been doing lots of ID's and OD's and it just works great!"

>MJ McCarroll writes:

"I would not trade my BOA bore welder for anything, it is that good."

>Turner Diesel writes:

"I am amazed at how great our BOA bore welder works, it's been a real asset to our business."

>Gary from Clark's Repair writes:

"Man I love my Bore Repair System, it just works great."

>Dan A. writes:

(After 5 years of ownership) "I use my BOA bore welder all the time and am considering adding a second machine soon...It has been an excellent addition to my business and always works for me and does a great job."

>Joe L. writes:

"I purchased one of your BRS3 welding/boring systems from you and just wanted to let you know that it is everything you said it was, I am very pleased with it, and thank you."

>Peter M. writes:

"The BRS3 boring and welding system I purchased from you works great. You have a very good product."

- All of us at Bore Repair Systems, Inc. look forward to working with you and helping you with all your bore repair needs.

The professional's choice...worldwide.

Value — Experience — Service — Support

www.borerepair.com - 603-835-2409 Int'l - 800-650-1005 USA/CAN

SETUP OF BORE REPAIR SYSTEM



#1. Center boring bar using centering kit & attach supports



#4. Insert BOA bore welder into support using interface kit

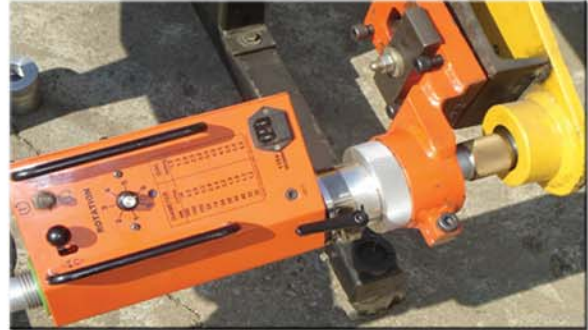

#2. Insert boring bar drive and motor



#5. Attach BOA bore welder to your MIG feeder and apply weld

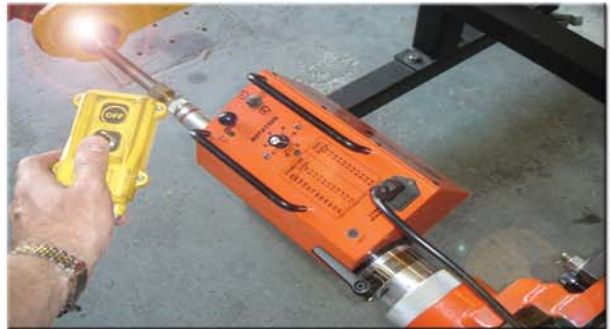

#3. Machine the bore to clean and prepare for welding



#6. Slide boring bar back through supports and machine bore to size



Time is money and our integrated BRS systems saves you both. Cut welding time by 80% and machining time by 50% by using reliable, affordable Bore Repair Systems' integrated bore welder and boring bar systems.

The professional's choice...worldwide.

Value — Experience — Service — Support

www.borerepair.com - 603-835-2409 Int'l - 800-650-1005 USA/CAN

Standard Boring Bar Setup

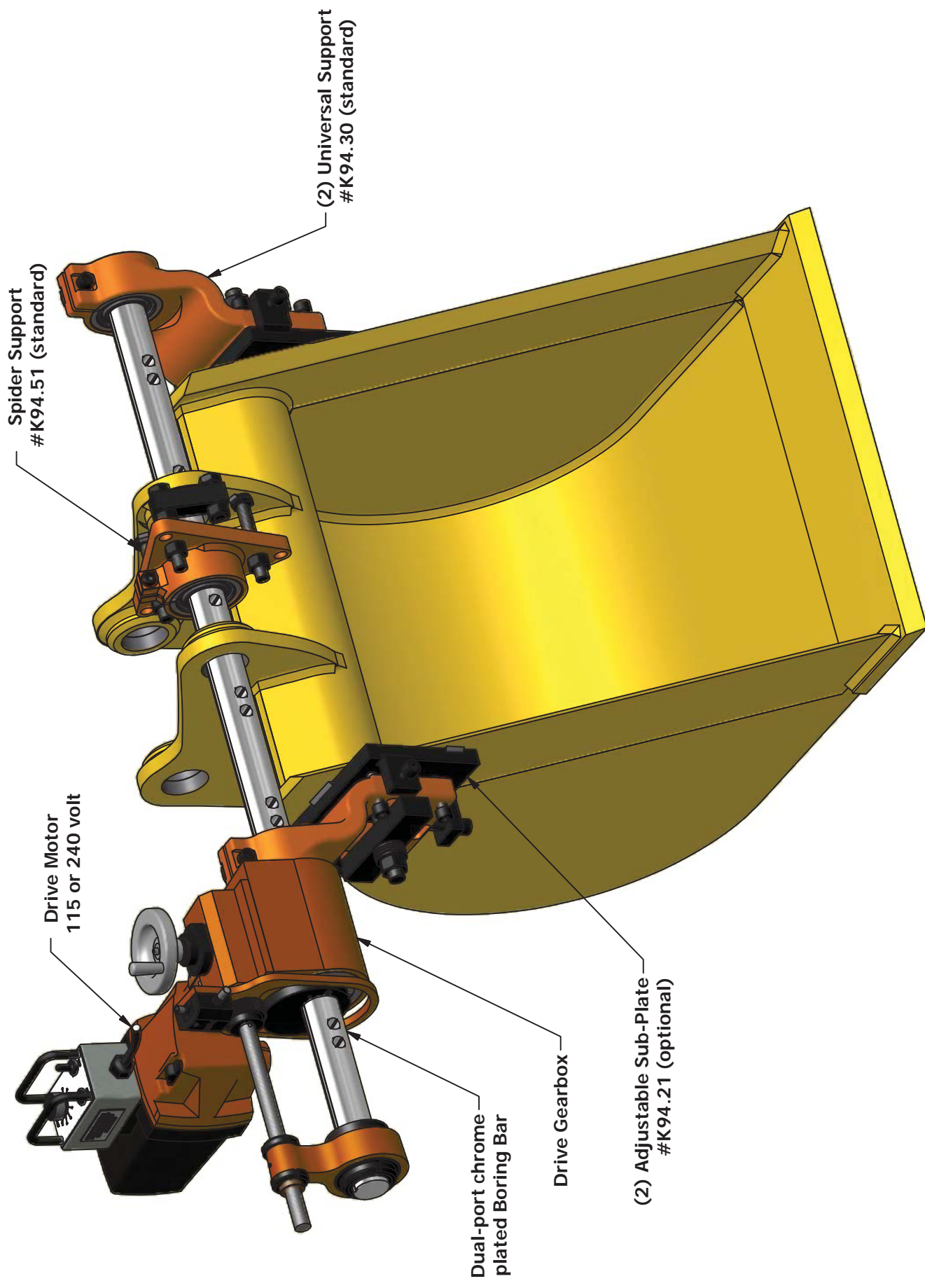

Inverted Boring Bar Setup

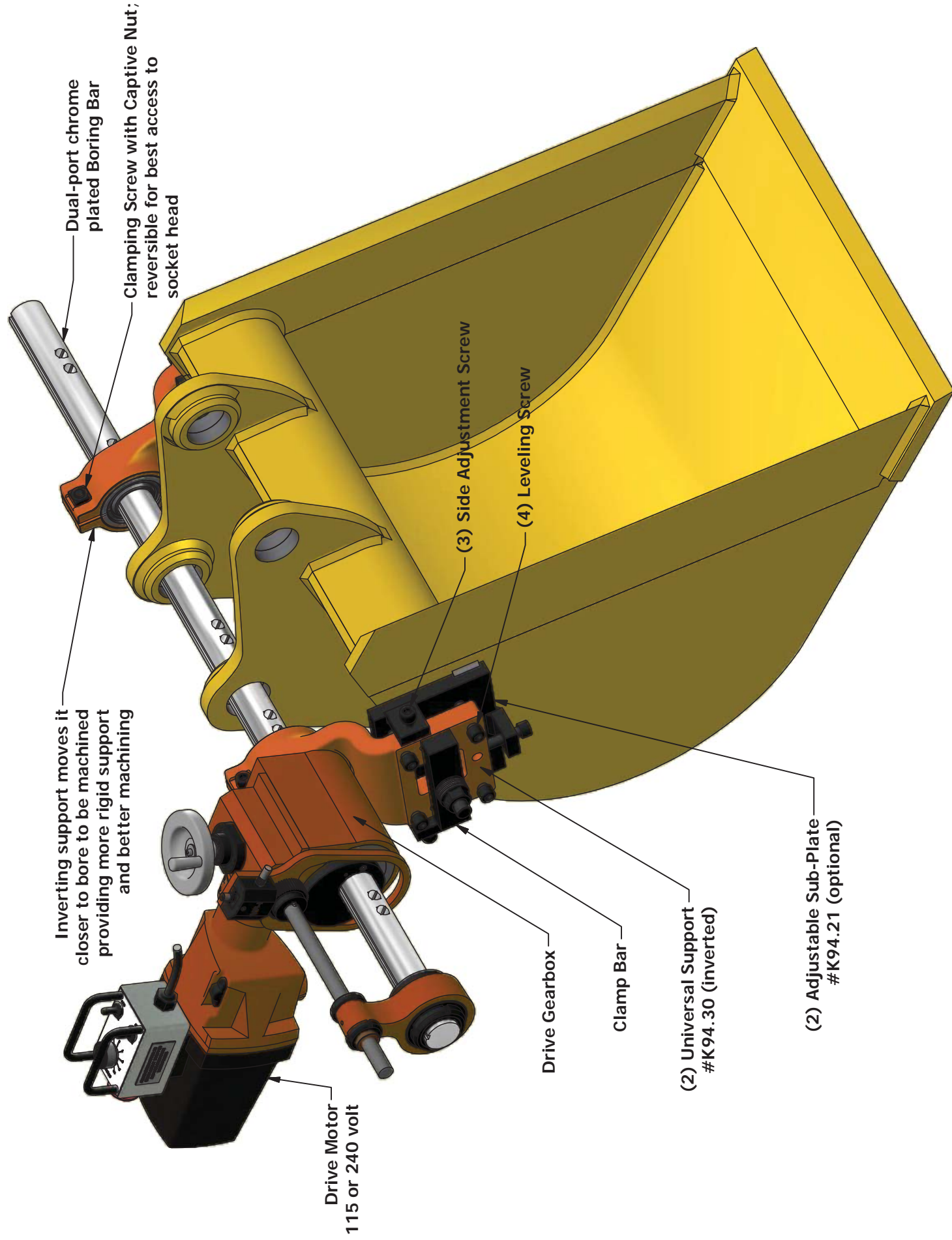

Bore Welder Center Support

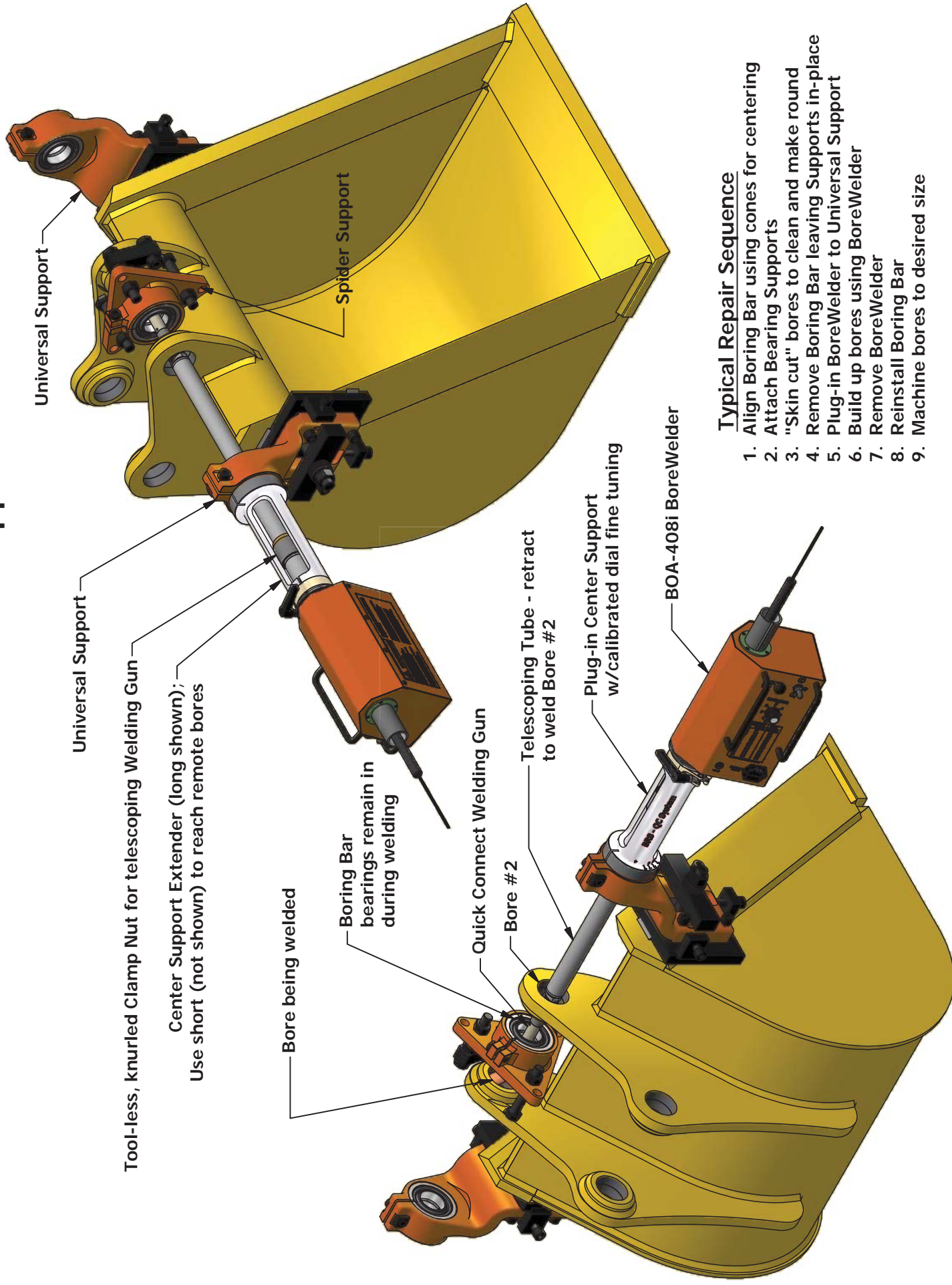

Typical Repair Sequence

1. Align Boring Bar using cones for centering
2. Attach Bearing Supports
3. "Skin cut" bores to clean and make round
4. Remove Boring Bar leaving Supports in-place
5. Plug-in BoreWelder to Universal Support
6. Build up bores using BoreWelder
7. Remove BoreWelder
8. Reinstall Boring Bar
9. Machine bores to desired size

BarDrill Setup

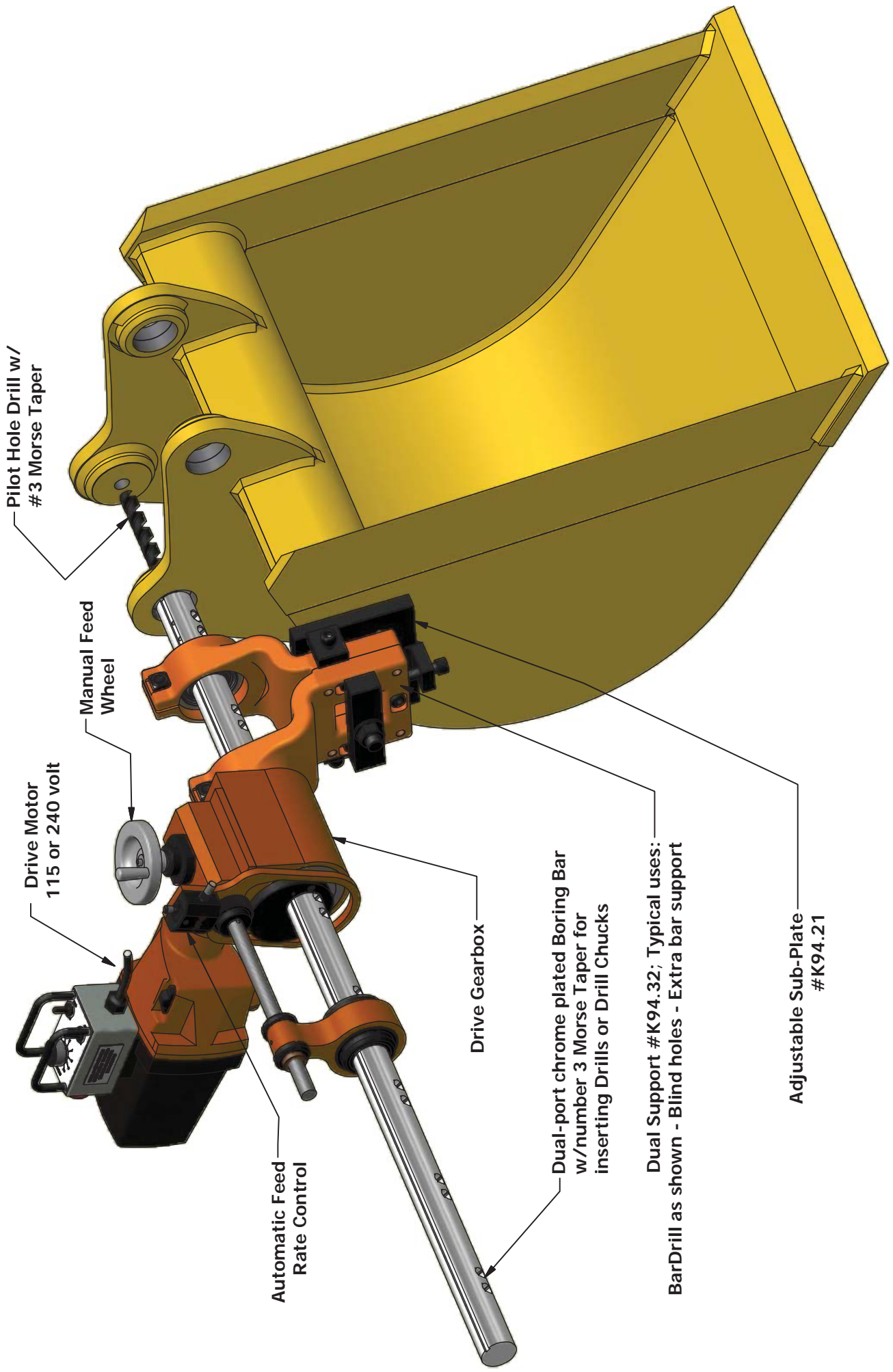

Pilot Hole Drill w/
#3 Morse Taper

Manual Feed
Wheel

Drive Motor
115 or 240 volt

Automatic Feed
Rate Control

Drive Gearbox

Dual-port chrome plated Boring Bar
w/number 3 Morse Taper for
inserting Drills or Drill Chucks

Dual Support #K94.32; Typical uses:
BarDrill as shown - Blind holes - Extra bar support

Adjustable Sub-Plate
#K94.21

Universal Support Kits K94.30 & K94.32 Mount Configurations

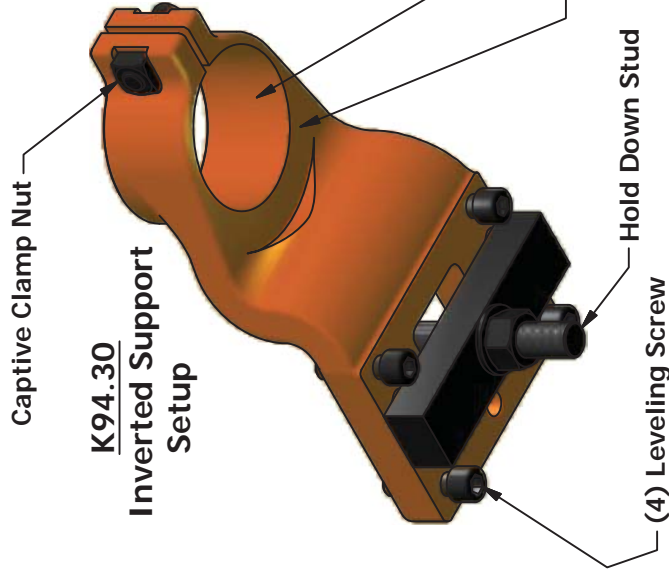
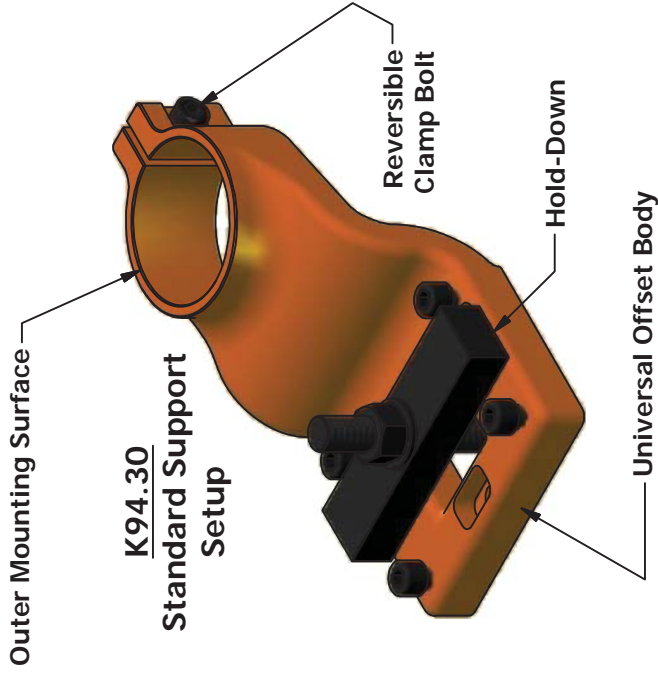

TYPICAL USES/FEATURES

- Standard Single Support
- Most outboard locations where bore is near mounting surface
- Mount drive on either Outer or Inner Mounting Surface
- Supports Spherical Bearing

Inverted Single Support

- Use when bore is inboard from mounting surface
- Mount drive on either Outer or Inner Mounting Surface
- Supports Spherical Bearing

Double Support

- Use when extra bar stiffness is needed, such as blind holes or bores located far from support
- Can be used as a drill press with special Morse Taper Bar
- Mount drive or bearing at either clamping location

Reversible Clamp and Joining Bolts

- Allows access to bolt head from either side
- Clamp Nut captive on either side so second wrench not needed

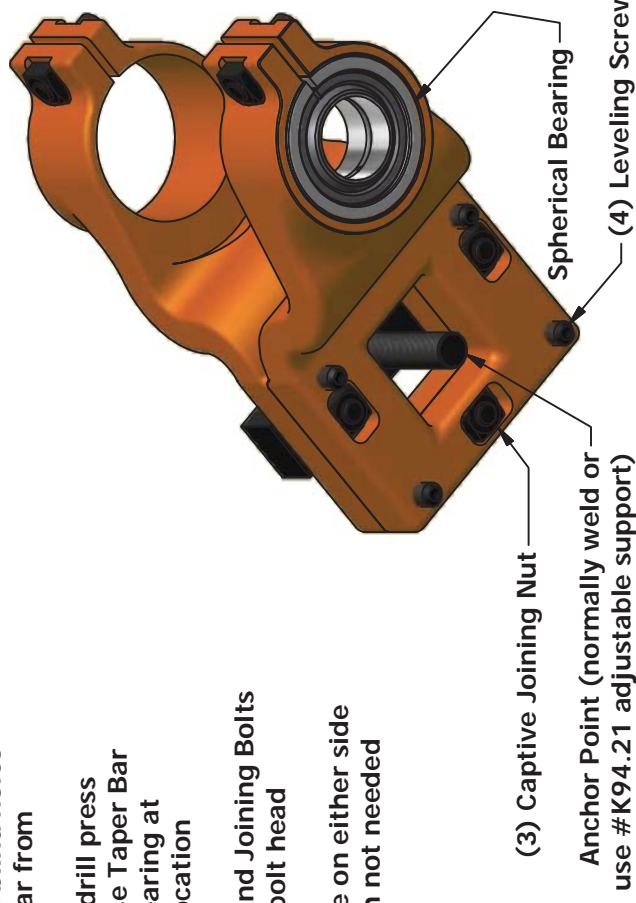
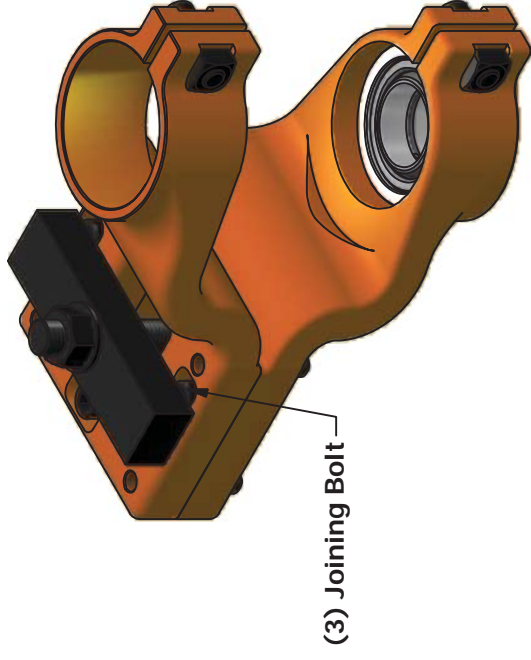

Spider Support K94.51 Mount Configurations

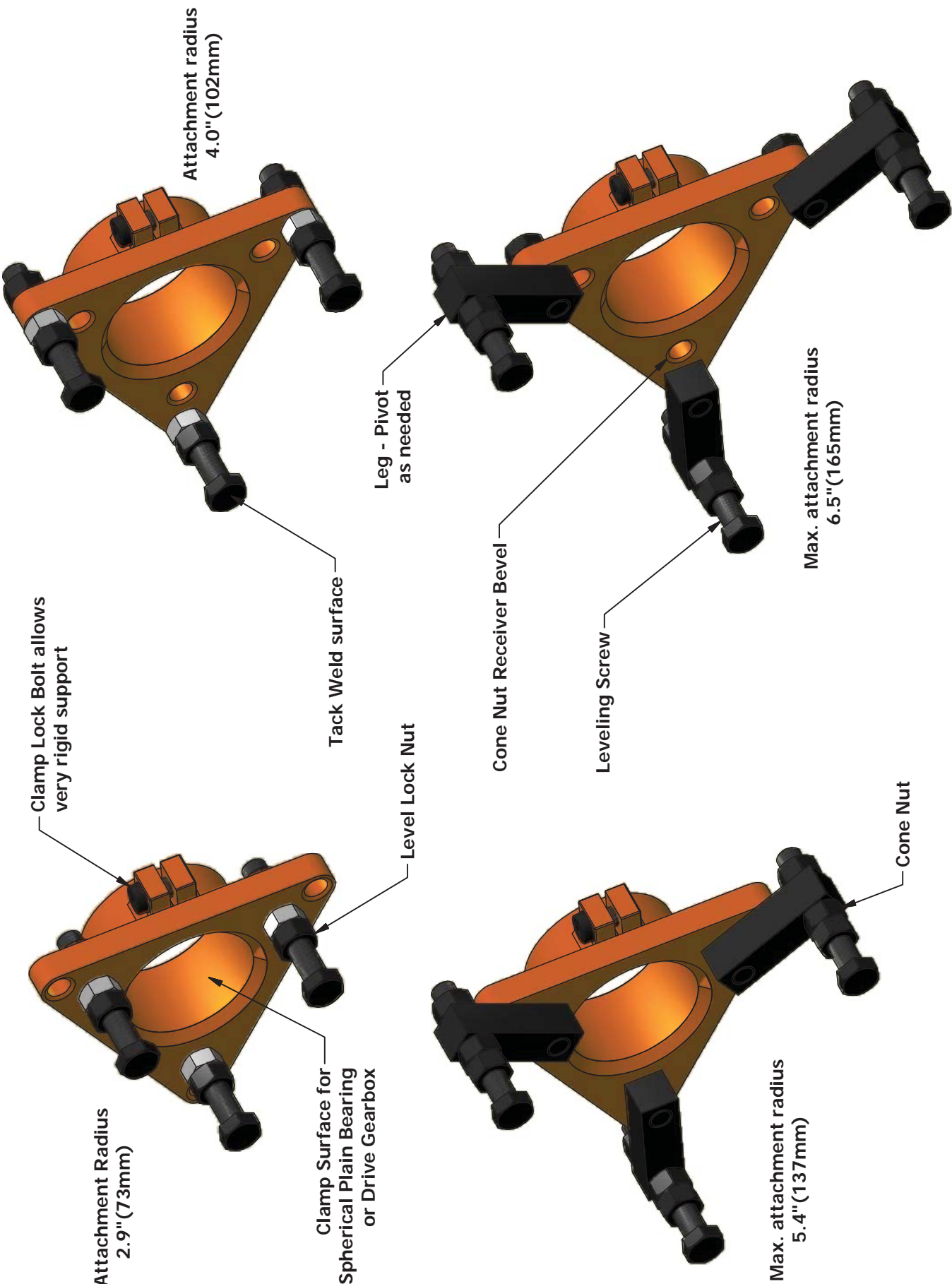

BOA-408i series Automatic Bore Welding System

(popular choice for most heavy equipment bore repair jobs)



The BOA-408i automatic bore welding system is designed for users who demand durability, ease of setup and precision without unnecessary complication.

Coupled with one of Bore Repair Systems' boring bars and new Center Support System, it will provide you with a means of repairing worn bores on all types of equipment in the fastest, most efficient way possible. Awarded numerous design patents, owners of our BOA systems quickly realize they made the right decision when choosing Bore Repair Systems' products. The BOA systems are the simplest to set up, the simplest to use and offer the highest levels of precision all at very reasonable prices.

The BOA-408i is conveniently offered in 5 packages, ranging from the basic BOA-408i S1 for internal bore buildup to the fully loaded BOA-408i S5 which features all the upgrades available including long stroke, auto-skip, face welding, outside diameter welding and even a BOA-M1 compact bore weld drive head and gun assembly.

The BOA-408i bore welder system is also offered in complete, turnkey kit form with integrated boring bar system. See our BRS2-BRS7 integrated bore welding and machining systems.

Already own a boring bar system but need to automate your bore welding process? The BOA-408i is for you too. Any BOA-408i system is available with boring bar interface kits to fit any brand boring bar system that you may now own.

Bore Repair Systems, Inc. offers many convenient purchase plans including rent-to-own and lease finance options. Contact us today at 603-835-2409 or visit our website at www.borerepair.com.



BOA-M1 Bore Welding System

(our most compact and affordable bore welding system)



The BOA-M1 basic bore welding system is Bore Repair Systems' most compact and affordable bore welder. The welder drive and spindle assembly will fit nearly anywhere at just under 280mm (11.0") long.

The BOA-M1 basic package is extremely versatile. With standard components, it can reach bores nearly 610mm (24") away from its' mount location, or bores over 1.2m (48") apart from one another when mounted between bores.

The BOA-M1 design is elegantly simple and extremely durable, very easy to set up and operate. It utilizes the same gun and conduit system as the BOA-408i so parts are interchangeable.

While the BOA-M1 bore welding system is a popular choice with our existing BOA-408i and BOA-550HD customers who are interested in a second bore welder that can fit in tight, restricted access bore repair jobs, it is also very popular with our new customers who are just starting out who need a bore welder that will give top quality professional results at the lowest possible entry price.

The BOA-M1 comes complete with a hand feed wheel and rotation speed timer with chart. This ensures smooth, even weld bead application every time. The BOA-M1 can also be easily driven automatically with a basic hand drill or for maximum versatility you can add our automatic stepper drive kit.

Please call us today at 603-835-2409 or visit our website at www.borerepair.com. Several purchase and leasing options are available.

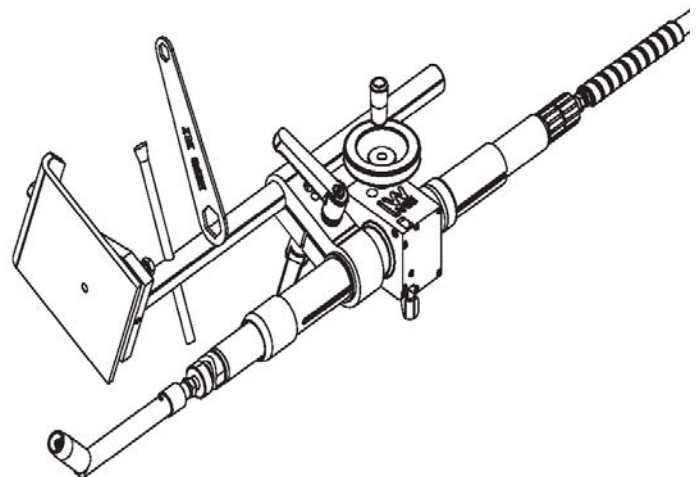

MICRO GUN (for 308i) - A138
MICRO GUN (for 408i & M1) - A336
 Diameter range: .8 to 2" (20 to 51mm)

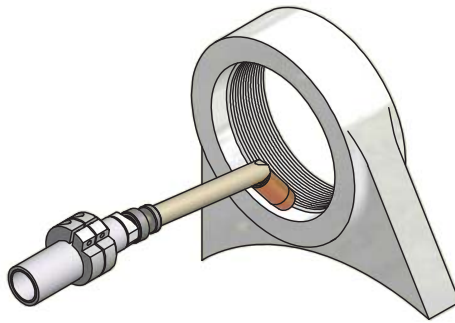

STANDARD GUN (for 308i) - A113
STANDARD GUN (for 408i & M1) - A313
SHORT GUN (for 408i & M1) - A328

Standard Guns Diameter range: 1.25 to 8" (32 to 203mm)
 Short Gun Diameter Range: 1.25 to 4" (32 to 101mm)
 Short Gun 3" (76mm) shorter than standard for use in tight locations.

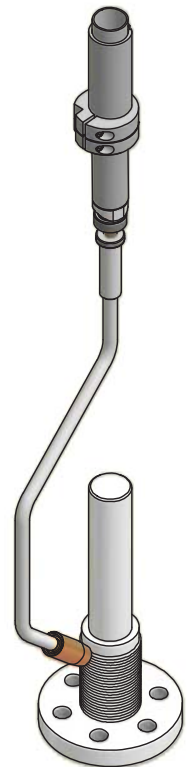

OD GUN (for 308i) A114
OD GUN (for 408i & M1) A317

Diameter range: 1 to 12" (25 to 305mm)
 Custom sizes available

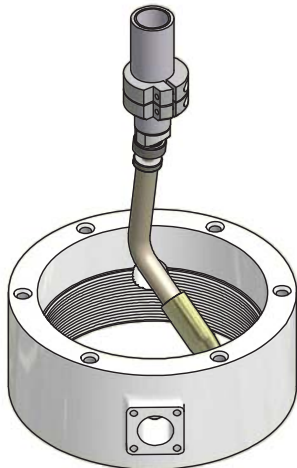

HI-AMP GUN (for 308i) A135

HI-AMP GUN (for 408i, M1 & L34) A344

Minimum Diameter - 4" (101mm)

FEATURES OF ALL OF OUR GUNS:

- Quick install on BOA-308i, 408i, 450HD, M1 & L34 Bore Welders
- High electrical & thermal conductivity to help maintain an efficient and safe operating temperature
- Lightweight aluminum construction
- Weld in any position
- Covered by several USA Patents
- Electrical isolation of nozzles and use of standard tips for all bores larger than 1.2" (30mm)

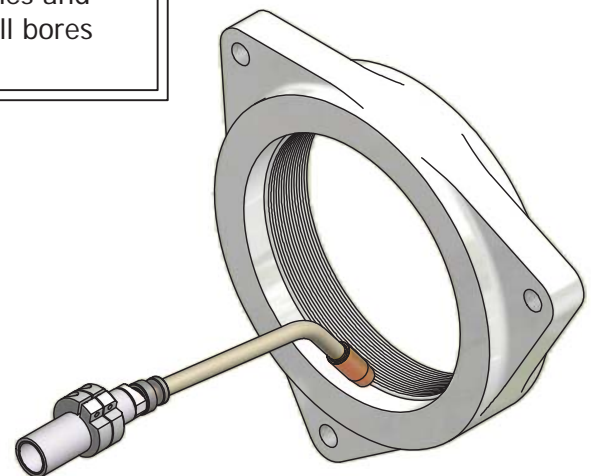

LARGE DIAMETER GUN (for 308i) A115

LARGE DIAMETER GUN (for 408i & M1) A310

Diameter range: 8 to 15" (200 to 380mm)
 Diameter range with extenders: to 48" (1220mm)

HAND-HELD GUN (for 408i & M1) A333

Easily connects to Bore Welder conduit, eliminating the need to carry an extra gun and conduit.



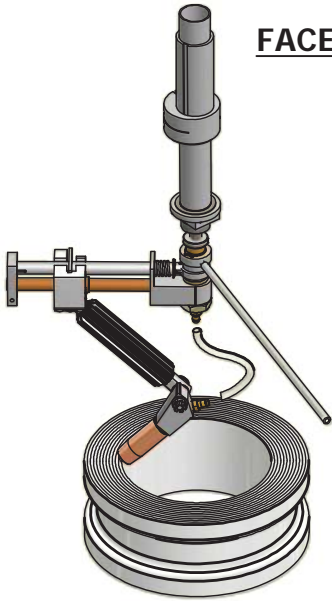

FACE GUN - K13.10

FEATURES:

- Lightweight
- Adjusts easily to the desired welding position
- Weld either inward or outward
- Weld faces up to 24" diameter
- Quick install on 308i, 408i & M1
- High electrical and thermal conductivity to maintain a low operating temperature
- Covered by USA Patent No. 6,486,438 et al

FEATURES:

- Aluminum tube construction makes the torch extremely rigid and durable yet lightweight
- Can weld both ID's and OD's (48" maximum)
- Quick install on 308i, 408i & M1
- High electrical and thermal conductivity to maintain a low operating temperature

BEAM GUN - K13.11



GUN DIAMETER EXTENSIONS K13.12



FEATURES:

- Comes with 2 extensions
- Each extension adds 5" (127mm) to the maximum diameter capability of the gun
- Gun liner removal not required
- Use with Large Diameter Gun

GUN REACH EXTENSIONS

A309 [6" (152mm)]
A335 [10" (254mm)]

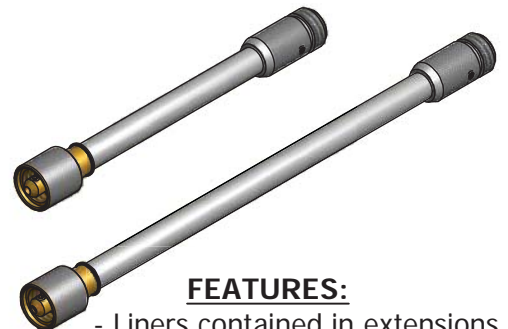

FEATURES:

- Liners contained in extensions
- Can be used with all guns on 408i and M1 machines
- Quick connection and angular orientation with captive nuts
- Constructed with light, highly conductive aluminum with brass fittings

BORE WELDER SUPPORT OPTIONS

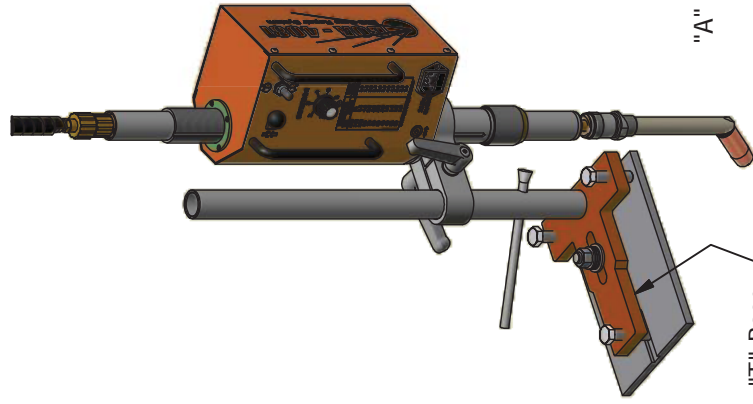

BOA-M1 - Hand Powered Version

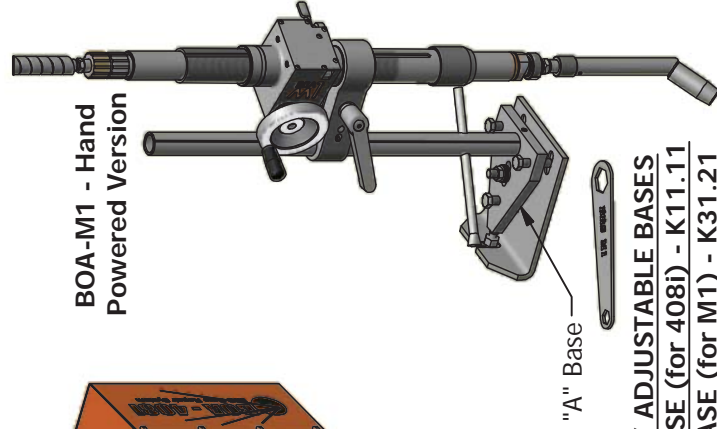

"A" Base

FULLY ADJUSTABLE BASES

"T" BASE (for 408i) - K11.11

"A" BASE (for M1) - K31.21

Allows full adjustment to bore:

- Leveling
- Centering

Also repeatable angular positioning

UNIVERSAL HEX MOUNT for BOA-M1 - K31.10

- Compact and easy to use
- Can be aligned directly from boring bars



BOA-M1 - Powered Version

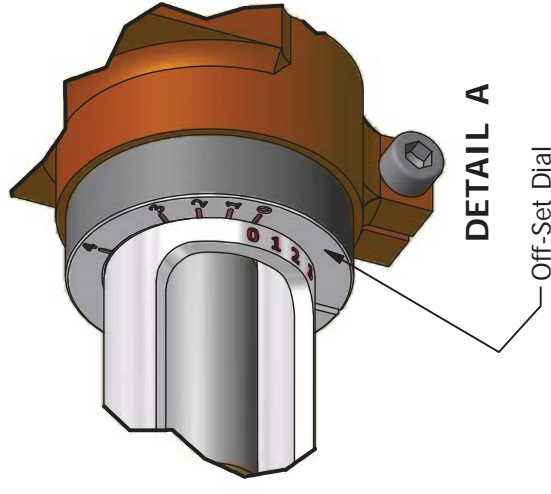

DETAIL A

Off-Set Dial

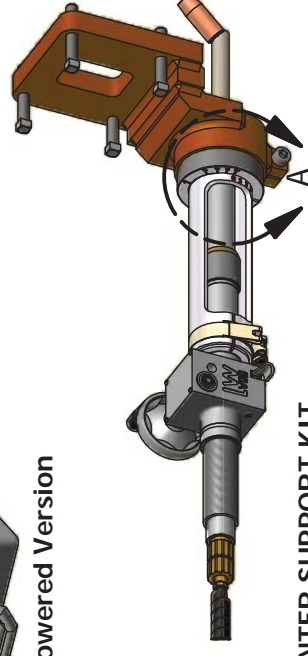

QUICK CONNECT CENTER SUPPORT KIT

for BOA-408i - K11.21 | for BOA-M1 - K31.11

- Set-up quickly with no guesswork
- Centers directly from boring bar bearing mounts
- Adjustments made directly using off-set dial

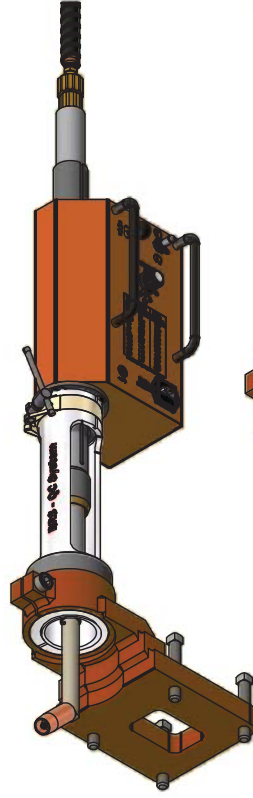

Quick Connect Center Support Kit - Exploded View



THE BOA-C45 SERIES PORTABLE LINE BORING SYSTEM

Electric BOA-C45 boring system shown.



The Bore Repair Systems, Inc. BOA-C45 portable line boring systems are simple to use in the field and shop, rugged and extremely accurate. From the C45 precision hardened and chromed boring bars with staggered dual tool ports and morse taper end to the unique external ratcheting, variable rate cam feed, tuneable ID bar support bearings and standard cone tightening system, the BOA-C45 line boring system will provide you with the features needed to quickly and accurately repair worn bores from under 1" to over 10" diameter on all types of equipment in a variety of industries. And while the BOA-C45 series line boring system features a powerful 3.3hp reversible, variable speed motor, the standard bar drive is a compact 15" wide* including the feed screw. The C45 system also features the popular pass-through drive design allowing placement between bores, in tight-access spots, or to be used on tricky "blind bore" jobs or jobs where there are multiple bores in a line. The unique, dis-engagable feed arm allows simple tool repositioning without removing the tool from the bar....a feature not possible with old-fashioned traditional end-drive boring systems. Add one of Bore Repair's automatic bore welding systems for maximum efficiency and productivity on all your bore repair jobs.

BOA-C45 boring system includes the following standard equipment:

- 3.3Hp reversible, adjustable drive motor (120v or 240v)
- 1.75" x 72" long chrome, dual-tool ported boring bar
- (2) one-arm adjustable boring bar / boring bar gearbox / bore welder drive supports including (2) bearing inserts
- (1) compact boring bar / boring bar gearbox / bore weld drive support
- Sharpened cobalt/HSS cutting bit (1/2") for ID and faces
- Quick-change feed screw
- Mounting plate kit for use with one-arm supports
- Star-drive motor to gearbox interface
- Pass-through, reversible, variable axial feed boring bar drive gearbox
- Centering cone package with tightener kit
- Extended range boring head
- Diamond plate carry/storage case
- Tool kit including allen wrench set and nut driver
- Protective sleeve with thread-off ends for boring bar
- Metric/Imperial scale
- Setup manual in print and DVD
- One-year warranty
- Upgrade from electric to hydraulic drive any time

BOA-C45 boring system optional accessories:

- BOA-408i and BOA-M1 integrated bore welding kit
- Large range bore head (for cutting to 356mm (14") bores
- Small bore kit (for cutting down to 35mm (1.4") bores
- Micro bore kit (for cutting down to 25mm (1") bores
- Internal automatic snap-ring groove cutting system
- Automatic, low-profile face-machining kit
- Manual compact "plunge" face-machining kit
- Internal through-bar bore measuring gage kit
- Precision bar-mounted tool bit adjusting kit
- Bar coupler kit for joining two bars for long-span work
- Various length feed screws with quick change feature allowing un-interrupted long-span cutting and easy setup in tight spaces
- Free factory training classes available on all products

MADE IN THE U.S.A.

BB6 PORTABLE LINE BORING SYSTEM

BB6 Boring Bar System



The Bore Repair Systems, Inc. model BB6 portable line boring system is simple to use, rugged and extremely accurate. From its precision hardened and chromed boring bars with dual tool ports to the adjustable, remote-mountable mechanical feed gearbox, tunable ID bar support bearings and standard cone tightening system, the BB6 line boring system will provide you with the tools needed to repair worn bores from under 1.4" to over 18" diameter on all types of equipment with ease and precision. And while the BB series line boring system features a powerful 3.3hp reversible, variable speed motor, the bar drive is a compact 12" wide. The BB6 system also features the popular pass-through drive design allowing placement between bores, or to be used on tricky "blind bore" jobs or on jobs where there are multiple bores in a line, the feed arm allows simple tool repositioning without removing the tool from the bar....a feature not possible with traditional end-drive boring systems. Add one of Bore Repair's automatic bore welding systems for maximum efficiency and productivity on all your bore repair jobs.

Model: BB6

Bore machining package—for machining bores from 1.4" to 18"
(Order #K09.15) Package (shown in photo above) includes:

- 3.3Hp reversible, adjustable drive motor (120v or 240v)
- Pass-through, remote mount adjustable feed gearbox
- (3) boring bar / boring bar drive supports
- Setup sleeve for support alignment
- Sharpened cobalt/HSS cutting bits (1/2" and 3/8")
- (2) bar kit, 6' x 1.75" and 1.25" diameter with reducers
- Pass-through, reversible boring bar drive gearbox
- Centering cone package with tightener clamp
- (6) Extended range boring heads
- Necessary wrenches
- Diamond plate carry/storage cases
- Adjustable feed travel stop arm

TIP: Don't need to machine any bores smaller than 2.5"? Bore Repair Systems, Inc. also offers the BB6 Boring system is also available without the small (1.25") bar package.

Popular accessories to further enhance your BB6 line boring system include: # 9260 face machining head, #K94.21 adjustable base plate kit, #K92.10 ID bore measure kit and #K93.26 digital tool bit adjuster kit and bore welding package.

BORE MEASURING KIT

K92.10

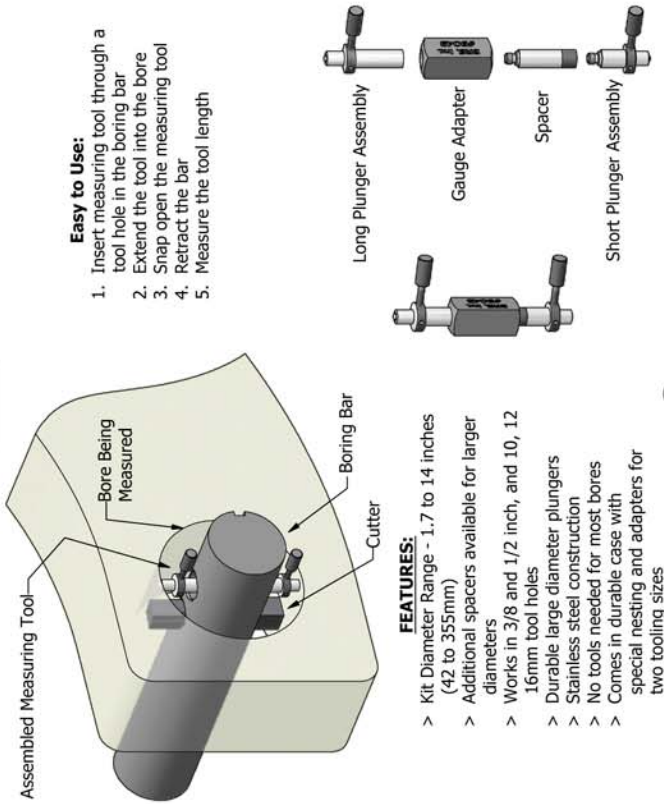

TIGHT BORE MEASURING KIT

K92.20

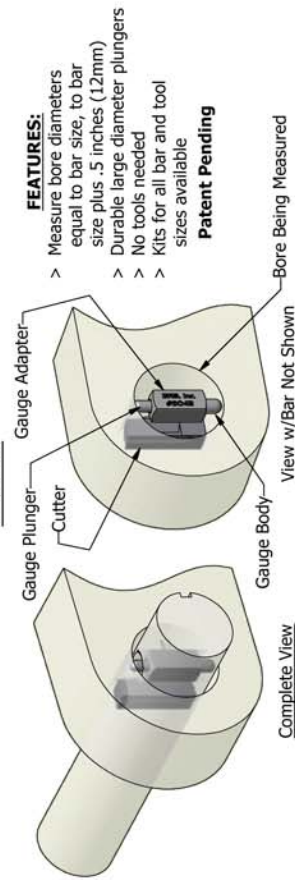

CARBIDE TOOLING KIT

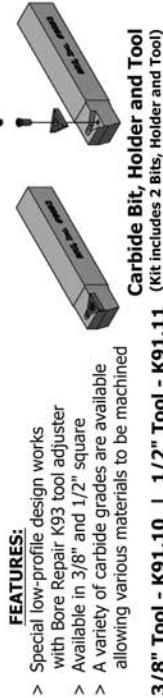

3/8" Tool - K91.10 | 1/2" Tool - K91.11 (Kit includes 2 Bits, Holder and Tool)

MULTI-FUNCTION TOOL ADJUSTER

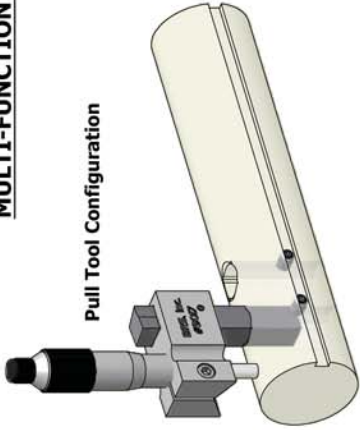

Available for the following

Tooling Sizes:

1. 1/4" square > K93.10 (Body Only #A903)
2. 3/8" square > K93.11 (Body Only #A904)
3. 1/2" square > K93.12 (Body Only #A905)
4. 10mm square > K93.13 (Body Only #A906)
5. 12mm square > K93.14 (Body Only #A907)
6. 16mm round > K93.15 (Body Only #A908)
7. 3/8" & 1/2" sq > K93.16

All kits include a Tool Adjuster Body, a Barrel Micrometer, a Multi-Function Tool Adjuster Support, and a Carrying Case and Tools

FEATURES:

- > Accurate tool depth adjustment
- > Allows tool removal and replacement to the same cutting depth
- > Allows either pull or push adjustment for both dual and single tool hole bars
- > Clamp to tool or Support from either side
- > Machined "V" provides accurate alignment for single tool hole bars

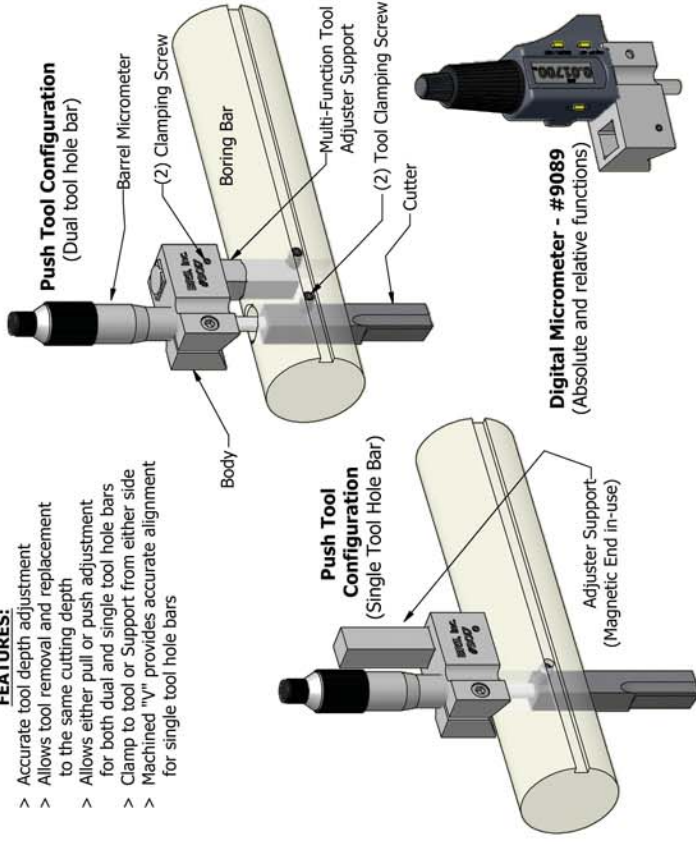

PRE-SHARPENED HIGH-SPEED STEEL BITS

FEATURES

- > Wide cutting edge allows both ID and spot facing for easy face touch-up
- > Design of the grind offers easy sharpening using a standard bench grinder
- > Special grind for longer edge life and cleaner cut

3/8" Square Bit - #9088 | 1/2" Square Bit - #9087

BORE REPAIR SYSTEMS, INC.
www.borerepair.com
(800)650-1005
(603)835-2409

BORING BAR SUPPORT KIT

(K94.20)*

KIT INCLUDES:

(2) A910 Drive Support
& Spherical Support
Adjuster Plate Assemblies

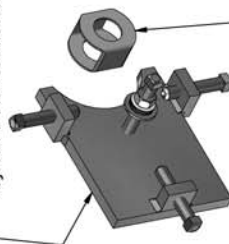

(1) 9194 Alignment
Sleeve

- Set-Up Steps:**
1. Tack weld or clamp the Adjuster Plate Assemblies adjacent to the bores to be repaired. (The plates should be approximately perpendicular to the bore axis, and with the clamping bolt 5" from the bore centerline.)
 2. Attach the Drive Support as shown, and the Spherical Support (not shown) to the Adjuster Plate.
 3. Adjust as necessary using the "jack" bolts to achieve the desired bore alignment.
 4. Insert the Alignment Sleeve into the Drive Support as shown.
 5. Slide the Boring Bar through the Alignment Sleeve and the Spherical Support.
 6. Tighten the Strap Clamp.

Kit Assembled on Drive-End

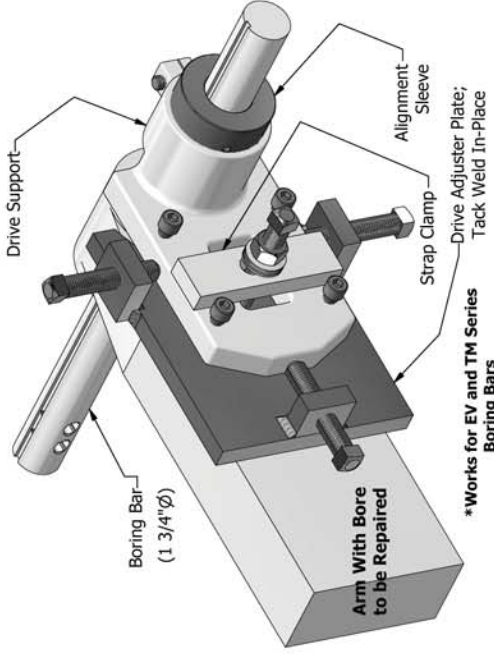

*Works for EV and TM Series
Boring Bars

BORING BAR ALIGNMENT KIT

Set-Up Step #1:

1. Assemble 2 sets of Rings, Standoffs, and Screws as shown.

2. With the Rings on the Boring Bar, tack weld Standoffs to the Bore Faces so that the Rings are approximately centered.

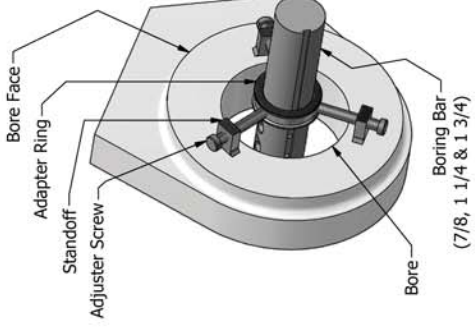

FEATURES

- Low Profile
- Easy Alignment to Other Bores
- Allows Precision Alignment
- Great for Alignment to Out-of-Round Bores

Set-Up Step #2:

1. Retract the Adjuster Screws from the Threaded Holes in the Adapter Ring and rotate the Adapter Ring until the Adjuster Screws are no longer aligned with the Threaded Holes.

2. Align the Boring Bar as required using the Adjuster Screws. (If the Bore is round, it is sometimes helpful to insert a Cutting Tool and measure the distance from the Cutting Tool to the Bore in order to assure proper alignment.)

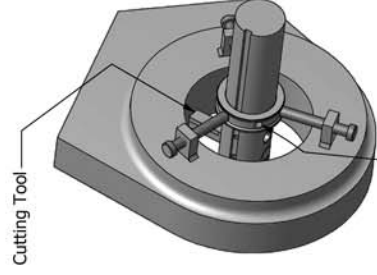

FOR THE FOLLOWING SIZE BARS

1 1/4" Bars	1 3/8" to 5 1/2" Bores	K94.10
1 3/4" Bars	1 7/8" to 10" Bores	K94.11
1 1/4" & 1 3/4"	1" to 10" Bores	K94.12
2.0" Bars	2 1/8" to 10" Bores	K94.13
2 1/4" Bars	2 3/8" to 10" Bores	K94.14

ID GROOVE CUTTER



FEATURES

- Cutter fits in 1/2" tool holes in boring bars
- High speed steel cutting bits
- Cuts grooves in bores from 2.5" to 6" (64 to 152mm)
- Very compact - can be used in confined spaces

FOR THE FOLLOWING

BAR SIZES

1 1/2" Bars	K96.10
1 3/4" Bars	K96.11
2" Bars	K96.12
2 1/4" Bars	K96.13

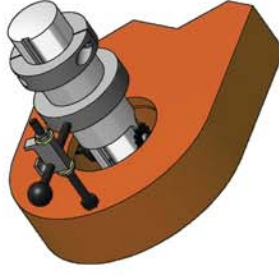

BORE REPAIR SYSTEMS, INC.

web: borerepair.com

(800)650-1005 & (603)835-2409

BOA-408i Bore welder packages

Equipment list 8/2017

BOA-408i S5 Auto BoreWelder	BOA-408i S4 Auto BoreWelder	BOA-408i S3 Auto BoreWelder
Standard Capabilities: I.D. Weld range: 20mm-1.2m (.8-48") O.D. Weld range: 20mm-1.02m (.8-40") Face Welding: 20-610mm (.8-24") diameter Stroke: 318mm (12.5") Pass-thru & telescopic Long-duration welding at high amperage Auto-weld skip for partial bore welding Can weld in compact spaces (use BOA-M1 drive) Can weld two bores at once (2 feeders needed)	Standard Capabilities: I.D. Weld range: 20mm-914mm (.8-48") O.D. Weld range: 20mm-914mm (.8-36") Face Welding: 20-610mm (.8-24") diameter Stroke: 318mm (12.5") Long-duration welding High amperage operation Pass-through gun drive with tool-less telescoping feature and full, tool-less reversibility	Standard Capabilities: I.D. Weld range: 20mm-914mm (.8-31") O.D. Weld range: 20mm-305mm (.8-12") Face Welding: 20-610mm (.8-24") diameter Stroke: 318mm (12.5") Long-duration welding High amperage operation Pass-through gun drive with tool-less telescoping feature and full, tool-less reversibility

Standard equipment:	Standard equipment:	Standard equipment:
Welding gun drive 120v/240v AC automatic	Welding gun drive 120v/240v AC automatic	Welding gun drive 120v/240v AC automatic
Long stroke telescopic ball spindle	Long stroke telescopic ball spindle	Long stroke telescopic ball spindle
Standard weld gun assembly	Standard weld gun assembly	Standard weld gun assembly
Heavy duty conduit with remote weld switch	Heavy duty conduit with remote weld switch	Standard conduit with remote weld switch
Standard gun extension tube assembly	Standard gun extension tube assembly	Standard gun extension tube assembly
Micro weld gun assembly	Micro weld gun assembly	Micro weld gun assembly
Weld gun extensions, 152 & 254mm (6 & 10")	Weld gun extensions, 152 & 254mm (6 & 10")	Weld gun extensions, 152 & 254mm (6 & 10")
Bore welder support tube	Bore welder support tube	Bore welder support tube
Radial support arm	Radial support arm	Radial support arm
Necessary tools	Necessary tools	Necessary tools
Deluxe consumables kit	Deluxe consumables kit	Standard consumables kit
Diamond plate carry case	Diamond plate carry case	Diamond plate carry case
Users and setup manual	Users and setup manual	Users and setup manual
Outside diameter welding gun	Outside diameter welding gun	Outside diameter welding gun
Adjustable "T" base and tack plate kit	Adjustable "T" base and tack plate kit	Adjustable "T" base and tack plate kit
Large diameter welding gun	Large diameter welding gun	Large diameter welding gun
Large diameter welding gun extenders (2)	Large diameter welding gun extenders (2)	Large diameter welding gun extenders (2)
Radial extenders for large diameter reach (3)	Radial extenders for large diameter reach (2)	Radial extenders for large diameter reach (2)
Face welding gun kit	Face welding gun kit	Face welding gun kit
Handheld welding gun with quick connect	Handheld welding gun with quick connect	Handheld welding gun with quick connect
Beam gun kit for large ID and OD welding	Beam gun kit for large ID and OD welding	
Low-speed kit for precision control in large bores	Low-speed kit for precision control in large bores	
BOA-M1 compact bore welder		
Hex BOA-M1 borewelder support kit		
Compact gun extension tube assembly		
Standard conduit assembly		
Short telescopic ball spindle		
Stub weld gun assembly		
Auto-Skip feature installed for partial bore weld		
Order #K01.50	Order #K01.40	Order #K01.30

NOTE:
 All BOA-408i bore welder systems feature the pass-through drive system design. This enables simple bore-to-bore transitions by simply telescoping or retracting the bore welder gun extension assembly. The BOA-408i may also be mounted between a set of bores, and can weld on either end of the bore welder. This is a very handy feature for working on bores such as those found on the front of a pay loader because by center mounting the BOA-408i drive, only one setup is required to weld both left and right side bores. Diameter adjustment is a snap with the BOA torch pivot mechanism, also included with all BOA-408i bore welder systems.

All BOA-408i bore welder systems may be equipped with the bore welder to boring bar interface for true plug and play simplicity. Once the Bore Repair Systems, Inc. boring bar is set up, the bore welder simply plugs in to the boring bar support.

All BOA-408i bore welder systems feature self-lubricating, maintenance-free, self lubricating spindle bearings, clutched chain drive and simple, durable on-board control eliminating the need for control cables or control box.

Covered under Pat. Nos 6,137,076; 6,448,531; 6,737,608; 6,284,995; 6,486,438



Bore Repair Systems, Inc.
 97 Lower Cemetery Road
 Langdon, NH 03602 USA
 Borerepair.com - 603-835-2409
 Fax: 603-835-2609

Other patents pending

Equipment list 8/2017

BOA-408i S2 Auto BoreWelder	BOA-408i S1 Auto BoreWelder	BOA-M1 BoreWelder
<p><u>Standard Capabilities:</u> I.D. Weld range: 20mm-533mm (.8-21") Stroke: 178mm (7") Standard-duration welding Standard amperage welding Adjustable mounting feature enabling stand-alone operation or use with any boring bar Pass-through gun drive with tool-less telescoping feature and full, tool-less reversibility</p>	<p><u>Standard Capabilities:</u> I.D. Weld range: 20mm-356mm (.8-14") Stroke: 178mm (7") Standard-duration welding Standard amperage operation Stationary mounting (system usually purchased with optional boring bar and boring bar adapter) Pass-through gun drive with tool-less telescoping feature and full, tool-less reversibility</p>	<p><u>Standard Capabilities:</u> I.D. weld range: 32mm-203mm (1.8—8.0") Stroke: 260mm (10.25") Standard-amperage operation Ability to weld in compact spaces Ability to weld from either end or side of gun drive Reach: 965mm (38") (from one end) (1.9m (76") total reach if gun extender is reversed)</p>

[illegible]

NOTE:

All BOA-408i bore welder systems feature the pass-through drive system design. This enables simple bore-to-bore transitions by simply telescoping or retracting the bore welder gun extension assembly. The BOA-408i may also be mounted between a set of bores, and can weld our either end of the bore welder. This is a very handy feature for working on bores such as those found on the front of a pay loader because by center mounting the BOA-408i drive, only one setup is required to weld both left and right side bores. Diameter adjustment is a snap with the BOA torch pivot mechanism, also included with all BOA-408i bore welder systems.

All BOA-408i bore welder systems may be equipped with the bore welder to boring bar interface for true plug and play simplicity. Once the Bore Repair Systems, Inc. boring bar is set up, the bore welder simply plugs in to the boring bar support.

All BOA-408i bore welder systems feature self-lubricating, maintenance-free , self lubricating spindle bearings, clutched chain drive and simple, durable on-board control eliminating the need for control cables or control box.

Covered under Pat. Nos 6,137,076; 6,448,531; 6,737,608; 6,284,995; 6,486,438



Bore Repair Systems, Inc.
97 Lower Cemetery Road
Langdon, NH 03602 USA
Borerepair.com - 603-835-2409
Fax: 603-835-2609

Other patents pending

Lineboring bar systems

Equipment list 8/2017

AM7 Lineboring bar system	BB6 Lineboring bar system	BB6L Lineboring bar system
Standard Capabilities / Features -I.D. Bore machining range 35-610mm (1.5-24") -Hydraulic powered—120v, 240v or 480v pump -Standard reach 2.4m (96") -Stroke: 280mm (11") (infinitely re-indexable) -Pass-through, mount anywhere drive system -Dual tool ports in boring bars (enables use of optional ID snap gage w/o tool removal) -RPM range allows use of optional snap-ring groove cutter and face machining head -Smooth, simple rotation-based feed ensures smoothest possible finishes in your bores -Fully reversible—use left or right grind bits	Standard Capabilities / Features: -I.D. Bore machining range 35-610mm (1.5-24") -Electric powered—your choice 120 or 240vac* -Standard reach 1.82m (72") -Stroke: 457mm (18") (infinitely re-indexable) -Pass-through, mount anywhere drive system -Dual tool ports in boring bars (enables use of optional ID snap gage w/o tool removal) -Broad RPM range allows use of optional snap-ring groove cutter and face machining head -Smooth, simple adjustable rotation based feed ensures smoothest possible finishes in your bores -Fully reversible—use left or right grind bits	Standard Capabilities / Features: -I.D. Bore machining range 64-610mm (2.5-24") -Electric powered—your choice 120 or 240vac* -Standard reach 1.82m (72") -Stroke: 457mm (18") (infinitely re-indexable) -Pass-through, mount anywhere drive system -Dual tool ports in boring bars (enables use of optional ID snap gage w/o tool removal) -Broad RPM range allows use of optional snap-ring groove cutter and face machining head -Smooth, simple adjustable rotation based feed ensures smoothest possible finishes in your bores -Fully reversible—use left or right grind bits

Order #K09.16

Order #K09.15

Order #K09.15L

Standard equipment included:	Standard equipment included:	Standard equipment included:
Keyed, modular bar drive	Keyed, modular bar drive	Keyed, modular bar drive
Bar axial feed arm w/wear compensation adjustment feature	Bar axial feed unit w/variable feed & remote mount kit	Bar axial feed unit with variable feed
120v / 240v hydraulic pump unit w/10' hose kit	120v / 240v motor with variable RPM gearbox	120v / 240v motor with variable RPM gearbox
(4) spherical bar supports	(1) compact, adjustable support (spherical)	(1) compact, adjustable support (spherical)
(2) adjustable bar / gearbox supports	(2) full-size, adjustable supports (spherical)	(2) full-size, adjustable supports (spherical)
Centering cone pack with compressor sleeve	Centering cone package	Centering cone package
(4) Steel support legs & (8) Securing clamps	Steel support brackets	Steel support brackets
Remote control pendant	Integrated control box mounted on motor	Integrated control box mounted on motor
1/2" pre-sharpened tool bit with facing grind	1.8m (6') long, 57mm (2.25") dia. boring bar	1.8m (6') long, 57mm (2.25") dia. boring bar
Setup and users manual with video CD	1/2" pre-sharpened tool bit with facing grind	1/2" pre-sharpened tool bit with facing grind
Custom carrying/storage case	Setup and users manual	Setup and users manual
3/8" pre-sharpened tool bit with facing grind	Custom aluminum diamond-plate case	Custom aluminum diamond-plate case
Centering cone pack for 32mm (1.25") bar	1.8m (6') long, 32mm (1.25") dia. boring bar	Remote mount kit to allow feed and rotation gearbox to be mounted independently
32mm Reducer kit for bearings & drive	3/8" pre-sharpened tool bit with facing grind	Extended range boring head package
Extended range boring head package	Centering cone pack for 32mm (1.25") bar	(bar comes with aluminum storage box)
(3) 32mm (1.25") diameter bars: 4', 6' and 8' long	32mm Reducer kit for bearings & drive	(bar is chrome plated & straightened)
(3) 50.8mm (2.0") diameter bars: 4', 6' and 8' long	Extended range boring head package	
(2) hydraulic motor kit w/integrated mounting	(bars come with aluminum storage boxes)	
(all bars come with aluminum storage tubes)	(all bars are chrome plated & straightened)	
(all bars are chrome plated & straightened)		
OPTIONAL ACCESSORIES:	OPTIONAL ACCESSORIES:	OPTIONAL ACCESSORIES:
Automatic bore welder & interface kit	Automatic bore welder & interface kit	Automatic bore welder & interface kit
ID snap gage kit	ID bore measure snap gage kit	ID bore measure snap gage kit
Tool bit adjuster package	Tool bit precision adjuster package	Tool bit precision adjuster package
Shorter boring bars (all diameters)	Shorter boring bars (all diameters)	Shorter boring bars (all diameters)
Longer boring bars (all diameters)	Longer boring bars (all diameters)	Longer boring bars (all diameters)
Face machining kit	Face machining kit	Face machining kit
Snap-ring groove machining kit	Snap-ring groove machining kit	Snap-ring groove machining kit
Bar coupling kit	Bar coupling kit	Bar coupling kit
Perimeter-mount bearing and machine sup.	Various bearing supports ie: spider & 2-arm	Perimeter-mount bearing and machine sup.
		Micro-bar kit—allows boring down to 25mm dia.

Covered under Pat. Nos 6,137,076; 6,448,531; 6,737,608; 6,284,995; 6,486,438



Bore Repair Systems, Inc.
 97 Lower Cemetery Road
 Langdon, NH 03602 USA
 Borerepair.com - 603-835-2409
 Fax: 603-835-2609

Lineboring bar systems

Equipment list 8/2017

BOA-C45 Lineboring bar system	BOA-C45-HY Lineboring bar system	BOA-C45L Lineboring bar system
Standard Capabilities / Features -I.D. Bore machining range 24-254mm (1.8-10") -Electric powered—your choice 120 or 240vac -Standard reach 1.82m (72") -Stroke: 280mm (10") (infinitely re-indexable, and longer stroke options available) -Pass-through, mount anywhere drive system -Dual tool ports on 32 & 44mm (1.25 & 1.75") bars (enables use of optional ID snap gage w/o tool removal) -10-270 RPM range allows use of optional snap-ring groove cutter and face machining head -Smooth, simple rotation-based variable feed ensures smoothest possible finishes in your bores -Fully reversible—use left or right grind cutter bits Order #K09.01	Standard Capabilities / Features: -I.D. Bore machining range 24-254mm (1.8-10") -Hydraulic powered—your choice 120 or 240vac pump unit. (comes with 10' hose kit) -Standard reach 1.82m (72") -Stroke: 280mm (10") (infinitely re-indexable, and longer stroke options available) -Pass-through, mount anywhere drive system -Dual tool ports on 32 & 44mm (1.25 & 1.75") bars (enables use of optional ID snap gage w/o tool removal) -5-200 RPM range allows use of optional snap-ring groove cutter and face machining head -Smooth, simple rotation-based variable feed ensures smoothest possible finishes in your bores -Fully reversible—use left or right grind cutter bits Order #K09.01-HY	Standard Capabilities: -I.D. Bore machining range 24-254mm (1.8-10") -Electric powered—your choice 120 or 240vac -Standard reach 1.82m (72") -Stroke: 280mm (10") (infinitely re-indexable, and longer stroke options available) -Pass-through, mount anywhere drive system -Dual tool ports on 32 & 44mm (1.25 & 1.75") bars (enables use of optional ID snap gage w/o tool removal) -10-270 RPM range allows use of optional snap-ring groove cutter and face machining head -Smooth, simple rotation-based variable feed ensures smoothest possible finishes in your bores -Fully reversible—use left or right grind cutter bits Order #K09.10L
Standard equipment included:	Standard equipment included:	Standard equipment:
Keyed, modular bar drive gearbox w/variable feed	Keyed, modular bar drive gearbox w/variable feed	Keyed, modular bar drive gearbox w/variable feed
Axial feed coupler with quick-engage feature	Axial feed coupler with quick-engage feature	Axial feed coupler with quick-engage feature
Morse taper star-drive motor gearbox interface	Morse taper star-drive motor gearbox interface	Morse taper star-drive motor gearbox interface
(2) universal one-arm system supports	(2) universal one-arm system supports	(2) universal one-arm system supports
(2) adjustable bar support bearing inserts	(2) adjustable bar support bearing inserts	(1) adjustable bar support bearing inserts
(1) universal compact triangle support	(1) universal compact triangle support	Centering cone package with compressor sleeve
Centering cone package with compressor sleeve	Centering cone package with compressor sleeve	(2) Steel universal support clamp bars
(2) Steel universal support clamp bars	(2) Steel universal support clamp bars	Integrated control box mounted on motor
Integrated control box mounted on motor	Integrated control box mounted on motor	1.8m (6') 44mm (1.75") dia. chrome bore bar
1.8m (6') 44mm (1.75") dia. chrome bore bar	1.8m (6') 44mm (1.75") dia. chrome bore bar	1/2" pre-sharpened tool bit with facing grind
1/2" pre-sharpened tool bit with facing grind	1/2" pre-sharpened tool bit with facing grind	Standard tack plates for use with universal sup
Large-bore cutter head	Large-bore cutter head	Setup sleeve for universal support
Standard tack plates for use with universal sup	Standard tack plates for use with universal sup	Tool kit: Allen wrench set & 7/16" nut driver
Setup sleeve for universal support	Setup sleeve for universal support	10" feed screw
Tool kit: Allen wrench set & 7/16" nut driver	Tool kit: Allen wrench set & 7/16" nut driver	Metric/Imperial stainless steel scale
10" feed screw	10" feed screw	Manual, setup & owners print & dvd
Metric/Imperial stainless steel scale	Metric/Imperial stainless steel scale	BRS logo baseball cap
Manual, setup & owners print & dvd	Manual, setup & owners print & dvd	3.3hp heavy duty 120v / 240v motor/gearbox
BRS logo baseball cap	BRS logo baseball cap	
3.3hp heavy duty 120v / 240v motor/gearbox	Variable-speed hydraulic power package	OPTIONAL ACCESSORIES:
OPTIONAL ACCESSORIES:	OPTIONAL ACCESSORIES:	Universal compact triangle support
Extra large boring head for 10-14" diameters	Extra large boring head for 10-14" diameters	Large boring head for 6"-10" diameters
Automatic bore welder & interface kit	Automatic bore welder & interface kit	Extra large boring head for 10-14" diameters
ID thru-bar bore measure snap gage kit	ID thru-bar bore measure snap gage kit	Automatic bore welder & interface kit
Tool bit adjuster package	Tool bit adjuster package	ID snap gage kit
Shorter boring bars (all diameters)	Shorter boring bars (all diameters)	Tool bit adjuster package
Longer boring bars (all diameters)	Longer boring bars (all diameters)	Shorter boring bars (all diameters)
Face machining kit	Face machining kit	Longer boring bars (all diameters)
Snap-ring groove machining kit	Snap-ring groove machining kit	Face machining kit
Bar coupling kit	Bar coupling kit	Snap-ring groove machining kit
Small & micro bar kits for bores down to 1" dia	Small & micro bar kits for bores down to 1" dia	Bar coupling kit
Compact & extra long quick-change feed screws	Compact & extra long quick-change feed screws	Perimeter-mount bearing and machine sup.

Covered under Pat. Nos 6,137,076; 6,448,531; 6,737,608; 6,284,995; 6,486,438



Bore Repair Systems, Inc.
 97 Lower Cemetery Road
 Langdon, NH 03602 USA
 Borerepair.com - 603-835-2409
 Fax: 603-835-2609

LineBoring / Bore Welding Packages

Equipment list 8/2017

- Welding / Boring systems below share the same mount for easy one-step setup and boring to welding transitions
- Systems below all feature dual tool / accessory ports on bar. This feature, when used with snap gage and digital tool adjuster gives you the easiest and most accurate means of measuring the bore with the tool bit and bar still in place, and the most accurate way to adjust your tool bit for precise final cuts with .0001" precision.
- Systems below feature the centering cone tightener kit. This unique kit makes the job of centering your bar and keeping the cones tight by yourself a breeze. Kit includes its own spanner wrench.
- All systems below feature the unique pass-through drive design. This design, unlike the old fashioned end-mounted designs of other brands offers users far superior setup versatility. The pass-through design is excellent for bores that are spaced far apart and for parts that have blind bores. These bores are commonly found on construction machinery.
- All packages below may be customized as you need. Packages below may swap the BOA-408i for the BOA-M1 for \$2875. pkg. discount

MODEL	COMBINATION BORE WELDING & MACHINING KIT DESCRIPTIONS	PACKAGE PRICE
BRS2c (Electric drive)	BORING SYSTEM MODEL: BOA-C45 Pass-Thru Drive Electric- FOR BORES 47-254mm (1.8-10") DIA KIT DESCRIPTION: Bar included: (1) Chromed 1 3/4"Ø x 72" long w/ dual tool holes, 115v or 220v, Hi Torque 3.3 hp. Reversing Var. Elec. Drive (15-270 RPM) with reversing feed mechanism, centering cone set w/ tightener kit, 2 spherical bar support bearings, 3 machine supports, aluminum custom case, tool bit, BOA-408i bore welder package w/center support kit. (upgradable drive can run 7/8" and 1.25" dia bars) OPTIONS AVAILABLE: Thru-bar measuring tool, carbide insert tool package, small bar options (for boring down to 1" or 1 3/8" Ø (depends on kit selected) , facing tool, digital tool adjuster kit, snap-ring groove cutter, extended diameter range cutting heads, tapered bars for blind end-drilling/milling operations	(Comes with BOA-408i bore welder and direct mount interface) Order # K05.110901
BRS3c (Electric drive)	BORING SYSTEM MODEL: BOA-C45 Pass-Thru Drive Elec. - FOR BORES 35-254mm (1.4-10") DIA KIT DESCRIPTION: 2 Bar set:: (1ea.) 1 3/4" & 1 1/4"Ø Chrome Bars x 72" long w/ dual tool ports, 115v or 220v, Hi Torque 3.3 hp. Reversing Var. Elec. Drive (15-270 RPM) with reversing feed mechanism, centering cone set w/ tightener kit, 2 spherical bar support bearings, 3 machine supports, aluminum custom case, machine mount, 2 tool bits, BOA-408i bore welder package w/center support kit. . (upgradable drive can run 7/8" dia bar kit for small diameter boring) OPTIONS AVAILABLE: Thru-bar measuring tool, carbide insert tool package, small bar options (for boring down to 15/16" Ø, facing tool, custom length bars & tool ports, digital tool bit adjuster, snap-ring groove cutter, extended diameter range cutting heads, tapered bars for blind end-drilling/milling operations.	(Comes with BOA-408i bore welder and direct mount interface) Order # K05.110902
BRS4c (Electric drive)	BORING SYSTEM MODEL: BOA-C45 Pass-Thru Drive Elec. - FOR BORES 24-254mm (1-10") DIA KIT DESCRIPTION: 3 Bar set:: (1ea.) 1 3/4" & 1 1/4" Ø Chrome Bars x 72" long w/ dual tool ports, (1) 7/8"Ø Chrome Bar x 48", 115v or 220v, Hi Torque 3.3hp. Reversing Var. Elec. Drive (15-270 RPM) with reversing feed mechanism, centering cone set w/ kit, 2 spherical bar support bearings, 2 machine supports, aluminum custom case, adj. machine mount, reducer kits for 1.25" and 7/8" bars, centering cones for all bar sizes w/tightener kit plus 3 tool bits, BOA-408i bore welder package w/center support kit. OPTIONS AVAILABLE: Thru-bar measuring tool, carbide insert tool package, facing tool, digital tool adjustment kit, snap-ring groove cutter, extended diameter range cutting heads, custom length bars & tool ports, morse tapered bars for blind end-drilling/milling operations.	(Comes with BOA-408i bore welder and direct mount interface) Order # K05.110903
BRS5 (Hydraulic drive)	BORING SYSTEM MODEL: BOA-C45HY Pass-Thru Drive Hydraulic- FOR BORES 36-305mm (2"-10") DIAM. KIT DESCRIPTION: Bar included: 1 3/4"Ø x 72" long, 115v or 220v, 2.5hp vari-speed hydraulic drive, centering cones w/tightener kit, 2 spherical bar support bearings, 3 universal machine supports, tool bit, custom storage case, BOA-408i automatic bore welder package w/center support kit. OPTIONS AVAILABLE: Electric drive, small and/or micro bar kits for small boring applications, facing head, ID bore measuring tools, snap-ring groove cutter, custom length bars, digital tool adjustment kit, morse tapered bars for blind end-drilling/milling operations	(Comes with BOA-408i bore welder and direct mount interface) Order # K05.110914-C45
BRS6 (Electric drive)	BORING SYSTEM MODEL: BB 6 Pass-Thru Drive Electric FOR BORES 36-610mm (1.4-24") DIAM. (expandable to over 610mm (24") Diameter capability KIT DESCRIPTION: 2 1/4"Ø Bar x 72" long, 1.25"Ø Bar x 72" long w/dual tool ports , 3.3 hp electric drive option, alignment cones, tooling, tool extensions , 3 adjustable bar/machine supports, tool kit & custom storage case, BOA-408i bore welder package w/bore welder adapter kit. OPTIONS AVAILABLE: Lg. bore kit (up to 24"Ø), facing head, carbide tooling kit, pneumatic drive, 10 hp hydraulic drive, custom length bars, digital tool adjustment gage, ID bore measuring gage kit, snap ring groove cutting kit. (also available without 1.25" dia bar package—call for price)	(Comes with BOA-408i bore welder and direct mount interface) Order # K05.110915
BRS7 (Hydraulic drive)	BORING SYSTEM MODEL: AM 7 Pass-Thru Drive Hydraulic FOR BORES 36-610mm (1.4-24") DIAM. (expandable to 762mm (30") Diameter capability KIT DESCRIPTION: 6 bar package: 2" & 1.25" Ø Bars x 96", 72" & 48" long, 1.5 hp hydraulic drive, (110v/220v pump) alignment cones w/tightener, tooling, 2 spherical bearings & 2 machine supports, cases, BOA-408i bore welder package w/center support kit. OPTIONS AVAILABLE: Lg. bore kit (up to 30"Ø), facing head, carbide tooling kit, custom length bars, digital tool adjuster kit, thru-bar ID measure kit, snap ring cutting tool , 5hp hydraulic drive upgrade	(Comes with BOA-408i bore welder and direct mount interface) Order # K05.110916

Covered under Pat. Nos 6,137,076; 6,448,531; 6,737,608; 6,284,995; 6,486,438





Bore Repair Systems, Inc.
97 Lower Cemetery Road
Langdon, NH 03602 USA
www.borerepair.com - 603-835-2409

*-subject to change. Call for quote

Consumable parts (welding)

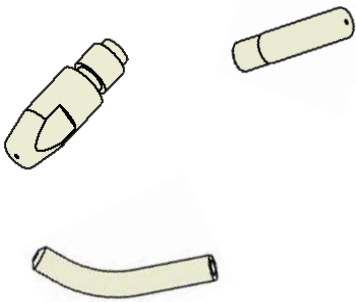
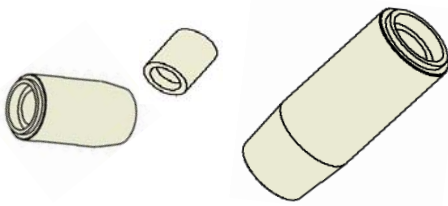
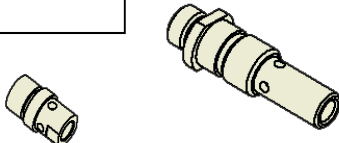
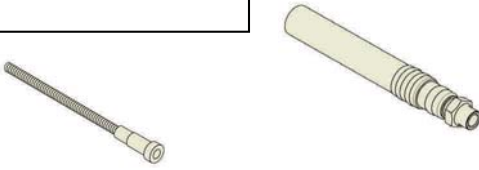
Equipment list 8/2017

Welding Tips		Stub tip, .8mm (.030")	#1058
		Stub tip, .9mm (.035")	#1059
		Stub tip, 1.2mm (.045")	#1060
		Standard tip, .8mm (.030")	#1061
		Standard tip, .9mm (.035")	#1062
		Standard tip, 1.2mm (.045")	#1063
		Hi-amp tip, .9mm (.035")	#2040
		Hi-amp tip, 1.2mm (.045")	#2041
		Hi-amp tip, 1.3mm (.052")	#2042
		Micro-gun tip, .8mm (.030")	#1255
Welding Nozzles		Mini nozzle, insul. ceramic 32-50mm (1.25-2.00")	#1092C
		Mini nozzle, brass 32-50mm (1.25-2.00")	#1092B
		Stub nozzle (use for dia. to 50mm (2.00"))	#1066
		Standard nozzle (use for dia. Over 127mm (5.0"))	#1067
		Hi-amp nozzle (for use on beam & hi-amp gun)	#2067
		Hi-amp stub nozzle (use on beam & hi-amp gun)	#2074
		Micro-gun nozzle body	#1258
		Hand-held gun nozzle	#1308
Welding Diffusers		Mini diffuser	#1093
		Standard diffuser	#1057
		Hi-amp diffuser	#2068
		Hi-amp stub diffuser	#2075
		Hi-amp diffuser to gun adapter, 9-12mm	#1251
		Hi-amp diffuser to gun adapter	#2080
Liner & Conduits		Liner, conduit replacement	#1038
		Liner (1.5m (5') section, trim to fit)	#1039
		Conduit assembly, standard duty QC	#A315
		Conduit assembly, heavy duty QC	#A337
		Conduit assembly, extra heavy duty QC	#A338
Welding wire		Large cast bore welder wire, .8mm (.030")	#1103
		Large cast bore welder wire, .9mm (.035") (superior weld bead tracking with this wire)	#1202



Covered under Pat. Nos 6,137,076; 6,448,531; 6,737,608; 6,284,995; 6,486,438



Bore Repair Systems, Inc.
 97 Lower Cemetery Road
 Langdon, NH 03602 USA
 Borerepair.com - 603-835-2409
 Fax: 603-835-2609

Borewelder parts & acc.

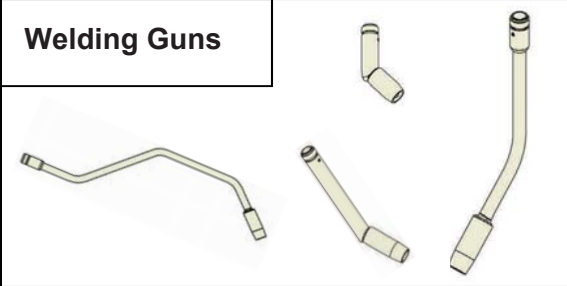
Equipment list 8/2017

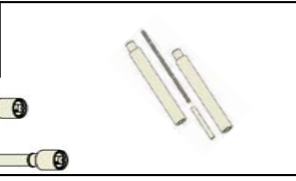
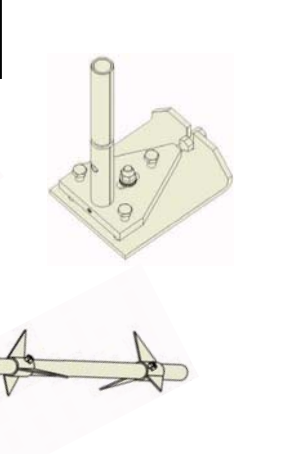
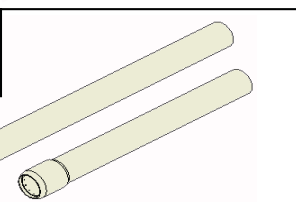
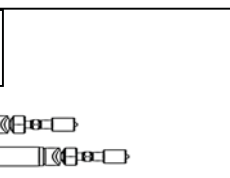
Welding Guns		<p>Gun, short QC #A328</p> <p>Gun, standard QC #A313</p> <p>Gun, micro QC for ID's 20-50mm (.8"-2.0") #A336</p> <p>Gun, large dia. for ID's 200-380mm (8"-15") QC #A310</p> <p>Gun, outside dia. for 25mm-305mm (1"-12") QC #A317</p> <p>Hi-amp gun #A209</p>
Specialty Guns		<p>Extra heavy duty gun, ultra hi-amp #A404</p> <p>Heavy duty gun extender #K23.10</p> <p>Face welding gun kit #K13.10</p> <p>Beam gun kit (adjustable ID and OD welding) #K13.11</p> <p>Hand held gun assembly QC #A333</p>
Gun Extenders		<p>Gun extension assembly 150mm (6") #A309</p> <p>Gun extension assembly 250mm (10") #A335</p> <p>Gun diameter extension kit (125mm (5") x2) #K13.12</p>
Welder Supports		<p>"T" Base with tack plate #K11.11</p> <p>"A" Base with tack plate and tool (compact) #K31.21</p> <p>Universal Hex mount (use with BOA-M1 only) #A329</p> <p>Radial support, BOA-M1 #A308</p> <p>Support tube (BOA-M1) #3099</p> <p>Center support kit (BOA-M1) #K31.11</p> <p>Center support kit (BOA-408i) #K11.21</p> <p>Radial support extension 102mm (4") #A118</p> <p>Radial support extension 204mm (8") #A119</p> <p>Centering tube & cone kit (45-160mm(1.8-6.4")) #K11.12</p>
Drive Spindles		<p>Spindle assembly, 250mm (10") (BOA-M1 only) #A320</p> <p>Spindle assembly, 356mm (14") #A325</p> <p>Spindle assembly, 457mm (18") #A319</p> <p>Spindle assembly, 610mm (24") #A326</p>
Telescoping weld gun Extension Assemblies		<p>Telescoping tube assembly, 305mm (12") #A339</p> <p>Telescoping tube assembly, 483mm (19") #A316</p> <p>Telescoping tube assembly, 610mm (24") #A340</p> <p>Telescoping tube assembly, 915mm (36") #A341</p>

Covered under Pat. Nos 6,137,076; 6,448,531; 6,737,608; 6,284,995; 6,486,438



Bore Repair Systems, Inc.
97 Lower Cemetery Road
Langdon, NH 03602 USA
Borerepair.com - 603-835-2409
Fax: 603-835-2609

Misc. bore repair parts

Equipment list 8/2017

BOA 408i upgrades

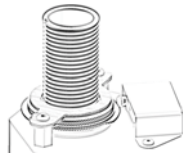
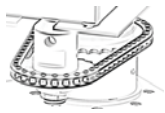

Low-speed gearset kit	#K12.14
Standard-speed gearset kit	#K12.13
Std/Low-speed gearset kit	#K12.12
Auto-skip upgrade	#A129

Boring bar supports, centering, etc.

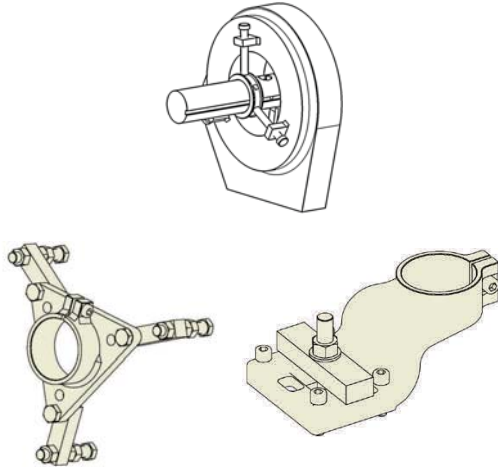

Boring bar base-plate support kit, adjustable	#K94.21
Bearing spherical bearing insert assembly, 1.75"	#A922
Support, universal adjustable one-arm boring bar	#K94.30
Support kit, 2x one-arm w/bearing & joiner bolts	#K94.32
Support, universal compact triangle kit	#K94.51
Boring bar align kit (low-profile) for 1.25" dia bars	#K94.10
Boring bar align kit (low profile) for 1.75" dia bars	#K94.11
Boring bar align kit (low profile) for 1.25 & 1.75"	#K94.12
Boring bar align kit (low profile) for 2.0" dia bars	#K94.13
Boring bar align kit (low profile) for 2.25" dia bars	#K94.14
Alignment spider kit, 6"-10" diameter bores	#K94.15
Alignment spider kit, 10"-14" diameter bores	#K94.16
Tool extender arm, 3" - for 6"-10" dia. boring	#K91.20
Tool extender arm, 5" - for 10" - 14" dia boring	#K91.21

Boring bar related accessories

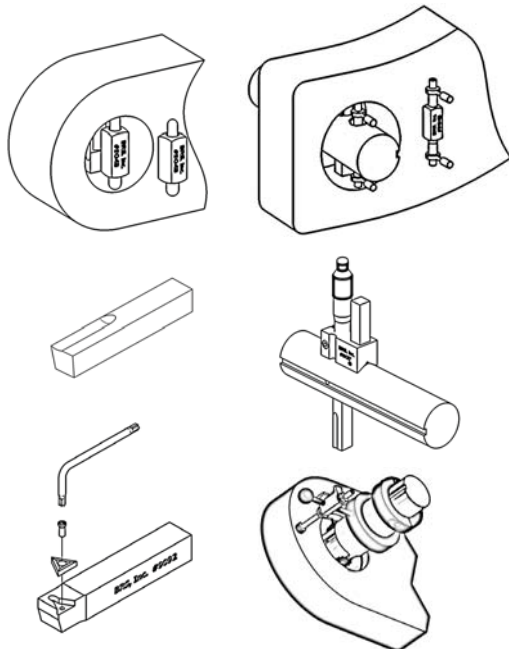

ID bore measure gage, standard model	#K92.10
ID bore measure gage, tight bore model	#K92.20
Multi-function tool bit adjuster kit for 1/2" sq.	#K93.12
Multi-function tool bit adj. kit for 1/2 & 3/8" sq.	#K93.16
Multi-function tool adj. kit for 1/2, 3/8 and 1/4" sq.	#K93.17
Tool adjuster body, for 1/4" sq. bits	#A903
Tool adjuster body, for 3/8" sq. bits	#A904
Multi-function tool bit adjuster kit for 10mm sq. bit	#K93.13
Multi-function tool bit adjuster kit for 12mm sq. bit	#K93.14
Multi-function tool bit adj. kit for 1/2 & 3/8" sq. digital	#K93.26
Cutting bit, HSS w/5% cobalt, pre-sharp 1/4" sq.	#9085
Cutting bit, HSS w/5% cobalt, pre-sharp 3/8" sq.	#9088
Cutting bit, HSS w/5% cobalt, pre-sharp 1/2" sq.	#9087
Cutting bit kit, carbide 3/8" square low-profile	#K91.10
Cutting bit kit, carbide 1/2" square low-profile	#K91.11
Bit, rep'l. carbide insert	#9130
Groove cutting kit for 1.75" dia bars, ex model	#K96.16
Groove cutting kit for 2.0" dia bars, ex model	#K96.17
Groove cutting kit for 2.25" dia bars, ex model	#K96.18

Note: Also available for your boring bar system are various length bars, face machining kits, two-arm mounting kits, morse-tapered bars (allowing end-of-bar drilling operations) and more. Call us for any of your special applications.



BOA-550HD borewelder	BOA-L34 linear welder	BOA-SIZER bore finisher
<p><u>Specifications:</u></p> <ul style="list-style-type: none"> -Stroke: 410mm (16") -Reach: 1780mm (70") -Min. diameter HD Std.: 89mm (3.5") -Min. diameter HD Opt.: 63mm (2.5") -Max. diameter Std.: 762mm (30") -Max. diameter Opt.: 1830mm (72") -AutoSkip: Standard -Weld Modes: ID, OD and Faces -Max. Step: 6.4mm (.25") -Max. Amperage Std.: 225 -Max. Amperage Opt.: 300 -QC Conduit System -QC Gun System -Variable Mechanical Feed -BOA-408i Compatible -Input Volts: 115/240v AC <p>Order #K02.10</p>	<p><u>Specifications:</u></p> <ul style="list-style-type: none"> -Max Extension: 250cm (100") -Stroke: 860mm (34") -Min. Step: 2.5mm (.1:) -Max. Step: 6.4mm (.25") -Feed: Mechanical -Min. Diameter: 25mm (1") -Max. Diameter: No Limit -Max. Amperage: 300 -QC Conduit System -QC Gun System -BOA-408i Compatible -Input Volts: 115/240v AC <p>Order #K04.10</p>	<p><u>Specifications:</u></p> <ul style="list-style-type: none"> -Min. Diameter: 44mm (1.75") -Max Diameter: 260mm (10.25") -Stroke Stops: Quick Set -Attaches to: Boring Bar or Stand Alone base -Stones: Roughing and Finishing -Driveshafts: 4 lengths -Removal Rate: .025 (.001") /minute -Vertical Operation Weight Assist <p>Order #K07.10</p>

<u>Standard equipment includes:</u>	<u>Standard equipment includes:</u>	<u>Standard equipment:</u>
Adjustable Base	Leveling Base	HD Drive Motor
SS Support Rod	Activation Switch	#6 and #7 Sizer Head
Radial Extension Arms (2)	Heavy Duty Gun	Driveshafts (5)
Conduit Support Tube	Heavy Duty Consumables Kit	Universal Joint Assembly
Heavy Duty Gun	Drive System	Anti-Torque Backbone Assembly
Gun Extenders (2)	Conduit Assembly	In/Out Stop Rod Kit
Tool kit	Aluminum Diamond Plate Case	Carrying Case
Heavy Duty Consumables Kit	User's Manual	Sizing Oil
Aluminum Diamond Plate Case	1 year warranty	User's Manual
User's Manual		1 year warranty
Drive System		
Conduit Assembly		
1 year warranty		
OPTIONAL ACCESSORIES:	OPTIONAL ACCESSORIES:	OPTIONAL ACCESSORIES:
Boring bar system	Part rotation turntable	Automatic boring bar kit
Face welding system	MIG wirefeeder adapter	Automatic bore welder kit
Small diameter HD gun	Custom welding gun	
Extended range / reach components		
MIG wirefeeder adapter		
Beam Gun Kit (for larger ID and OD work)		



L-34 Linear Welder

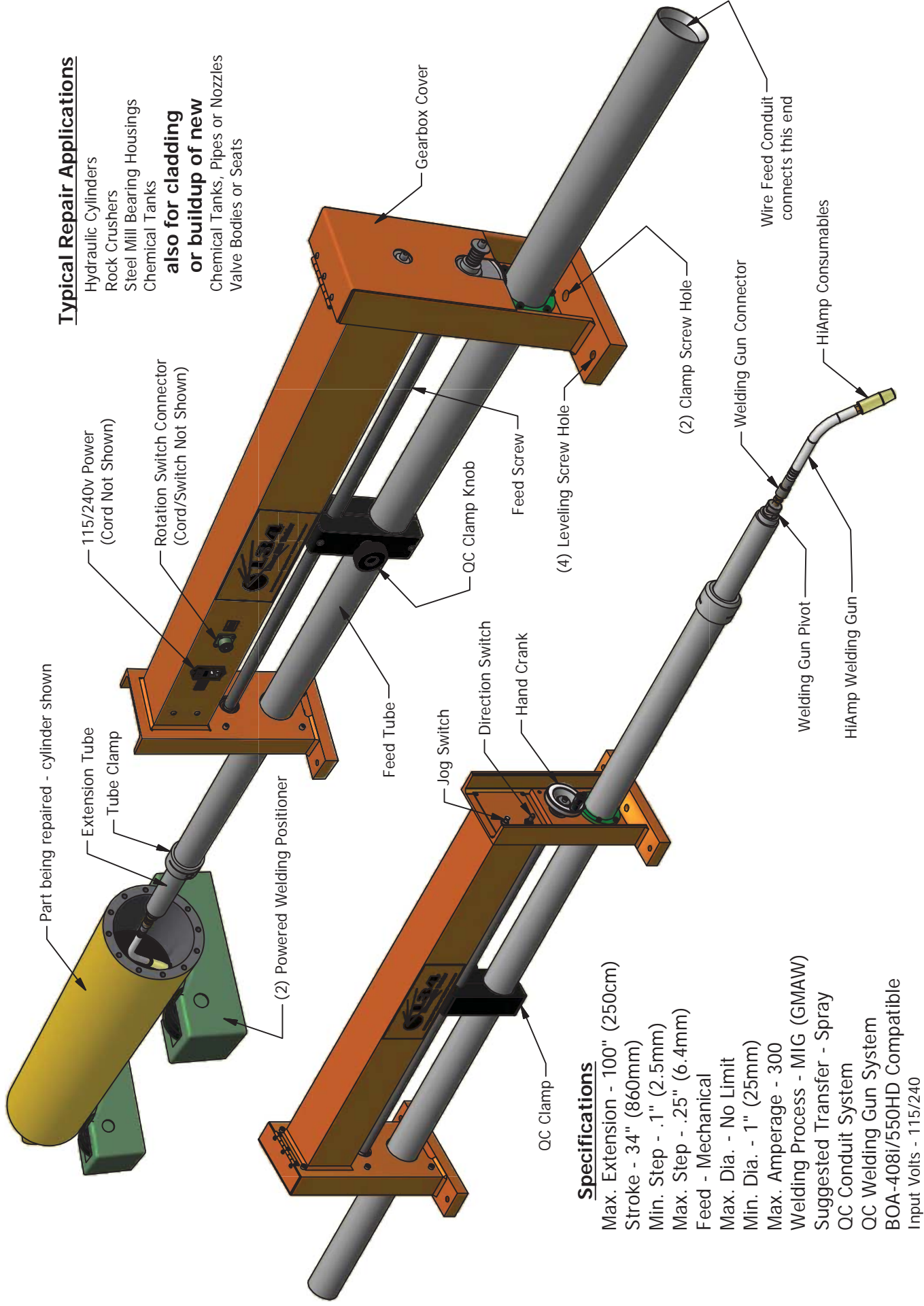

Typical Repair Applications

Hydraulic Cylinders
Rock Crushers
Steel Mill Bearing Housings
Chemical Tanks
**also for cladding
or buildup of new
Chemical Tanks, Pipes or Nozzles
Valve Bodies or Seats**

Specifications

Max. Extension - 100" (250cm)
Stroke - 34" (860mm)
Min. Step - .1" (2.5mm)
Max. Step - .25" (6.4mm)
Feed - Mechanical
Max. Dia. - No Limit
Min. Dia. - 1" (25mm)
Max. Amperage - 300
Welding Process - MIG (GMAW)
Suggested Transfer - Spray
QC Conduit System
QC Welding Gun System
BOA-408i/550HD Compatible
Input Volts - 115/240

BOA-550HD series Automatic Bore Welding System

(popular choice for larger diameter ID and OD welding & cladding jobs)



The BOA-550HD automatic bore welding system is designed for users who demand durability, ease of setup and precision without unnecessary complication.

The patented BOA-550HD bore welder features a unique variable feed mechanical drive system that gives users the option of varying the distance between weld beads. Due to the design features of the feed system, and the fact that it does not require a second motor for axial feed, the machine is very simple to operate and does not require feed recalibrations. This also means that you do not have to worry about bead to bead spacing and possible lack of weld bead fusion to the base metal.

The BOA-550HD is designed to weld at amperages as high as 300, and a feed rate of up to 6.4mm (.25"). This allows vary high weld deposition rates and minimal cycle time. Also, the 410mm (16") stroke allows long duration welds without stopping.

The BOA-550HD is user friendly, simple to operate, extremely durable and is designed to be easily setup and operated.

Weighing just 14Kgs (30 Lbs) the BOA-550HD drive is easily and safely setup and handled by one person. Bores, faces and outside diameters up to 1.8m (72") can be welded with the BOA-550HD

Bore Repair Systems, Inc. offers many convenient purchase plans including rent-to-own and lease finance options. Contact us today at 603-835-2409 or visit our website at www.borerepair.com.

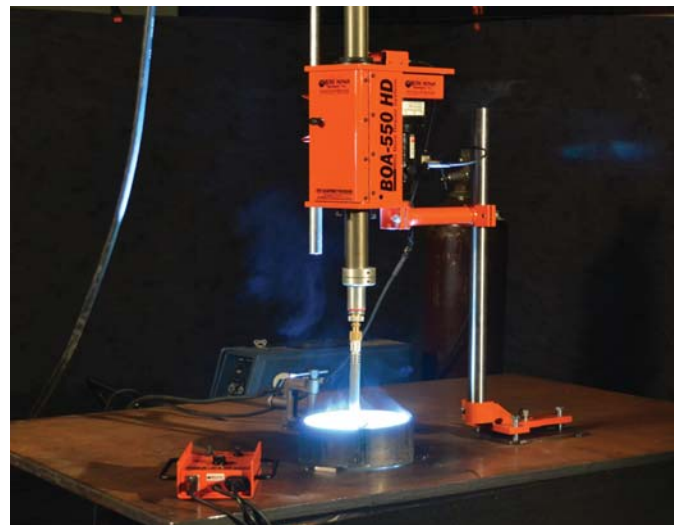

BOA-SIZER

PORTABLE BORE FINISHER

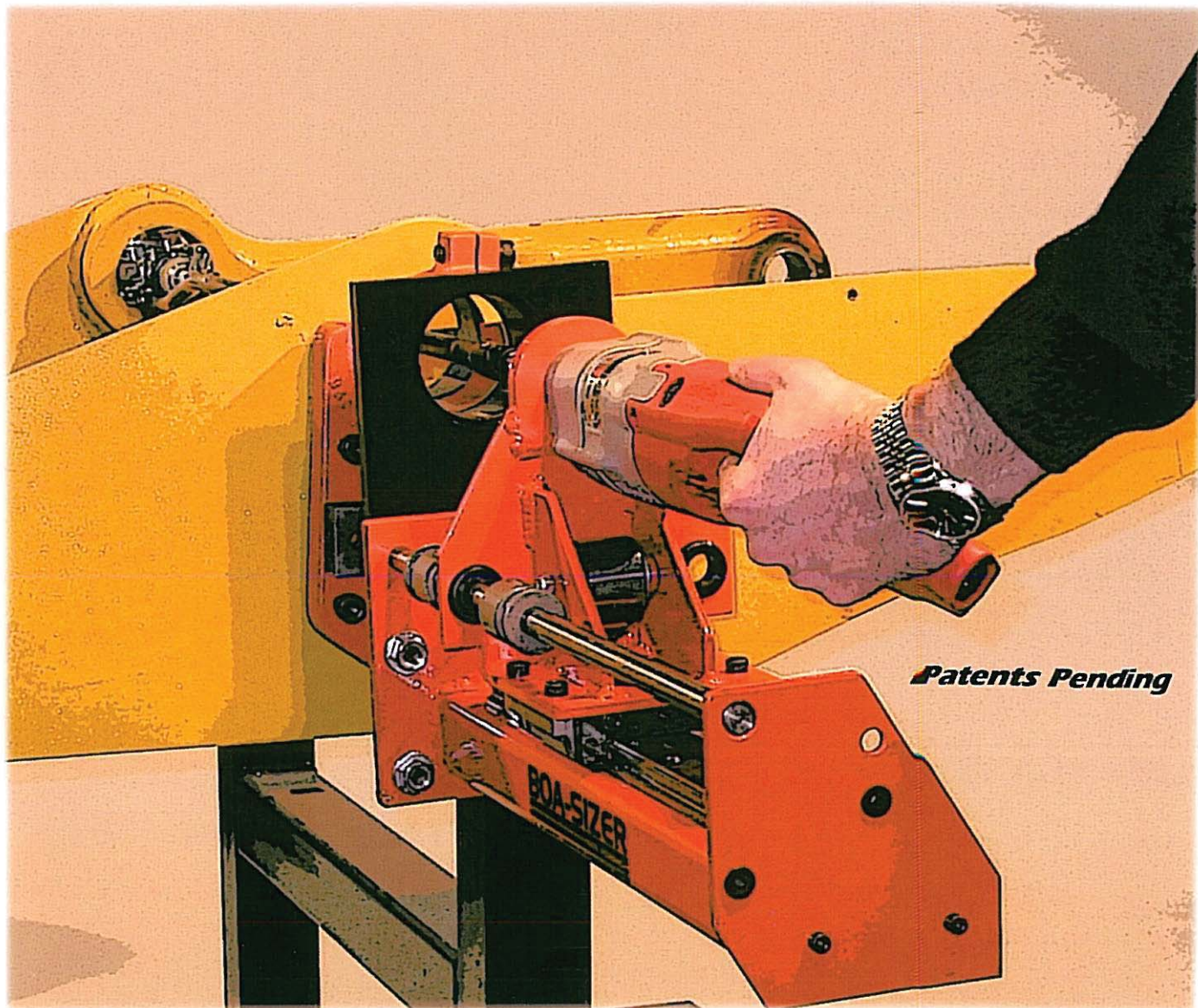

Patents Pending

THE SOLUTION

FOR STRESS-FREE PRECISION BORE FINISHING



Use the *BOA-SIZER* after align boring to reliably achieve a perfect bore diameter and finish...every time.

Innovation • Value • Experience • Support

BOA-SIZER

WHY THE BOA-SIZER WAS DEVELOPED

The BOA-SIZER portable bore sizing Machine, developed by Bore Repair Systems, Inc., solves the age-old problem that anyone involved in equipment bore repairs can relate to....how to reliably machine the bore to the desired precise size, finish and consistency, every time using only a traditional single-point

cutting tool and boring bar. Factors such as boring bar deflection, bar support play, and tool decay make it very difficult to achieve perfect bores on a regular basis using only traditional means. A mistake such as an over-cut often requires starting over, and several additional unplanned hours on the job-not something to look forward to. The solution to the problem is the BOA-SIZER. The BOA-SIZER finishing machine is the best way to achieve perfect bores every time. Bore re-work and the stress of trying to set your single-point boring bar tool accurately for that final cut is history. The BOA-SIZER, with its consistent grinding action means the bore will be finished with accuracy from start to finish. There will be no diameter fluctuations throughout the bore, and the finish will be smooth and free of typical single-point cutter grooves which can impair bushing press fits and proper pin fits.

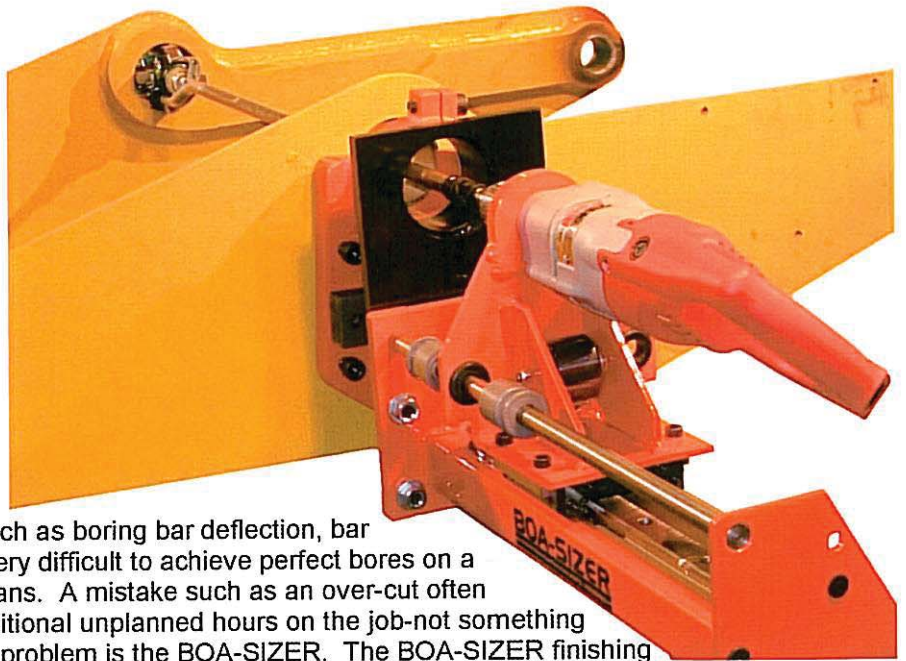

SYSTEM FEATURES

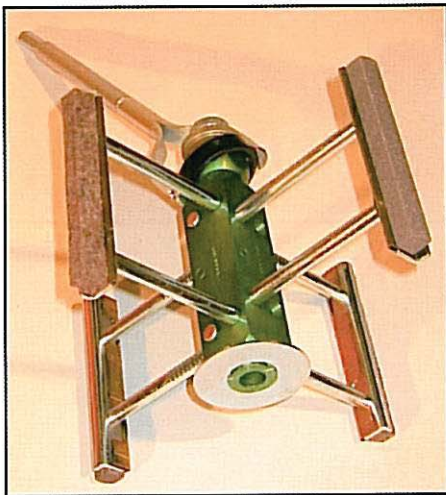

#7 Sizing head with large racks installed for finishing of bores up to 260mm (10.25") in diameter.

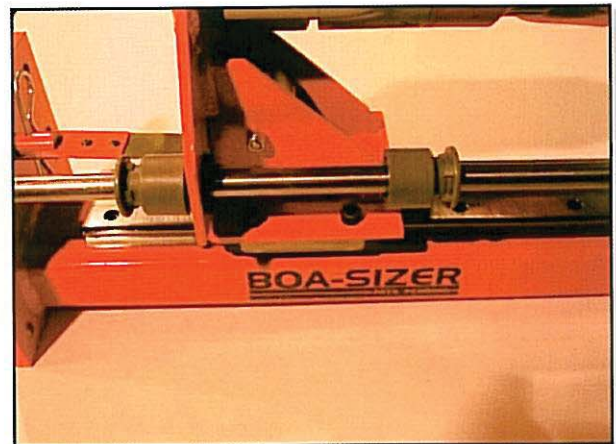

BOA-SIZER stop rod with fully adjustable stops ensure safe operation by eliminating dangerous over-travel of sizing head. The stop system may be installed on either side of the BOA-SIZER for easy left or right handed operation.

Portable Bore Finisher

The final step in the bore repair triangle



**BORE
WELDING**

*We've listened to what you want
and our innovative, reliable
and easy to use BOA line
of portable bore
repair equipment
is the answer.*



BORING

STEP

1

STEP

2



STEP

3

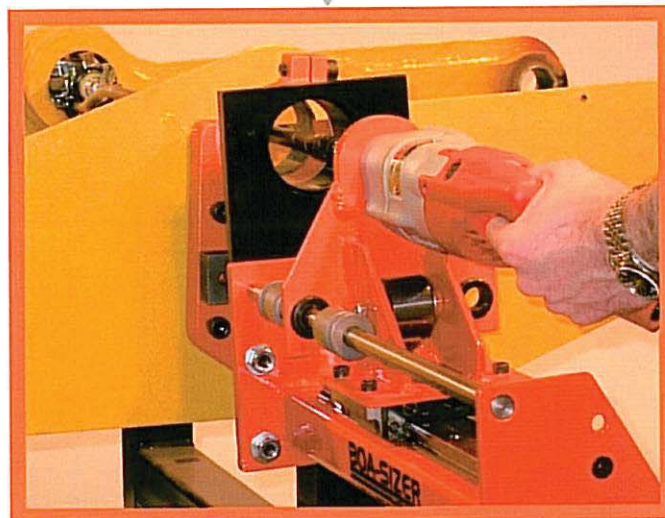

BORE SIZING

The BOA-SIZER completes the bore repair triangle. It is the stress-free way to achieve perfect bores on all your bore repair jobs...every time.

BOA-SIZER

Portable bore finisher



The BOA-SIZER features a unique "weight compensation" feature for easy vertical under or over-head use.

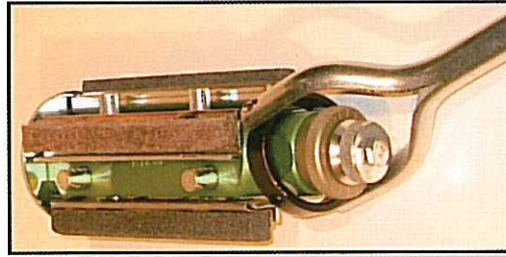

#7 Sizing head with standard rack set installed for finishing of bores from 70mm (2.75") to 95mm (3.75")

Knurled coarse and fine stone pressure adjusters are located at end of sizing head. Universal joint offers easy, self-correcting alignment.

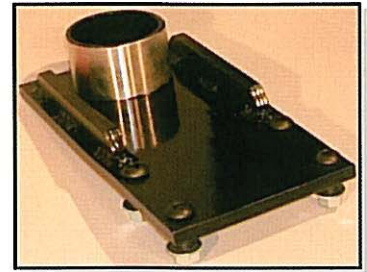

A wide variety of mounting adapters are available. Hook up your BOA-SIZER directly to your boring bar support or use the universal mount anywhere.

BOA-SIZER STANDARD SYSTEM— BORE DIAMETER RANGE: 46-260mm (1.75-10.25")



SYSTEM COMPONENTS

- Traveling assembly
- 110V drive motor
- Quick-lock power cord
- #6 sizing head kit
- #7 sizing head kit
- (1) 76 mm (3") drive shaft
- (1) 152 mm (6") drive shaft
- (1) 305 mm (12") drive shaft
- (2) 610 mm (24") drive shaft
- Large diameter stone extenders
- Universal joint assembly
- Hitch pin
- Boring bar interface bracket
- (2) 1/2" wrenches
- (1) 3/4" wrench
- 8 oz sizing oil
- Carrying case
- User's manual / setup guide